

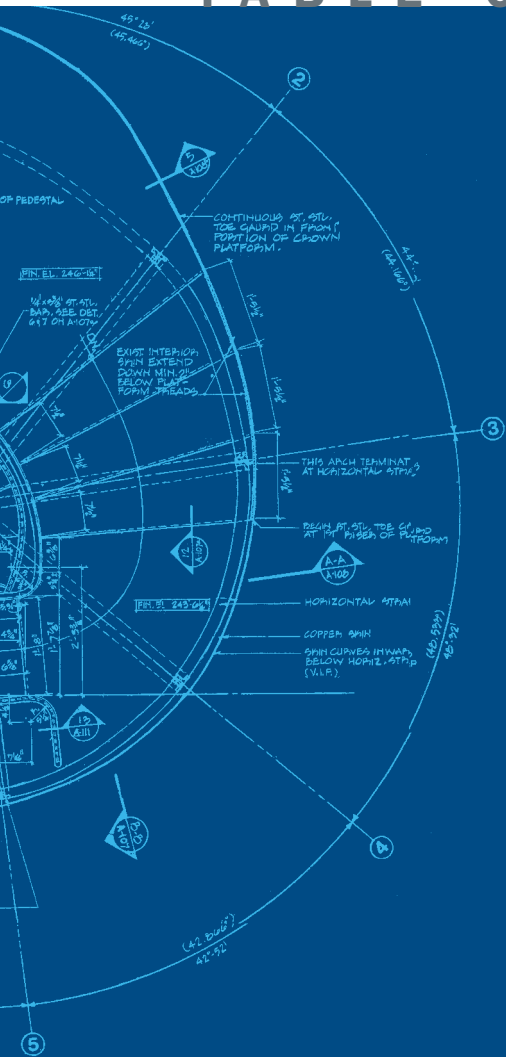

ANNUAL REPORT

2003

TABLE OF CONTENTS



Welcome3
 Chairman’s Message4
 President’s Message.....5

Grantmaking

Giving7
 Selected Grants14
 How to Apply for a Grant17

Gifts to The Trust

How to Give to The Trust18
 Guidelines for Attorneys23

Financial Statements

Statements.....24
 Notes27
 Auditors’ Report29
 Investment Committee31
 Financial Highlights31

Boards and Staff

Governing Body32
 Suburban Divisions34
 Trustee Banks38
 Staff39

Funds and Grants

Funds in 200340
 Grants in 200351



2

An athlete in the Row New York City program pulls to the finish.

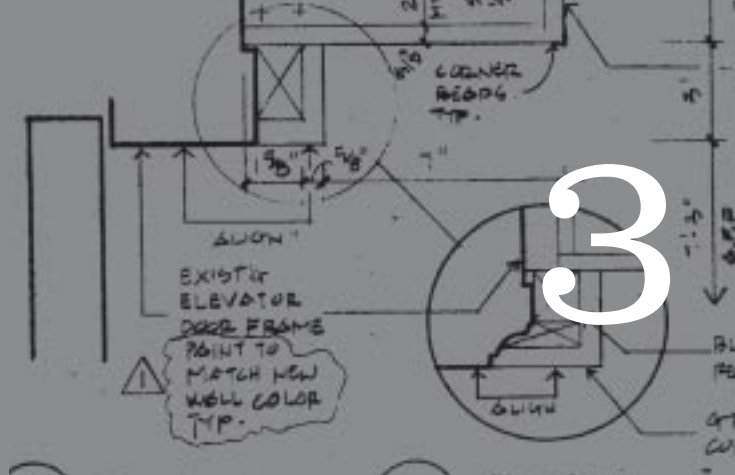

W E L C O M E

For 80 years, The New York Community Trust has invited charitable New Yorkers to join our community of donors who collectively envision a city and a world that are vital, compassionate, and harmonious. They are realistic optimists, fully aware of the challenges, yet hopeful that their contributions will indeed make a difference.

With more than 1,700 charitable funds, each established by an individual, family, or business, The Trust administers assets of \$1.8 billion. We invest the principal and make grants that support an array of programs that benefit our city, including those that meet needs not imagined when the funds were created.

The Trust distributed \$118 million in grants in 2003. Each of those grants was investigated by Trust staff and approved by our Distribution Committee, a board composed of 12 distinguished New Yorkers appointed by a variety of civic institutions and our 13 respected trustee banks.

Establishing a fund in The Trust is simple and quick, and we offer a range of services. We have the flexibility to accept a wide variety of assets and we offer a number of vehicles for accomplishing a donor's financial and estate planning objectives. We take care of all government reporting, grant investigations and paperwork, auditing, and accounting. Because of our size, The Trust

is able to operate with a modest fee structure, preserving charitable money for charitable activities. And, as a public charity, we offer the maximum tax deduction on contributions allowed by law.

Donors can contribute now and through their wills. We offer two kinds of unrestricted funds: One takes full advantage of the services we offer, ensuring that gifts meet the City's most pressing needs now and in the future. The second allows donors to recommend grants during their lifetimes. Donors also can establish field-of-interest funds; whether the purpose is broad or narrow, the organizations chosen to benefit will be selected for their ability to carry out effective programs. Or, donors can set up field-of-interest funds that they advise.

Donors can also set up funds to benefit a specific charity or charities, with the knowledge that should circumstances change so that it becomes unnecessary, undesirable, impractical, or impossible to continue making grants, our Distribution Committee will make sure that the gift is still used for important charitable purposes.

The Trust's founders left us the model for an institution that harnesses the fuel of hope, money, creativity, and commitment to educate our children, revitalize our neighborhoods, put people to work, nourish the arts, and nurture the fragile bonds of community. In a world made fearful and uncertain by terrorism, and in a city that has experienced its deadly results, some might expect to find much cynicism and despair. Our donors and, through their generosity, the nonprofits we support, are the visible evidence that New York is unbowed.



CHAIRMAN'S MESSAGE

The beginning of 2003 looked none too promising. Our City had very serious fiscal problems, which were in many ways shared by the whole country. Cutbacks and taxes were in the headlines every day. Charities were suffering from shrinking endowments and diminishing contributions, while receiving increasing requests for services, and individuals had lower incomes or, all too often, had lost their jobs.

Where did The Trust fit into this picture? Thanks to good management, the generosity of our donors, and the success of our Investment Committee under the leadership of Distribution Committee member Lulu Wang, The Trust did not suffer financially as much as some institutions. It could not—it never could—right every wrong, respond to every need, but, in a challenging year, it accomplished wonders, relying on its special strengths.

What are these strengths?

First, our unceasing research concerning charities and our ability to network keep us constantly “in training.” We can sprint. We can run marathons. In good times and bad, we are able to respond to emergencies and we also are able to address long-term problems.

Second, we are practical. We know that much can be done to help people in difficult situations, improve health and education, keep the arts flourishing, and preserve the environment, and we know how to initiate and implement programs in all these fields. Our staff is acutely aware of the problems of the City. It cares about those in need, understands the implications of laws and policies, and knows how to form successful partnerships. Our donors can turn to us for good guidance, and those who have created endowed funds can feel sure that we are working effectively to address critical needs.

Finally, we are optimistic. We hope and believe that solutions can be found, that progress can be made. We are a positive force.

It is always a challenge to be a New Yorker. But the stress is matched to some extent by the satisfaction of being able to help our City and our neighbors. The donors, the Distribution Committee, and the staff of The Trust are a remarkable band of public-spirited individuals who are, day by day, program by program, improving the quality of life in New York.

Anne P. Sidamon-Eristoff



P R E S I D E N T ' S M E S S A G E

5

This annual report is about blueprints—for structures, strategies, and success. The blueprint on our cover—permission to reproduce was graciously given to us by Richard S. Hayden, the chief restoration architect who drew it when his firm, Swanke Hayden Connell Architects, was involved in the 1986 restoration of the Statue of Liberty—appealed to us for several reasons, apart from its beauty. It offered us a fresh look at a beloved icon familiar to the world, yet one seen so often it has become a cliché. It reminded us that the Statue, although a symbol of freedom and a gift to our country, stands in New York Harbor and is uniquely identified with our city. And it showed the plan underlying the structure.

Our plan, originally conceived by a banker in 1914, had as its genesis two problems. The first was the “Dead Hand,” those conditions placed on many charitable bequests that, over time, became impossible or unnecessary to fulfill. The second was leaving to bankers, in whose hands these charitable trusts were placed, the task of deciding how to carry out the philanthropic wishes of the donors. The result was the community foundation, a public charity

overseen by an independent group of community leaders, that would make grants from these funds to effective nonprofits in their region and have the authority to vary the purpose of a fund should circumstances change.

There now are some 700 community foundations, and in the century since the first was founded, their structures have changed. Many are now corporations, responsible for investing charitable assets as well as distributing them. Some, such as The New York Community Trust, are in both trust and corporate form. In addition to managing charitable funds left by will, they also offer a variety of other options, including donor-advised funds and funds that benefit a particular area of charitable interest. They have become an essential part of individuals’ financial and estate planning, and continue to give donors the assurance that their generosity will always be used to help future generations.

Over the years, community foundations have developed a sophisticated understanding of their regions and become adept at making grants to local nonprofits that can effectively and efficiently tackle problems and contribute to the vitality, health, and stability of their communities. Each of us has adapted the original blueprint so that we can respond to changing times and changing issues. In the following pages, you will learn how one community foundation has used this flexible model to make our city a better place in which to live and keep faith with our donors.

Lorie A. Slutsky



The Campaign for Fiscal Equity's landmark legal victory mandates the resources needed for a sound basic education for these public school kids.

GIVING

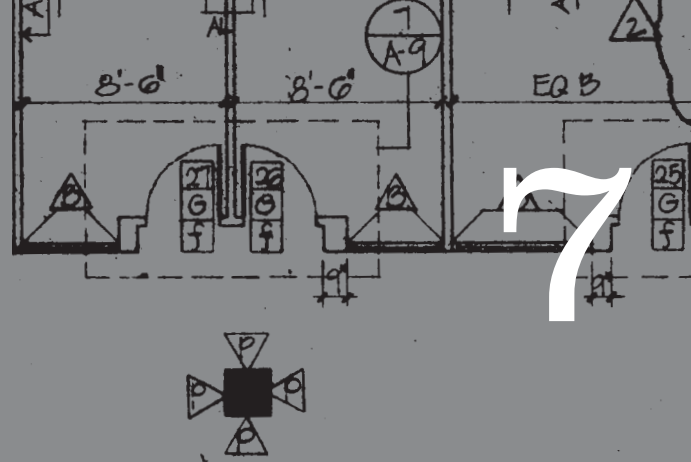

ALL FINE ARCHITECTURAL VALUES ARE HUMAN VALUES, ELSE NOT VALUABLE.

Frank Lloyd Wright (1869–1959), U.S. architect. *The Living City*, pt. 3, “Recapitulation” (1958).

Like an architect commissioned to design a skyscraper, the founders of The New York Community Trust envisioned a structure that would soar, one that would reflect the magnificence of the city and the dreams of its people. In 1922, two years before The Trust opened its doors, *Trust Companies Magazine* explained the objectives of community foundations: they must “be vital, basic and far-reaching. To be a vital ... disburser of alms to current charities, while good in itself, is not enough The poor we may have always with us, but not necessarily the poor in spirit, and we must see to it that our charitable acts do more than merely take care of the results of current [problems], and that they do not tend to create the very conditions which they seek to correct.”

The blueprints that were drawn for The Trust—and the values on which they were based—have well served our community of donors and New York City nonprofits

for 80 years. But community foundations were also created to respond to the restrictions on charitable bequests that, over time, made them impossible or unnecessary to carry out. The Trust’s first director described that concept in 1924, writing that it “assures the use of the accumulated funds of tomorrow to serve the requirements of that day rather than the perhaps obsolete needs of this day; a conception that adds to the foresight of prophets the hindsight of engineers.”

And so, we have been engineers, our job made easy by the flexible plans we’ve inherited. As The Trust has grown, we have modified the original structure to accommodate our increasingly complex operations. With more donors, and more funds—particularly those set up through wills—giving us broad discretion for distribution, we developed program areas that would help us make coordinated grants to a variety of nonprofits, allowing us to test different solutions to a single problem or a set of inter-related problems.

Within each of these program areas—Children, Youth, and Families; Community Development and the Environment; Education, Arts, and the Humanities; and Health and People with Special Needs—our grants meet one of five purposes: plan or develop new programs; improve services for people; improve agencies’ ability to do their work; make broad systems change through research, policy work, or advocacy; and strengthen neighborhoods. In this annual report, we look at how our grants in 2003 used our blueprints to help respond to today’s problems.

The Brooklyn Bridge Park Coalition organizes events and programs, such as fishing, while the waterfront park is being developed.

PLANNING AND DEVELOPING PROGRAMS

Foundations have traditionally funded new programs, on the premise that government would pick up the costs once their value was proven. That assumption has not held in recent years, with responsibility for many programs now devolved to the states minus the federal money. And most recently, the recession and slow recovery have taken their toll on state and city

will use its grant to increase community support by adding interim programs, walking tours of the piers, and hosting a children's performing arts festival. And other great ideas are percolating—a "Brooklyn Beach," an ice-skating rink, and a kayak launch.

The Medical and Health Research Association of New York City (MHRA) does public health research and

grantmaking

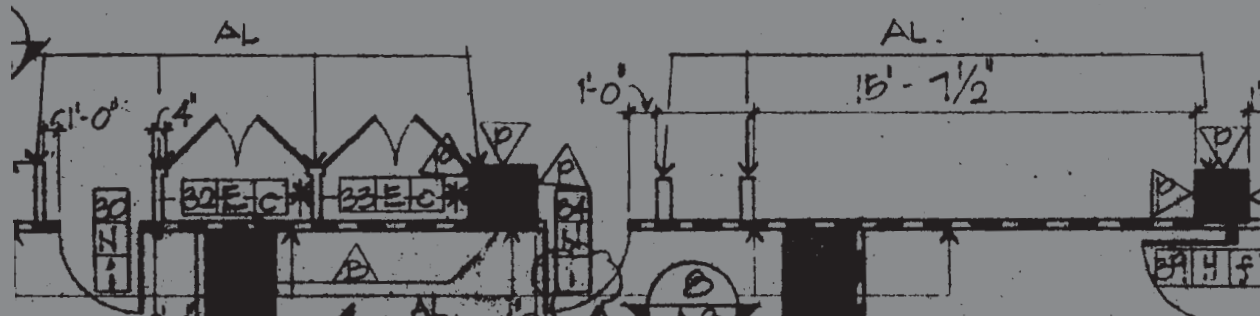

budgets and on the endowments of foundations, leaving many nonprofits scrambling for funds simply to keep their projects going. Nonetheless, The Trust continues to look for opportunities to support new programs that make a difference.

A grant to the Brooklyn Bridge Park Coalition in 2003 is one such example. The Coalition was started 15 years ago to push for a waterfront park in the City's most populous borough—and the one with the fewest parks. The City and State have now committed money to the park, but because a number of issues regarding governance and design are outstanding, the park will not be completed for several years. The Coalition helped begin a public planning process involving more than 1,000 park neighbors, and sponsored a number of events in the park, including a September 11th memorial garden on Pier 4 created by more than 500 volunteers, and a summer film series that drew an audience of 4,000. To make sure that progress continues to be made, the Coalition

offers medical care to improve the health of high-risk and poor New Yorkers. One of its largest programs is a network of eight centers that provide reproductive health services to more than 23,000 women, most of them minorities and immigrants who rely on public insurance or are uninsured. When a recent survey of its patients showed a high incidence of depression and anxiety, MHRA started investigating. Although they already referred women with serious and obvious mental problems to qualified providers, the centers found that most mental health agencies have long waiting lists, often lack multilingual staff, and are at capacity in serving under- or uninsured patients. Patients with less serious, but nonetheless debilitating, problems went undiagnosed and untreated. With our grant, MHRA will begin planning to add mental health services to all its centers, refining screening tests, training clinical staff, developing administrative, financial, and billing systems, and ultimately applying for licensure by the New York State Department of Health.





IMPROVING SERVICES

New York City has, almost since its beginnings, relied on nonprofits to provide a host of services to residents. Health care, programs for senior citizens and kids, open spaces, and affordable housing are but a few examples. Many of these programs are supported with public money, but often, the contracts do not cover all the costs. Nonprofits, as well as City agencies, must then rely on private contributions to make sure they can continue to offer quality services.

Selfhelp Community Services was started in 1936 to help Europeans fleeing from the Nazis find jobs and adjust to life in the United States. Today, the agency is a major provider of services to the elderly and disabled. It serves nearly 20,000 people each year through its home care programs, senior centers, and four housing programs for the elderly. The agency operates SHARP, Selfhelp Alzheimer's Resource Program, at four sites in Queens, offering supervised social activities, meals, and personal care. To improve the care of its clients at home, Selfhelp used our grant to start a care-

giver support group at its Maspeth program, as well as to reach out to additional elders with dementia and educate the community about this devastating disorder.

New Yorkers for Children was created to accept private money for the City's Administration for Children's Services (ACS), the agency responsible for protecting children. We asked ACS to submit a proposal for projects that might improve the City's ability to safeguard children, and where public money was either limited or non-existent, and made grants for three of them. The first will restructure services for adolescents in foster care. Although foster homes are the preferred option for these teens, more than two-thirds are placed in group homes. The agency is recruiting and supporting foster parents and reducing its use of congregate care. The second project focuses on central Harlem, which has the highest number of children in foster care in the City. A Community Support Team is bringing together nonprofits, City agencies, and residents to assess families' needs, make referrals for services, and monitor progress. Finally,



ACS is improving documentation so that it can draw down additional federal money.

STRENGTHENING ORGANIZATIONS

In addition to tight budgets, nonprofits labor under many constraints. Agencies that are involved in policy, advocacy, and direct services are focused on their missions and staff are generally hired for their expertise in a particular program area. Although many have worked to improve administration and financial operations—a necessity in recent years with reduced funding and delays in government contracts—much more needs to be done to streamline management to enhance their stability and improve services.

Legal Services for New York City (LSNY), the largest civil legal program in the country, has a central office and 17 neighborhood offices that help more than 20,000 poor New Yorkers each year. Each office had been running autonomously, with little leadership from the central office. To improve coordination among the programs,

and ensure that each delivers quality services, LSNY began a restructuring process that has resulted in a more centralized organization. The agency has a new executive director, who has created a management team and recruited new board members, but needed help to make sure that he and the team have the skills to lead a drastically restructured agency and handle their increased authority. A Trust grant paid for a consulting firm, which coached the director, organized a team retreat and a workshop on the revamped structure for people in the central and field offices, and put in place a performance measurement system.

The purpose of the nonprofit Primary Care Development Corporation is to help build primary health care centers in poor City neighborhoods. During its 10-year history, the Corporation has used \$100 million in public financing to renovate or construct 31 facilities with the capacity to serve 300,000 people. It has also worked with the centers to improve their operations. With our grant, the

Corporation is offering two programs to twelve additional centers. The first is helping the centers to re-engineer patient flow to reduce waiting time and make more efficient use of clinical staff. The second will help them improve their billing systems to increase revenue and improve cash flow. The ultimate goal is to provide quality health care to residents of poor neighborhoods.

RESEARCH, PLANNING, AND ADVOCACY

A distinguishing feature of The Trust's grantmaking is our commitment to stay with issues over time. The frustration and even anger that we feel when the schools continue to fail our children and too many families are still without permanent homes are offset by two factors. Although some of our grants fail to produce anticipated results, most often someone in need benefits—and that is never a small

grantmaking

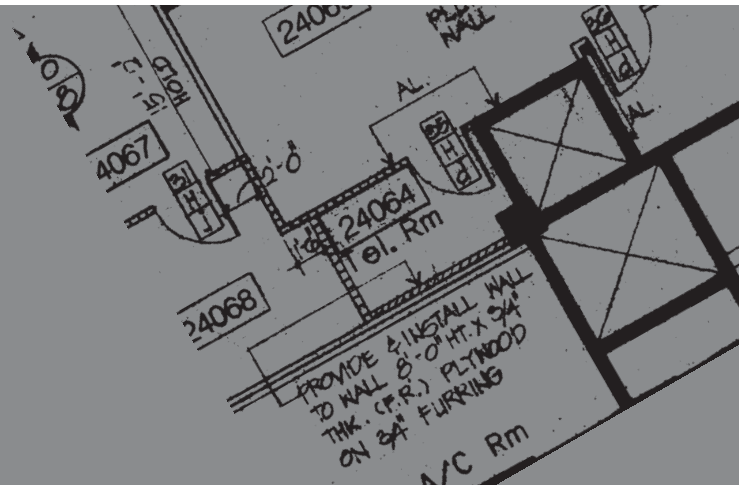

thing. And because there are many effective nonprofits working toward broad, systemic change, we are able to fund projects that can improve the lives of many people.

For more than a decade, we supported the Campaign for Fiscal Equity's (CFE) lawsuit against the State, which sought to reform the financing system that deprives New York City students of the resources needed for a sound, basic education. In June 2003, the Court of Appeals, New York's highest court, issued a landmark ruling in favor of the plaintiffs. Chief Judge Judith Kaye ordered that by July 30, 2004, the State must determine the cost of providing a sound basic education, ensure that every school in the City has the resources to provide that education, and create an accountability system to measure the results. The case was sent back to the trial court for any follow-up that may be necessary. CFE is working to make sure that their legal victory translates into real improvements for children. The Campaign has joined with groups across the State to convene national experts to make a cost determination, and organized a task force to develop a



reformed system for distributing operating and capital funds to school districts and establishing accountability mechanisms. Our grant helps to pay the continuing expenses for the litigation, including presenting these recommendations to the trial court.

Since 1961, the Vera Institute of Justice has been working on solutions to the problems of urban government. Vera was asked by the Department of Homeless Services, the Department of Housing Preservation and Development, and the New York City Housing Authority to help them stem the flood of homeless families, whose numbers have doubled since 1997. Under the direction of the commissioners, and with the help of a Trust grant, Vera is analyzing the agencies' data to identify the conditions and events that drive families to shelters, surveying a sample of families, and looking at promising prevention programs in other states.

While long-term solutions to this complex problem will take time, the research will help the City to predict and monitor homelessness and lead to better prevention programs.

BUILDING COMMUNITY

New York has always been a city of neighborhoods.

Astounding in their variety—of architecture, culture, cuisine, and people—they break down Gotham's size and anonymity. Because of their importance to the City's stability and vigor, strengthening communities has long been a Trust priority.

We have come a long way since the housing crisis of the 70s, when waves of landlords abandoned buildings in poor neighborhoods. Huge efforts by the City, scores of nonprofit housing developers, and thousands of tenants reclaimed many neighborhoods, but a handful still has many City-owned buildings. The New York ACORN Housing Company is working in two adjacent Brooklyn neighborhoods, Brownsville and Bushwick, which have significant numbers of small, abandoned buildings with two or three units, too small to attract private developers. The agency, along with a local contractor, is developing 35 small family houses through the City's Home Works program, which then sells them via lottery to buyers who live in one unit and rent out

Left: Medical & Health Research Association of New York City will add mental health care to its women's clinics to treat the high incidence of depression among poor, young, and immigrant patients; below: Norwood News, an award-winning community newspaper published by Mosholu Preservation Corporation in the Bronx, keeps residents informed about local issues.

the rest. With our grant, ACORN Housing is working to prepare low-income families for homeownership, using special mortgage products, grants, and training in budgeting and maintenance—and turning vacant eyesores into homes.

Media coverage of New York's neighborhoods is generally limited to dramatic and sensational events. Residents are shortchanged when it comes to informed coverage

of schools, community boards, and other civic issues. The Mosholu Preservation Corporation in the Bronx began publishing a monthly newsletter in one of its neighborhoods in 1988. The *Norwood News* now publishes 25 times a year and has a circulation of 13,500 in three northwest Bronx neighborhoods. It has a tradition of exposing problems that have led elected officials and residents to do something about them. These have

13

grantmaking

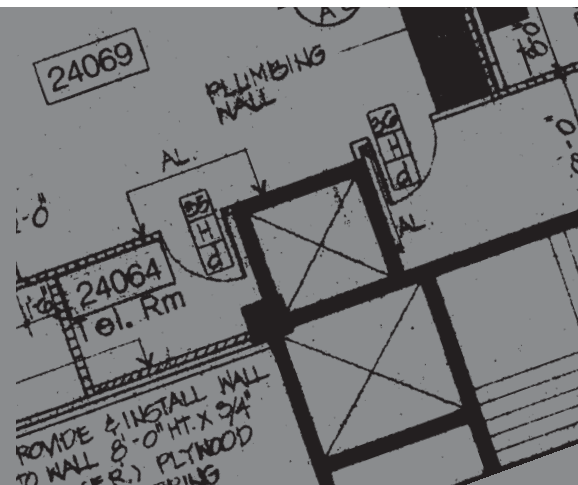

Serving Norwood, Bedford Park, North Fordham and University Heights FREE

NORWOOD NEWS

Vol. 16, No. 22 • Published by Mosholu Preservation Corporation • Nov 9 - Nov 15, 2003



Doctors, Lawyers and ... You Name It
 Kids in all 22 houses of 275 2nd Avenue through Norwood are helping out by showing off costumes in a building fire, which last year left 100 families homeless.

A Close-Knit Community Mourns Murdered Teen

A MURDER MORN
 The close-knit, tight-knit Norwood community mourns the death of a young man, 17, who was shot and killed last week. The victim, a young man, was a member of the local community and was well-known to many of the residents. The community is holding a memorial service for him on Saturday, Nov. 15, at the local church. The service will be held at 7:00 p.m. and will feature a eulogy by the pastor and a performance by the local band. The community is also holding a vigil for him on Sunday, Nov. 16, at 10:00 a.m. at the local church. The vigil will be held in front of the church and will feature a prayer service and a performance by the local band. The community is also holding a memorial service for him on Saturday, Nov. 15, at the local church. The service will be held at 7:00 p.m. and will feature a eulogy by the pastor and a performance by the local band. The community is also holding a vigil for him on Sunday, Nov. 16, at 10:00 a.m. at the local church. The vigil will be held in front of the church and will feature a prayer service and a performance by the local band.



Ronald Singh

News Scores 5 Press Awards

The Norwood News scored five press awards (known as "Spikes") at the Independent Press Association's (IPA) 2003 awards ceremony on Oct. 23. The paper won five awards for its coverage of local issues and its reporting on the community. The awards were presented to the paper's staff members at a ceremony held at the local community center. The awards were presented to the paper's staff members at a ceremony held at the local community center. The awards were presented to the paper's staff members at a ceremony held at the local community center. The awards were presented to the paper's staff members at a ceremony held at the local community center.



Norwood News reporter Heather Wallin accepts award from IPA chair Lucia Wang.

included getting a court-appointed administrator to manage a building whose landlord had been accused of serious code violations, and the assignment of a senior staff person by the Human Resources Administration to help the 19,000 eligible residents not receiving food stamps to enroll in the program. With our grant, *Norwood News* will continue to keep its readers informed and engaged in their community.

A BLUEPRINT FOR THE FUTURE

Most of us have learned to take forecasting—be it of the weather, the economy, or the World Series prospects of the Yankees—with large doses of salt. Our world has become too complex, too interdependent, too fast moving, and too uncertain to predict what will happen in the next week, much less over the years. But with our endowment, the help of current and future donors, and a structure that has proven its adaptability, The New York Community Trust expects to be there, contributing its human and financial resources to the needs of the day.

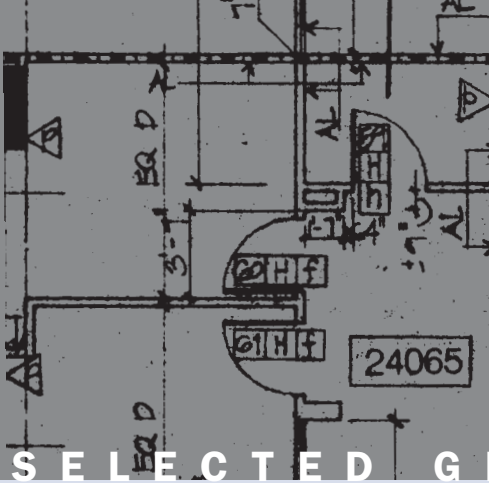

SELECTED GRANTS

For descriptions of all The Trust's discretionary grantmaking during the year, we encourage you to request copies of our six newsletters in 2003.

CHILDREN, YOUTH, AND FAMILIES

Girls & Young Women:

New York Academy of Medicine: *For a program that encourages girls in middle school to develop an interest in science and medicine.*

Row New York: *For a rowing program for girls in Queens to help them exercise, learn teamwork, and develop a sense of accomplishment.*

Hunger & Homelessness:

Common Ground Community Housing Development Fund Corporation: *To coordinate 30 agencies to provide housing and services for homeless people in Midtown Manhattan.*

SHARE New York: *To expand a cooperative food distribution program for low- and moderate-income families.*

Social Services & Welfare:

Permanent Judicial Commission on Justice for Children and Court Appointed Special Advocates: *To help the family courts assess and provide services to babies in foster care.*

New Yorkers for Children: *To prepare youth in foster care for college exams and to provide college scholarships.*

Substance Abuse:

Fortune Society: *To integrate mental health and drug abuse services for ex-offenders.*

Graham-Windham Services to Families and Children: *To start a substance abuse assessment and referral program for central Harlem parents with children in foster care.*

Youth Development:

Futures and Options: *For an internship program that prepares public high school students for business careers.*

New York Hall of Science: *To attract disadvantaged high school seniors and college students to careers in science through an internship program.*

COMMUNITY DEVELOPMENT AND THE ENVIRONMENT

Civic Affairs:

Citizens Budget Commission: *For a conference on reforming New York State's complex fiscal policies and practices.*

Good Jobs First: *To increase New York City government accountability for corporate subsidies.*

Community Development:

Architecture Research Institute: *To promote a plan for revitalizing the retail sector of Lower Manhattan in the wake of September 11th.*

Neighborhood Economic Development Advocacy Project: *To train community organizations to help seniors victimized by predatory lending.*

Workforce Development:

William J. Brennan, Jr. Center for Justice: *To improve the quality of jobs and workforce skills for disadvantaged workers in construction and other industries.*

New York City Employment and Training Coalition: *To start a workforce development training institute for New York City employment organizations.*

Technical Assistance:

Community Resource Exchange: *To help community-based immigrant organizations build resources.*

United Neighborhood Houses of New York: *To strengthen the management of settlement houses.*

Conservation & the Environment:

New York:

Neighbors Against Garbage: *For an economic and environmental analysis of businesses in Brooklyn waterfront communities to demonstrate the benefits of preserving mixed-used neighborhoods.*

Rockaway Development and Revitalization Corporation: *To design specifications for environmentally sound building methods for single-family housing.*

National & International:

Ecology Center: *To lead a national campaign to phase out the production and use of toxic compounds in the automobile manufacturing industry.*

Keep Antibiotics Working: The Campaign to End Antibiotic Overuse: *To advocate for reduced use of antibiotics in animal feed.*



Beginning top left and going clockwise:

Students learn how to stay fit for life through a program of the Fund for Public Schools; A dance performance at P.S. 156 in Brooklyn is a result of one of the many partnerships brokered by the Center for Arts Education between public schools and cultural organizations; Doctors of the World—U.S.A. provides health care for victims of torture and domestic violence; Columbia University's Mailman School of Public Health studies the effects of environmental toxins on children who live in northern Manhattan; Greater Jamaica Development Corporation is creating an exhibition on local jazz history at the Queens AirTrain terminal; The Door—A Center for Alternatives offers civil legal services to immigrant youth in foster care and at-risk teens.



EDUCATION, ARTS, AND THE HUMANITIES

Arts & Culture:

Alliance of Resident Theatres/New York: *To help small theater companies that showcase the City's immigrant culture develop administrative and organizational skills.*

Center for Arts Education: *To support 31 partnerships between public schools and cultural organizations.*

Education:

Fund for Public Schools: *To implement a fitness education program in the public schools.*

Learning Leaders: *To increase the involvement of immigrant parents in public schools.*

Historic Preservation:

Greater Jamaica Development Corporation: *To develop an exhibit at the Queens AirTrain terminal highlighting local jazz history.*

New York Landmarks Conservancy: *To restore a historic parish hall that serves as a vital community center in Queens.*

Human Justice:

LawHelp/NY: *To expand an on-line directory of free legal services in New York City.*

The Door—A Center of Alternatives: *To provide legal assistance to immigrant youth in foster care.*

HEALTH AND PEOPLE WITH SPECIAL NEEDS

AIDS:

Federation of Protestant Welfare Agencies: *For an advertising campaign to encourage people to be tested for HIV infection.*

Gay Men's Health Crisis: *To develop an HIV-prevention and treatment program for young gay men.*

Biomedical Research:

Cancer Research Institute: *For early stage clinical trials of cancer vaccines.*

Columbia University Mailman School of Public Health: *To study environmental toxins in children.*

Blindness & Visual Disabilities:

Archdiocesan Catholic Guild for the Blind: *To expand a program to teach English to immigrants with visual disabilities.*

Jewish Guild for the Blind: *To increase enrollment in a special needs managed care plan for elderly people with visual disabilities.*

Children & Youth with Disabilities:

Children of Bellevue: *To teach poor parents using the pediatric clinic how to encourage their children's development.*

Vincent J. Fontana Center for Child Protection: *To train clinicians on the special needs of victims of child abuse, neglect, and other traumas.*

Elderly:

New York University Downtown Hospital: *To improve the care of hospitalized elders.*

United Hospital Fund: *To provide technical assistance to agencies serving elders in naturally occurring retirement communities.*

Health Services:

Doctors of the World—U.S.A.: *To provide health care for asylum seekers and immigrants who have been victims of torture and domestic violence.*

New York Legal Assistance Group: *To provide legal representation to people with serious or chronic illnesses, including cancer.*

Health Systems & Policy:

Cover the Uninsured Week: *To educate policymakers and the public about the problems of people without health insurance.*

New York University, Robert F. Wagner School of Public Service: *To study the cost of increasing Medicaid enrollment.*

Mental Health & Mental Retardation:

Bowery Residents' Committee: *To improve services for mentally ill, homeless women.*

Job Path: *To expand mainstream work and volunteer opportunities for severely developmentally disabled people.*

SPECIAL PROJECTS & PHILANTHROPY

American Red Cross in Greater New York: *To use lessons learned from September 11th to help nonprofits and individuals develop disaster plans and train volunteers.*

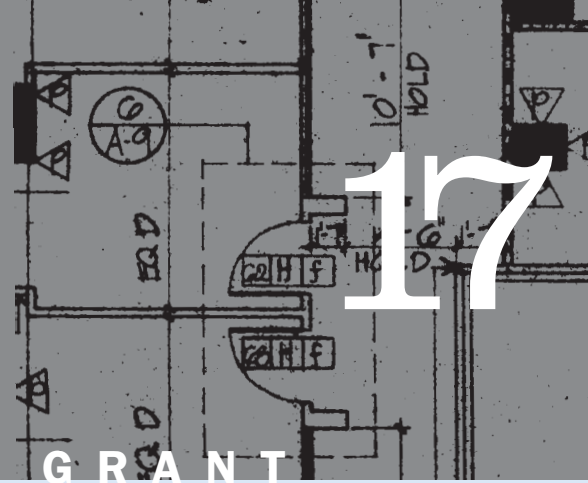

HOW TO APPLY FOR A GRANT

The Trust makes grants in four general areas: Children, Youth, and Families; Community Development and the Environment; Education, Arts, and the Humanities; and Health and People with Special Needs. We are committed to sticking with significant issues that may not lend themselves to quick or easy solutions, while remaining open to projects that tackle emerging problems and to organizations that may be new to us.

Grants are made primarily to nonprofit organizations located in the five boroughs of New York City. Our suburban divisions handle grants on Long Island and in Westchester (page 34). Grants for programs outside our area generally are from funds designated for specific charities or that have been made at the suggestion of donors.

Applicants should begin by requesting “Guidelines for Grant Applicants” and one or more of the four brochures that describe in detail each of our general grantmaking areas. We also suggest that you request copies of our bimonthly grants newsletter to get a sense of the kinds of projects we currently fund. Please call our receptionist at (212) 686-0010, ext. 0, or visit our Web site, www.nycommunitytrust.org.

If, after you have read our guidelines, you believe that one of your proposed projects meets our criteria, send us a cover letter along with a completed application form (enclosed with the guidelines), and a copy of the proposal—not more than 10 pages plus appendices. Include in your letter a brief summary of the proposal, the amount requested, and the results expected. We do not accept proposals sent by fax or e-mail.

Please note that we do not make grants to individuals and rarely for endowments, building campaigns, deficit financing, films, general operating support, or religious purposes.

We have no specific submission deadlines. Our Distribution Committee meets six times annually, and grant applications are accepted throughout the year.

We will let you know within two weeks that we have received your material. During the review process, Trust program staff will analyze your proposal, determine if and how it fits into our grantmaking program, and check to see if there is adequate money available in an appropriate fund. We will get in touch with you if we have further questions or need more information.

The Trust welcomes your application, but because we cannot possibly fund every proposal submitted to us, we urge you to send yours to several other funders as well.

Paul N. Turner 1869-1950



After working as a railroad telegrapher to finance his degree at Upper Iowa College, Paul Turner arrived in New York with 25 cents and a bunch of bananas.

Determined to become a lawyer, he enrolled at New York University Law School. To support himself, he worked as a cook and bartender at after-theater parties, jobs found for him by a well known actress who was his cousin. He met—and was fascinated by—scores of struggling young actors. When Paul eventually established a law practice, they came to him for help. He joined both The Players and The Lambs, the two most distinguished social clubs for actors. Concerned and understanding the needs of actors, he became convinced that they needed to organize and negotiate for a standard contract. In 1913, he helped found the Actors' Equity Association, and served as its counsel for 37 years, representing actors and helping keep the theater alive and healthy. Paul's early financial struggles had set a pattern of frugality, but in his will he set up a generous fund to benefit "individuals in the theatrical professions." A 2003 grant from this fund to the Actors' Fund of America is helping uninsured workers in the entertainment field get health insurance and improve their access to health care.



The New York Community Trust offers donors with every kind of philanthropic interest an easy and flexible way to accomplish their charitable objectives and receive the maximum tax deduction allowed by law on contributions.

TYPES OF FUNDS

An **unrestricted fund** is a good option for donors who want to be assured that their gift will always be used to meet vital needs and improve the quality of life in New York City. Our staff is expert in identifying community needs and the nonprofits best equipped to meet them.

A **donor-advised fund** is an unrestricted fund legally, but the donor recommends the organizations to receive grants. Although we cannot, by law, be bound by these recommendations, we take them very seriously and approve grants to recommended nonprofits that meet charitable standards for programmatic and financial soundness.

In a **field-of-interest fund**, charitable giving is focused on issues of concern to the donor, such as child and family welfare, youth, education, human justice, conservation, or health policy. The Trust makes grants that meet current needs in the chosen fields. Field-of-interest funds can also be advised by the donor.

A **designated fund** is for donors who want to support specific organizations but recognize that the world may change. They establish a designated fund in The Trust rather than leave it directly to the charity to assure that their gift remains relevant over time and responsive to changing circumstances. (See page 23 for an explanation of the variance power.)

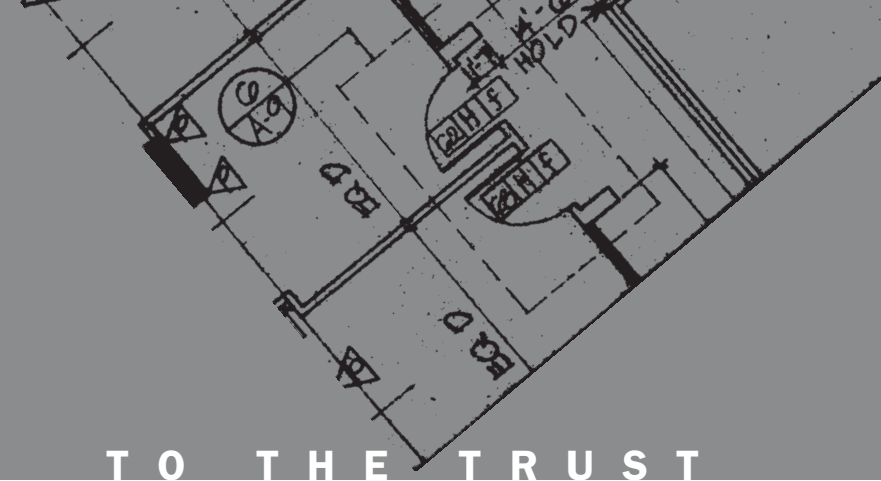

TO THE TRUST

SETTING UP THE FUND

Each donor establishes a separate account with us—called a fund—with a minimum of \$5,000. Donors first decide what they want to accomplish with their philanthropy; our staff is happy to help clarify and refine goals. They then choose the name of the fund, typically using their own names or the names of individuals to be honored or memorialized. Donors who prefer anonymity can choose a general name.

There are at least three ways of giving to a fund with us.

Giving Now: You can set up a fund to support charities during your lifetime and endow them to continue your philanthropy for future generations. Many of our donors regularly add money to the funds they have established.

Deferred Giving: Donors can set up funds through deferred-giving arrangements. A key feature of many estate plans is a tax advantage to you now for the commitment of a charitable gift later. Charitable Remainder Trusts, Charitable Lead Trusts, and gifts of life insurance or retirement plan assets can all be used.

Wills: After providing for personal bequests, you may include provisions for setting up a fund with us or adding to one you already have here. You will save estate taxes and ensure that the charitable work you care about will be continued.

TYPES OF ASSETS

Funds may be established with the following: cash, securities traded on major exchanges, closely held stock, mutual fund shares, retirement plan assets, real estate, interests in limited partnerships, and literature copyrights.

Samuel Prentiss Bailey 1890-1959



19
Sam Bailey's childhood dream was to become a farmer, but his first jobs after college were in journalism and advertising. When America entered World War I, he tried to enlist, but failed the physical.

On his own, he went to France, joined the French Army as an ambulance driver, transferred to the U.S. forces, became a hero to his French comrades, and was awarded both the French and the Belgian Croix de Guerre. After he was discharged, Sam joined the Paris branch of an American trust company, where he rose steadily from cashier to vice president. When the Germans occupied France in 1940, Sam and his French wife escaped to New York. He took a leave from the bank and moved to Washington, where he directed the Foreign Funds Control program for the Treasury Department. It was then that his desire to be a farmer returned. After the war, he and Denise bought a ranch in New Mexico, where he supervised the operation of thousands of acres and hundreds of cattle. Grateful for the many successes and good things that came his way, he established the S. Prentiss Bailey Fund. The Dance Theater Workshop used its 2003 grant from this fund to help contemporary dance groups increase their performance opportunities and bolster their management services.



Laura Spelman Rockefeller 1839-1915



When Laura Spelman, assistant principal of the Hudson Street School in Cleveland, married John D. Rockefeller in 1864, she began a life that centered around her home, her family, and her

church. Her four children were expected to work—at one time pulling weeds from the lawn at a rate of a penny for ten weeds. When oil was discovered in western Pennsylvania, John decided to go into the oil refining business. As the business grew, he moved his family from Cleveland to New York. During the 1880s, the Rockefellers traveled widely. Wherever they went, they always managed to find a little church where they attended services. Laura also became an adoring grandmother of 15 grandchildren. In the early 1900s, as Laura's health began to fail, she was forced to spend most of her days in bed. In September 1914, as John and Laura celebrated their golden anniversary at their home in Pocantico Hills, he said, "I have had but one sweetheart." She died the following spring. Her son, John, Jr., established a fund in The Trust in her memory to help the poor. A 2003 grant from this fund to Queens College of CUNY's Women and Work Program is helping expand a job training and placement program for poor young women.



We are glad to discuss proposed contributions with you. We may not be able to accept some assets that cannot readily be converted to the financial benefit of charity or that carry unusual potential liability.

FUND ADMINISTRATION AND FEES

A fund established with our organization may be held in trust with one of our 13 trustees (see page 38), or it may be held by Community Funds, Inc., our not-for-profit corporation. Both operate as The New York Community Trust with a single governing body. If a fund is set up in trust, the bank handles the investments and The Trust manages the distribution. If it is set up in Community Funds, our distinguished Investment Committee oversees the performance of our outside portfolio managers. The determining factor is the inclination of the donor. The service we provide is the same.

Funds that are held in trust are also charged a trustee's fee set by the bank. It can be negotiated at the inception of the fund and varies from bank to bank.

The administrative fee charged to our funds is remarkably low: 2.5 percent of grants paid or 3/10th of 1 percent (30 basis points) of assets, whichever is greater.

The Internal Revenue Service has classified The New York Community Trust and its affiliate, Community Funds, Inc., as "tax exempt" under Section 501(c)(3) of the Internal Revenue Code; as a "publicly supported" organization under Section 170b(1)(A)(vi); and as "not a private foundation" under Section 509(a)(1). This status ensures donors the maximum tax benefit allowed by law. The Long Island Community Foundation and the Westchester Community Foundation (described on page 34) are divisions of Community Funds, Inc.

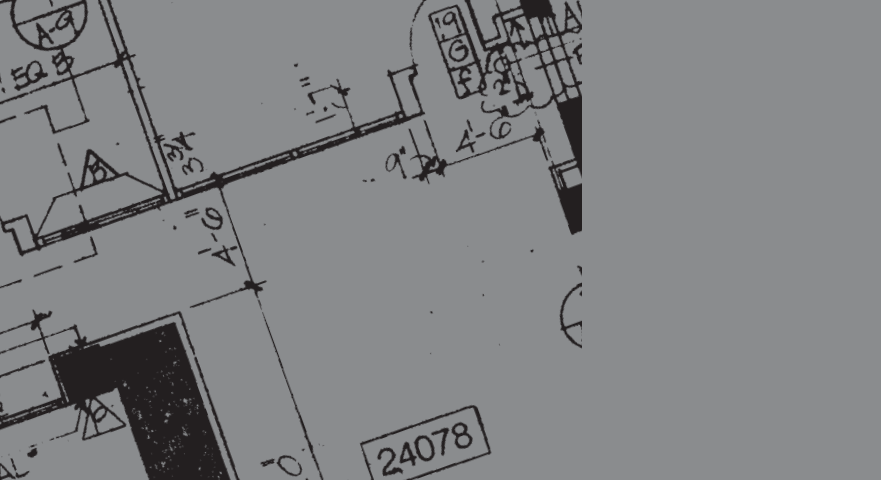

A FUND IN THE TRUST OR A PRIVATE FOUNDATION?

A fund in The Trust provides a very attractive alternative to establishing a private foundation. We are a public charity with the attendant tax advantages. A full-time professional staff takes care of all the administrative and grantmaking activities, eliminating the need to set up a separate institution, formulate policies, file innumerable forms, and monitor the status of grant recipients. Establishing a private foundation can take months and be costly; with The Trust, the legal apparatus is already in place, and creating a fund can take less than a day.

We also offer substantial advantages over most commercial donor-advised funds: lower fees, smaller minimums, the capacity to accept unusual gifts, and an in-depth knowledge of the nonprofit community. Because our business is philanthropy, we can help make sure that your money makes a difference.

FURTHER INFORMATION

The New York Community Trust is happy to work with you or with your lawyer, trust officer, or other financial advisor.

We invite you to get in touch with us at any time. Call Jane L. Wilton, Esq. (Ext. 379), Robert V. Edgar (Ext. 373), or Gay Young (Ext. 377) in our Donor Relations Department at (212) 686-0010.

Barbara Scott Preiskel 1924-2002

21



With her heart and mind always open, Barbara Scott Preiskel savored every minute of her life. She loved her years at Wellesley College, and became the second black woman to graduate from Yale Law School where she met her future husband,

Robert Preiskel. Her career began with a clerkship for a prestigious judge in Boston, followed by work with a major law firm. After her two sons were born, Barbara joined the Motion Picture Association of America where she spent 24 trailblazing years, ultimately becoming senior vice president and general counsel. She then began serving on dozens of corporate boards, but her true love was her involvement in charitable, educational, cultural, and civic organizations, where she pursued social justice and helped eradicate racial and gender barriers. In 1978, she joined the Distribution Committee of The New York Community Trust and served as its chairman from 1990 to 1995. When she was diagnosed with leukemia and had to be hospitalized, she greeted visitors with humor, courage, optimism, and a tenacity for life that was awesome. After she died on June 4, 2002, the Barbara S. Preiskel Memorial Fund was set up to continue support for the many issues that concerned her. A 2003 grant from this fund is helping Brooklyn Legal Services Corporation B provide legal help to low-income victims of domestic violence.





GUIDELINES FOR ATTORNEYS

Establishing a fund in The New York Community Trust for your client is a relatively straightforward process. Our comprehensive booklet, “Creating a Fund Here: Suggested Words and Procedures,” provides all the relevant details: The Trust’s tax classification letter, descriptive material on the different types of funds, and suggested language to help you draft instruments to provide for gifts to our organization. Call us to receive a copy.

THREE IMPORTANT FACTS

First, we are unable to accept a fund unless its terms have been reviewed by us and found acceptable. It is particularly helpful if we review the language before the instrument is executed to ensure that we can meet the donor’s purpose. Second, a co-trustee is not permitted under the *Resolution and Declaration of Trust Creating “The New York Community Trust.”* Third, all our funds enjoy an important advantage: If a change of circumstances makes literal compliance with the terms of the gift instrument “unnecessary, undesirable, impractical, or impossible,” our governing body is able to vary them. Donors are assured that their gifts will never become obsolete; they will remain useful to the community in perpetuity. Donors have the option of setting up funds in The New York Community Trust with a bank as trustee or in our not-for-profit corporate affiliate, Community Funds, Inc. The organizations share a governing board and file a single tax return with the IRS.

CREATING A FUND IN THE NEW YORK COMMUNITY TRUST

The *Resolution and Declaration of Trust Creating “The New York Community Trust”* (the “R & D”) is a complete trust instrument. It sets out in detail the powers and duties of the Trustee Bank and the Distribution Committee. In order to establish a fund in The New York Community Trust, the founding document—whether for a bequest or a gift during lifetime—must incorporate the R & D by reference.

An advantage of The New York Community Trust is that it is not a private foundation subject to certain requirements, and the separate funds that constitute The New York Community Trust are component funds of a public charity, not private foundations. It is important, therefore, that an instrument designed to create a new component fund in The New York Community Trust adhere strictly to the provisions of the R & D; please call us for a copy.

CREATING A FUND IN COMMUNITY FUNDS, INC.

Community Funds, Inc. is a New York State not-for-profit corporation. As with a fund in The New York Community Trust, a fund established in Community Funds becomes part of a publicly supported organization, and is not regarded as a private foundation. The fund is held and administered pursuant to the provisions of the Not-for-Profit Corporation Law. Please call us for a copy of the Certificate of Incorporation and By-Laws of Community Funds, Inc.

CREATING A FUND IN OUR LONG ISLAND OR WESTCHESTER DIVISION

Because the Long Island Community Foundation and the Westchester Community Foundation are divisions of Community Funds, donors have the same options described above.

COMBINED BALANCE SHEETS

The New York Community Trust and Community Funds, Inc. (including its Long Island and Westchester Divisions)

December 31, 2003 2002

Assets

Cash and cash equivalents	\$ 9,731,105	5,646,716
Investments (note 3)	1,762,883,728	1,539,856,306
Receivables	1,679,807	2,851,220
Prepaid pension expense (note 4)	1,563,007	1,910,748
Fixed assets, net	301,974	582,569

Total assets	\$ 1,776,159,621	1,550,847,559
---------------------	-------------------------	----------------------

Liabilities and Net Assets

Liabilities:		
Accounts payable and other liabilities (note 4)	\$ 1,122,800	1,104,719
Grants payable to beneficiaries	20,924,262	16,480,581

Total liabilities	22,047,062	17,585,300
--------------------------	-------------------	-------------------

Net assets:		
Unrestricted:		
Endowment	1,653,874,736	1,437,936,796
Available for grants	39,819,481	35,560,943
Available for administration	6,253,737	6,837,524

Total net assets-unrestricted	1,699,947,954	1,480,335,263
-------------------------------	---------------	---------------

Temporarily restricted:		
September 11th Fund (note 6)	54,164,605	52,926,996

Total net assets	1,754,112,559	1,533,262,259
-------------------------	----------------------	----------------------

Total liabilities and net assets	\$ 1,776,159,621	1,550,847,559
---	-------------------------	----------------------

See accompanying notes to combined financial statements.

COMBINED STATEMENTS OF ACTIVITIES

The New York Community Trust and Community Funds, Inc. (including its Long Island and Westchester Divisions)

Years ended December 31,	2003	2002
<hr/>		
Changes in unrestricted net assets:		
Revenues:		
Contributions	\$ 78,634,510	76,784,207
Interest and dividends	41,965,401	44,046,703
Gain (loss) on investments (net of investment expenses of \$7,599,059 in 2003 and \$7,090,790 in 2002)	225,825,635	(216,691,389)
	<hr/>	<hr/>
	346,425,546	(95,860,479)
Net assets released from restrictions (note 6)	—	64,657,000
	<hr/>	<hr/>
Total unrestricted revenues (losses)	346,425,546	(31,203,479)
<hr/>		
Expenses:		
Grants and services to beneficiaries	117,991,766	126,484,987
Cash assistance program (note 6)	—	64,657,000
Grantmaking expenses	3,076,860	2,181,929
Administrative expenses	4,341,251	4,586,443
Development expenses	1,402,978	1,266,099
	<hr/>	<hr/>
Total expenses	126,812,855	199,176,458
	<hr/>	<hr/>
Increase (decrease) in unrestricted net assets	219,612,691	(230,379,937)
<hr/>		
Changes in temporarily restricted net assets:		
Contributions	906,500	6,237,456
Transfer from the September 11th Fund (note 6)	—	55,000,000
Interest and dividends	331,109	528,844
Net assets released from restrictions (note 6)	—	(64,657,000)
	<hr/>	<hr/>
Increase (decrease) in temporarily restricted net assets	1,237,609	(2,890,700)
	<hr/>	<hr/>
Increase (decrease) in net assets	220,850,300	(233,270,637)
	<hr/>	<hr/>
Net assets at beginning of year	1,533,262,259	1,766,532,896
	<hr/>	<hr/>
Net assets at end of year	\$ 1,754,112,559	1,533,262,259
	<hr/>	<hr/>

See accompanying notes to combined financial statements.

COMBINED STATEMENTS OF CASH FLOWS

The New York Community Trust and Community Funds, Inc. (including its Long Island and Westchester Divisions)

Years ended December 31, 2003 2002

Cash flows from operating activities:

Increase (decrease) in net assets	\$ 220,850,300	(233,270,637)
Adjustments to reconcile increase (decrease) in net assets to net cash used in operating activities:		
Depreciation expense	280,595	286,975
(Gain) loss on investments	(233,424,694)	209,600,599
Decrease in receivables	1,171,413	4,551,559
Decrease (increase) in prepaid pension expense	347,741	(197,730)
Increase (decrease) in accounts payable and other liabilities	18,081	(11,077)
Increase (decrease) in grants payable to beneficiaries	4,443,681	(1,086,231)

Net cash used in operating activities **(6,312,883)** **(20,126,542)**

Cash flows from investing activities:

Purchases of investments	(762,475,550)	(770,212,286)
Proceeds from sales of investments	772,872,822	771,237,597

Net cash provided by investing activities **10,397,272** **1,025,311**

Net increase (decrease) in cash and cash equivalents 4,084,389 (19,101,231)

Cash and cash equivalents at beginning of year 5,646,716 24,747,947

Cash and cash equivalents at end of year **\$ 9,731,105** **5,646,716**

NOTES TO COMBINED FINANCIAL STATEMENTS

The New York Community Trust and Community Funds, Inc. (including its Long Island and Westchester Divisions)

December 31, 2003 and 2002

(1) Organization

The New York Community Trust and Community Funds, Inc. (including its Long Island and Westchester Divisions) are community foundations created to build permanent charitable endowments for the areas they serve. The Trust, as the combined foundations are hereinafter referred to, is tax-exempt under Section 501(c)(3) of the Internal Revenue Code (the Code) and has been determined not to be a private foundation under Section 509(a)(1) of the Code. The Trust administers more than 1,700 individual charitable funds, each established with an instrument of gift describing either the general or specific purposes for which grants are to be made, usually from income only, but in some cases from principal.

(2) Summary of Significant Accounting Policies

Accounting standards provide that if the governing body of an organization has the ability to remove a donor restriction, the contributions should be classified as unrestricted net assets. However, under New York State law and The Trust's governing instruments, the assets are held as endowment funds until such time (if ever) as the governing body deems it prudent and appropriate to expend some part of the principal or appreciation. Accordingly, the combined financial statements classify all net assets as unrestricted, except for those net assets restricted for the September 11th Fund (see note 6), but segregate the portion that is held as endowment from the funds that are currently available for grants and administration.

Cash equivalents represent short-term investments with original maturities of ninety days or less, except for those short-term investments managed as part of long-term investment strategies.

Investments are carried at fair value. The fair value of investments in common trust funds is based upon the fair value provided by the trust managers. Limited partnership interests are reported at fair value as determined by the general partner of each limited partnership. The carrying amount of all other financial instruments approximates fair value.

Fixed assets are recorded at cost and are depreciated on a straight-line basis over the estimated life of the respective asset. Leasehold improvements are amortized over the life of the respective improvement or the remaining term of the lease, whichever is shorter. Fixed assets are reported net of accumulated depreciation of \$2,029,518 in 2003 and \$1,792,946 in 2002.

Investment expenses include fees for bank trustees, investment managers, and custodians.

Grants and services to beneficiaries are expensed upon approval of the Distribution Committee of The New York Community Trust or the Board of Directors of Community Funds, Inc.

Accounting estimates are an integral part of the combined financial statements prepared by management and are based upon management's current judgments. Actual results could differ from those estimates.

Certain 2002 amounts have been reclassified to conform to the 2003 presentation.

(3) Investments

Investments consist of the following at December 31,	2003	2002
Mutual funds	\$ 788,620,022	526,761,689
Common stocks	337,519,267	268,483,018
Common trust funds	245,347,203	359,366,328
Short-term investments	122,602,780	102,600,954
Corporate bonds	112,143,411	128,691,543
U.S. Government obligations	87,720,622	91,599,639
Limited partnerships and other	68,930,423	62,353,135
	<u>\$ 1,762,883,728</u>	<u>1,539,856,306</u>

NOTES CONTINUED

(4) Pension and Postretirement Medical Benefit Plans

The Trust administers a noncontributory defined benefit pension plan covering substantially all employees. Benefits are based on years of service and the employee's compensation during the five highest consecutive years during the last ten years of employment. The Trust also provides medical insurance benefits for its eligible retired employees.

The following sets forth financial information about the plans as of December 31, 2003 and 2002:

	Pension benefits		Other benefits	
	2003	2002	2003	2002
Benefit obligation at December 31	\$ 9,434,838	7,271,340	1,055,197	873,716
Fair value of plan assets at December 31	10,875,500	7,595,680	—	—
Funded status	\$ 1,440,662	324,340	(1,055,197)	(873,716)
Prepaid (accrued) benefit costs recognized in the combined balance sheets	\$ 1,563,007	1,910,748	(1,031,557)	(994,240)
Benefit costs	\$ (347,741)	(197,730)	84,865	59,929
Benefits paid	\$ 297,876	253,390	47,548	30,223

The weighted average discount rate for the pension and other benefits plans for December 31, 2003 and 2002 are 6.0% and 6.5%, respectively. The weighted average expected return on plan assets and rate of compensation increase for the calculation of the pension benefits are 8.0% and 5.0% respectively as of December 31, 2003 and 2002. The health care trend rate assumption for 2003 was 8.5%, declining each year to 5% in 2010.

The Trust also sponsors a defined contribution retirement plan for employees, in which contributions are based upon a specified percentage of salaries. Retirement plan expense was \$393,300 and \$357,412 in 2003 and 2002, respectively.

(5) Commitments

The Trust leases office space in New York under a lease expiring on December 31, 2004, which requires future minimum rental payments of \$954,940. In addition, on March 30, 2004, The Trust entered into a lease agreement for office space expiring March 31, 2020. Future minimum rental payments for the new lease are as follows:

2004	\$	—
2005		879,424
2006		1,172,566
2007		1,172,566
2008		1,172,566
Thereafter		15,505,643
Total:	\$	19,902,765

Rent expense for the years ended December 31, 2003 and 2002, net of sublease income of \$88,000 in 2003 and \$84,000 in 2002, amounted to \$976,000 and \$965,000, respectively.

NOTES CONTINUED

(6) September 11th Fund

The Trust and United Way of New York City (United Way) established the September 11th Fund (the Fund) to help respond to the events of September 11, 2001. To assure that monies from the Fund were spent effectively, without undue delays, and in a manner that ensured accountability, they appointed a governing committee (the September 11th Fund Board) and retained a chief executive. The Trust and United Way authorized the Fund to establish grant guidelines and determine distributions from the Fund.

Both The Trust and United Way accepted contributions for the Fund. As of December 31, 2003, more than \$520 million (unaudited) had been contributed and grants of more than \$470 million (unaudited) had been made from the Fund. The accompanying financial statements only show the amounts received by The Trust. The remaining contributions were received by and the grants were made by United Way, which acted as the Fund's dispersing agent through December 31, 2003; the transactions are recorded on United Way's financial statements. The financial statement of the Fund was audited for the year ended July 31, 2003.

At its December 6, 2001 meeting, the September 11th Fund Board authorized the Cash Assistance Program for victims. Because United Way's charter does not permit it to make grants to individuals, it could not act as disbursing agent and so made transfers of \$55 million and \$75 million in 2002 and 2001, respectively, from the September 11th Fund to The Trust to administer this program. As of July 18, 2002, those transferred amounts had been granted to individuals.

INDEPENDENT
AUDITORS' REPORT

Distribution Committee of The New York Community Trust and Board of Directors of Community Funds, Inc.:

We have audited the accompanying combined balance sheets of The New York Community Trust and Community Funds, Inc. (including its Long Island and Westchester Divisions) as of December 31, 2003 and 2002 and the related combined statements of activities and cash flows for the years then ended. These combined financial statements are the responsibility of the Organizations' management. Our responsibility is to express an opinion on these combined financial statements based on our audits.

We conducted our audits in accordance with auditing standards generally accepted in the United States of America. Those standards require that we plan and perform the audit to obtain reasonable assurance about whether the financial statements are free of material misstatement. An audit includes examining, on a test basis, evidence supporting the amounts and disclosures in the financial statements. An audit also includes assessing the accounting principles used and significant estimates made by management, as well as evaluating the overall financial statement presentation. We believe that our audits provide a reasonable basis for our opinion.

In our opinion, the combined financial statements referred to above present fairly, in all material respects, the financial position of The New York Community Trust and Community Funds, Inc. (including its Long Island and Westchester Divisions) as of December 31, 2003 and 2002, and the changes in their net assets and their cash flows for the year then ended in conformity with accounting principles generally accepted in the United States of America.

KPMG LLP

April 23, 2004



30

A mother learns child-rearing and play techniques through a program run by Children of Bellevue.

INVESTMENT COMMITTEE MEMBERS

Lulu C. Wang, Chairman
Chief Executive Officer
Tupelo Capital Management, LLC

Bruce W. Calvert*
Chairman
Alliance Capital Management

Elizabeth B. Dater*
Managing Director
Forstmann-Leff Associates, LLC

Donald R. Kurtz*
Former Managing Director
North American Equity Assets
General Motors Investment Management Corp.

Lorie A. Slutsky
President
The New York Community Trust

*Consulting Member
Affiliations for identification purposes only.

ASSETS BY FUND TYPE

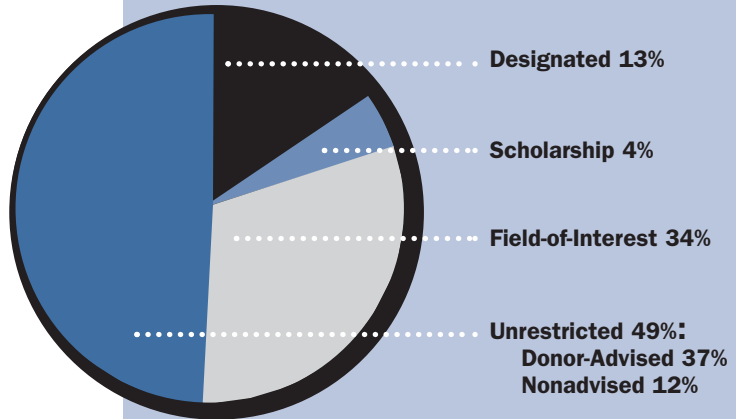

GRANTS BY PROGRAM AREAS

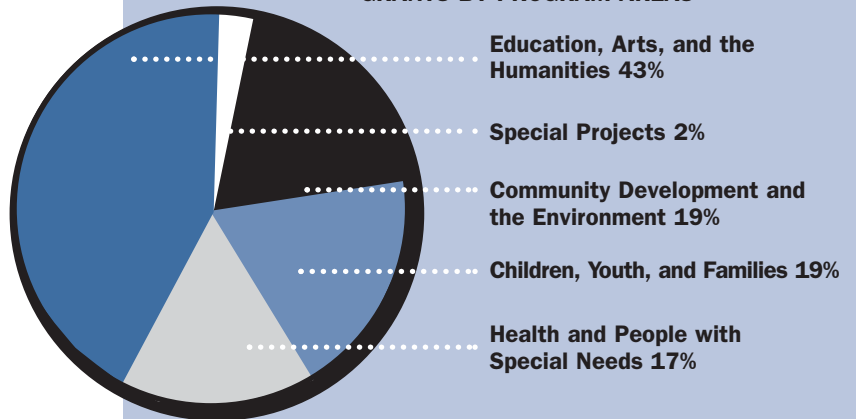

TOTAL EXPENDITURES

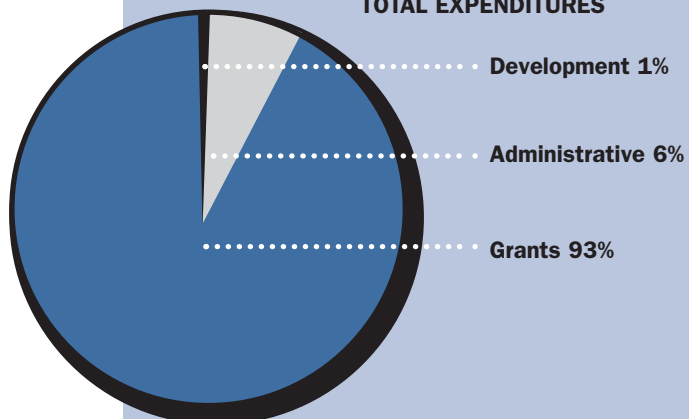

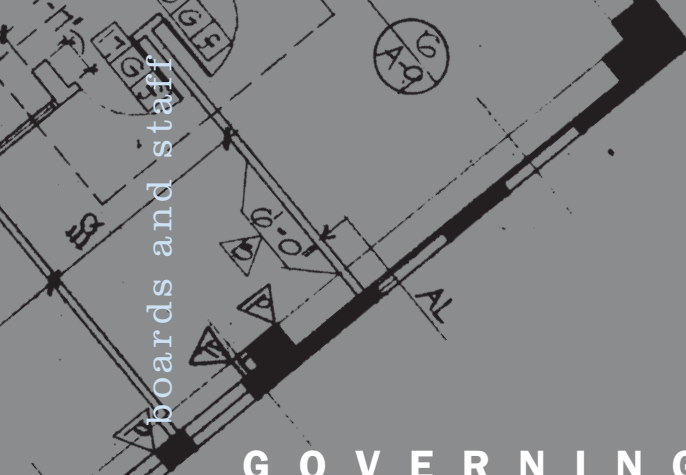

G O V E R N I N G B O D Y

The governing body consists of 12 members who serve as the Distribution Committee of The New York Community Trust and as the Board of Directors of Community Funds, Inc. It is their responsibility to oversee our organization's operations and grantmaking.

Six members are nominated by civic authorities representing the public: one by the Mayor of the City of New York; one by the Chief Judge of the United States Court of Appeals for the Second Circuit; one by the Chairman of the New York City Partnership and Chamber of Commerce; one by the Chairman of Lincoln Center for the Performing Arts; one by the President of the Association of the Bar of the City of New York; and one by the President of the New York Academy of Medicine. The Trustees' Committee nominates five members, and the President of The Trust is a member by reason of office.

Members serve without compensation. They are selected for their judgment, integrity, and understanding of philanthropic needs. The Committee meets every two months throughout the year; subcommittees meet on a regular basis.

The Finance Committee monitors the financial operations of The Trust. The Investment Committee (see page 31) establishes asset allocation guidelines, recommends investment advisors and vehicles, and monitors investment performance. The Fund Purposes and Suggestion Review Committee assures that the provisions and intent of each donor's philanthropy are honored, and reviews grants suggested by donors to ensure that they meet our charitable guidelines.

Anne P. Sidamon-Eristoff, Chairman

Chair Emerita, American Museum of Natural History; Director: Black Rock Forest Consortium, God Bless America Fund, Greenacre Foundation, Highland Falls Public Library, Hudson River Foundation, September 11th Fund, Storm King Art Center, World Wildlife Fund/US; Former Director, Girl Scout Council of Greater New York, Museum of Modern Art, Scenic Hudson.
Nominated by the Mayor of the City of New York.

Robert M. Kaufman, Vice Chairman

Partner, Proskauer Rose LLP; Board Chair, Old Westbury Funds, Inc.; Trustee, Brooklyn Law School; Director, September 11th Fund; Chair Emeritus: Fund for Modern Courts, Times Square Alliance; Past President: Association of the Bar of the City of New York, American Judicature Society.
Nominated by the Trustees' Committee.

Barbara H. Block

Board Member: Lincoln Center for the Performing Arts, Lincoln Center Institute, Music From Marlboro, Usdan Center for the Performing Arts, George Gustav Heye Center–National Museum of the American Indian; Recipient: James Smithson Society Founder Medal, Smithsonian Institution; 1998 Directors Emeriti Award, Lincoln Center for the Performing Arts.
Nominated by the Chairman of Lincoln Center for the Performing Arts.

Ernest J. Collazo (not pictured)

Managing Partner, Collazo Carling & Mish LLP; Executive Committee, Association of the Bar of the City of New York; Director: United Hospital Fund of New York, Inc., VIP Community Services, September 11th Fund; Member: Federal Bar Council (Committee on Second Circuit Courts), Federal Bar Council Inn of Court (Master), Advisory Committee to the Rules Committee of the Second Judicial Circuit of the U.S., Labor Advisory Council (to the Health Care Industry); Former Director: Lehman College Foundation, City Bar Fund.
Nominated by the Chief Judge of the U.S. Court of Appeals for the Second Circuit.

Charlynn Goins

Trustee: Mainstay Funds, Continuum Health Partners, Brooklyn Museum of Art; Director: The Community's Bank, Urban Financial Group, FOJP Service Corporation; Member, Council on Foreign Relations; Former Senior Vice President, Prudential Securities.
Nominated by the Trustees' Committee.



Jeh Charles Johnson

Partner: Paul, Weiss, Rifkind, Wharton & Garrison LLP; Former General Counsel of the U.S. Air Force (1998-2001); Former Assistant United States Attorney (1989-91); Chairman, Judiciary Committee of the New York City Bar Association; Member: Council on Foreign Relations, ABA Standing Committee on Law and National Security, the American Law Institute; Trustee, Adelphi University; Former Director: Legal Aid Society, Vera Institute, Lawyers' Committee for Civil Rights Under Law, New York Hall of Science, Film Society of Lincoln Center, City Bar Fund. *Nominated by the President of The Association of the Bar of the City of New York.*

Anne Moore, M.D.

Professor of Clinical Medicine, Joan & Sanford I. Weill Medical College of Cornell University; Director of Breast Oncology, New York Presbyterian Hospital; Trustee, New York Academy of Medicine. Former Director, American Board of Internal Medicine; Past President, New York Metropolitan Breast Cancer Group. *Nominated by the President of The New York Academy of Medicine.*

Samuel S. Polk

Retired Partner, Milbank, Tweed, Hadley & McCloy; Trustee: Hospital for Special Surgery, Medical Indemnity Assurance Co., Ltd., Cooper Union for the Advancement of Science & Art, Frederick R. Koch Foundation, Collier Foundation, Westchester Land Trust. *Nominated by the Trustees' Committee.*

Lorie A. Slutsky

Director, The New York Community Trust; President: Community Funds, Inc., The James Foundation; Secretary, Trustees' Committee, The New York Community Trust; Chairman, BoardSource; Trustee: The Center on Philanthropy at Indiana University, New School University; Director, Alliance Capital Management LP; Former Member: Board of Directors, Council on Foundations, (Chairman), The Foundation Center (Vice Chairman), Hispanics in Philanthropy; Trustee Emerita, Colgate University. *Member by reason of office.*

Estelle (Nicki) Newman Tanner

Director, Oral History Project, UJA-Federation of Jewish Philanthropies of New York; Chair: WNYC Radio, Jewish

Women's Archive; Trustee: Colonial Williamsburg Foundation (Executive Committee), UJA-Federation of Jewish Philanthropies of New York; Trustee Emerita, Wellesley College. *Nominated by the Trustees' Committee.*

Carroll L. Wainwright, Jr.

Consulting Partner, Milbank, Tweed, Hadley & McCloy; Trustee, Edward John Noble Foundation; Director: Greater Yellowstone Coalition, University of Pretoria, South Africa, Fund; President, Waterfowl Research Foundation; Honorary Trustee: American Museum of Natural History, Boys' Club of New York, Cooper Union for the Advancement of Science and Art. *Nominated by the Trustees' Committee.*

Lulu C. Wang

Chief Executive Officer, Tupelo Capital Management LLC; Trustee: Wellesley College, Metropolitan Museum of Art, WNYC Radio; Overseer, Columbia Business School; Director, September 11th Fund; President, Shoreland Foundation; Finance Committee, Rockefeller Family Fund. *Nominated by the Chairman of the New York City Partnership and Chamber of Commerce.*

CONSULTING MEMBERS

Bruce L. Ballard, M.D. (not pictured)

Associate Dean for Student Affairs & Equal Opportunity Programs and Associate Professor of Clinical Psychiatry, Joan & Sanford I. Weill Medical College of Cornell University.

William M. Evarts

Senior Counsel, Pillsbury Winthrop LLP; Former Chairman, The New York Community Trust Distribution Committee.

Charlotte Moses Fischman

Partner, Kramer Levin Naftalis & Frankel LLP.

Barry H. Garfinkel

Of Counsel, Skadden, Arps, Slate, Meagher & Flom.

Judah Gribetz

Counsel, Bingham McCutchen LLP.

Seated left to right: Judah Gribetz, Jeh Johnson, Lorie Slutsky, Anne Sidamon-Eristoff, Robert Kaufman. Standing, left to right: Barry Garfinkel, Nicki Tanner, Lulu Wang, William Evarts, Samuel Polk, Carroll Wainwright, Charlotte Fischman, Anne Moore, Barbara Block, Charlynn Goins

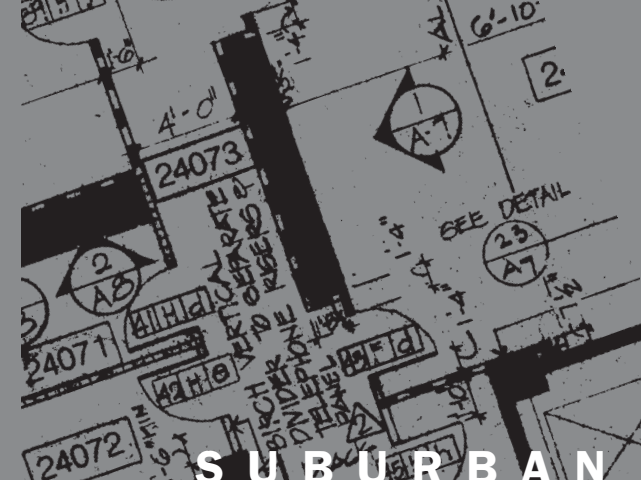

With the belief that grantmaking is most effective when it is done locally, The Trust established divisions that reach out to the greater metropolitan area: the Westchester Community Foundation, founded in 1975, and the Long Island Community Foundation, founded in 1978.

Each is guided by a board of advisors composed of local community leaders and staffed by people expert in grantmaking and donor service. As part of The Trust, Long Island and Westchester enjoy our investment management, legal, financial, and accounting services. For donors who wish to contribute to charities in these communities, our suburban divisions offer the best of all worlds: they combine sensitivity to local concerns with the economies of scale and expertise of a large organization.

Funds in each division are listed on the following two pages.

LONG ISLAND COMMUNITY FOUNDATION

The Elias Hicks House
1740 Old Jericho Turnpike
Jericho, NY 11753
(516) 681-5085
www.licf.org

Board of Advisors:

Abraham Krasnoff, Chairman
Fred Bornstein
Lawrence E. Davidow
Hon. Cynthia Diaz-Wilson
Patrick J. Foye
Roslyn D. Goldmacher
Amy Hagedorn
Robert M. Hoyte
Aldustus E. Jordan III
John D. Miller
Raymond C. Radigan
Marge Rogatz
Betty Schlein
Pearl F. Staller

WESTCHESTER COMMUNITY FOUNDATION

470 Mamaroneck Avenue
Suite 304
White Plains, NY 10605
(914) 948-5166
www.wcfcharity.org

Board of Advisors:

Elaine Schroeder, Chairman
Warren F. Ilchman, Vice Chairman
Richard A. Berman
Manuel Boado
Jacqueline L. Dunbar, M.D.
Barbara L. Edwards
Denise S. Farrell
George Gumina
Debra Shaw Hess
Rosa Blackwell Lawrence
Judith Z. Matson
Matthew G. McCrosson
Katherine Cromwell Moore
Ralph E. Penny
Raymond M. Planell
Jennifer M. Rutledge
Kathy Shea
Jamie Shenkman
Sabin C. Streeter

DIVISIONS



Children plant seeds, care for young plants, and harvest and cook them at the East End Community Organic Farm.

LONG ISLAND FUNDS

- Dennis P. Angermaier Memorial Lifeguard Scholarship Fund (2002)
Alexander Baldwin Memorial Scholarship Fund for Massapequa High School (2000)
Stanley & Marion Bergman Family Charitable Fund (1996)
Willa & Robert Bernhard Fund (1997)
Mollie Biggane Melanoma Fund (2000)
Ruby & Michael Bornstein Memorial Fund (1978)
*Captain William F. Burke, Jr. Memorial Fund (2003)
Capell Family Fund (2001)
Richard M. Caproni Memorial Scholarship Fund (2001)
Helene & Richard Cepler Family Fund (2000)
Chakiryan Family Fund (2002)
Arthur A. Chaplin GSB Fund (2001)
Charity Society Fund (2000)
Charlie's Long Island Fund (1985)
Childcare Assistance Fund (1996)
George J. Conklin Scholarship Fund (1989)
Corporate Initiative Fund (1990)
Ann Caroline Corrody Fund (1999)
*Cumulus Long Island Fund (2003)
Davidow Elderly Community Assistance Fund (1996)
Percy Douglass Memorial Education Fund (1985)
Eiber Family Fund (2000)
ENEE Philanthropic Fund (1994)
Martha C. Entenmann Scholarship Fund (1999)
Tiffani Bea Feldman Children's Fund (2000)
Diane Lash Ferber Fund (1996)
*Mark Fischgrund Memorial Fund (2003)
Walter & Sandra Fish Charitable Fund (1997)
Forman Fund (2002)
Anne & Frank Freeman Fund (1997)
Robert C. Frey Fund (1999)
Fund for the Future of Long Island Women & Girls (1997)
Fund for Innovative Community Programs on Long Island (1985)
Funders Collaborative for Early Care & Education on Long Island (2002)
Glenn Gerrato Scholarship Fund (2001)
Jerry & Franette Gil Family Fund (1999)
Neil Giske Memorial Scholarship Fund (1985)
Selma Greenberg Fund (1997)
*Greentree Foundation Fund (2003)
Grundman Memorial Scholarship Fund (1990)
Horace & Amy Hagedorn Long Island Fund (1996)
Kristy Lyn Haley Memorial Fund (2000)
Hand & the Spirit Fund (1999)
F. & M. Harris Family Fund (2001)
Robert E. & Barbara W. Harrison Fund (1997)
Helen's Fund (1998)
E.B. Hubbard Fund (2002)
Julie Hunnewell Fund (1987)
Alma D. Hunt/VCM L.I. Fund (1997)
Idie Fund (2000)
Douglas Jackson Memorial Scholarship Fund (1996)
Berenice & Herman Jacobs Family Fund (1997)
Lucille S. & Martin E. Kantor Fund (1993)
Edith R. Karel Fund (1998)
Karish Education Fund of the Horticultural Alliance of the Hamptons (2000)
*David & Dale Karp Family Charitable Fund (2003)
Kenneth L. & Veronica K. Katz Fund (1999)
Kenneth L. & Veronica K. Katz Advisory Fund (1999)
Leo & Freda Keller Memorial Fund (2000)
Kids Making a Difference Fund (2000)
Morton L. Kimmelman Fund (2001)
Kingfisher Fund (1998)
Andrea B. & Peter D. Klein Fund (1999)
Beverly & Harvey Klein Fund (2001)
Krasnoff Family Fund (1985)
*Patricia Kucinski Memorial Fund (2003)
Ed & Lee Lawrence Fund (1988)
Lawrence Metal Products Fund (2000)
Lilo & Gerard Leeds Fund (1994)
Levin Family Fund (1997)
J & E Levy Fund (1996)
LICF Operating Fund (1989)
LITAC Fund (1989)
Marian & William Littleford Fund (1993)
Christopher J. & Susan E. Lockwood Fund (1996)
Long Island Fund for the Arts (1984)
Long Island Fund for Education (1987)
Long Island Fund for Women & Girls (1992)
Long Island Fund for Youth Programs (1987)
*Long Island Nonprofit Crisis Fund (2003)
Long Island Unitarian Universalist Fund (1992)
Roselle Patricia Luciano Literacy Fund for Women (1996)
Kendall Madison Leadership Fund (1995)
George Maeweather Community Scholarship Fund (1995)
*Mancino Family Fund (2003)
William T. & Lynn Steppacher Martin Fund (2001)
Massapequa Community Fund (2001)
Matthew 25:35 Fund (1999)
Helen P. McIntyre Fund (1986)
Helen P. & Randall P. McIntyre Fund (1998)
Alan P. Mendelsohn Memorial Scholarship Fund (1999)
Shelley Metzenbaum & Steven Kelman Family Fund (1999)
Byron T. Miller Memorial Fund (1992)
John D. Miller Fund (2001)
Millie Fund (2000)
William E. Mintzer Memorial Fund (1999)
Miracle-Gro Fund (2001)
Joseph & Marion L. Mitola Family Fund (1999)
Alan Morton Foundation Fund (1998)
Michael Moverman Memorial Fund (1998)
Nash Fund (1996)
Nassau County Red Cross Fund (1998)

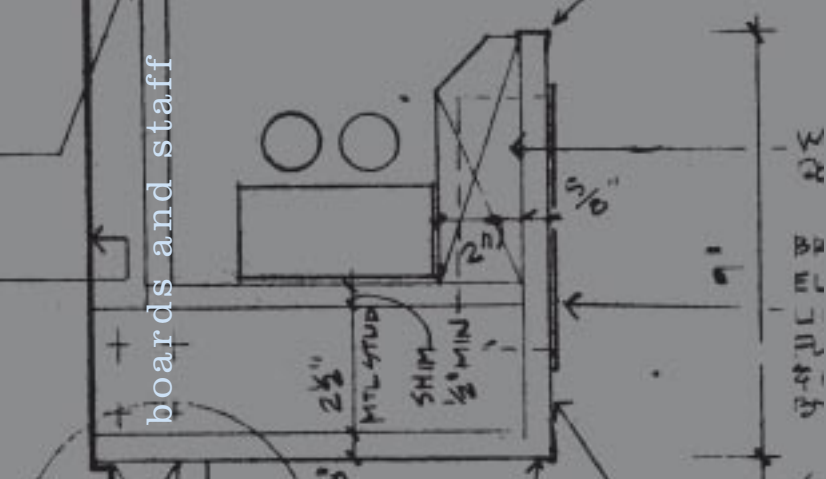

Nassau/Suffolk Fordham Law Alumni Scholarship Fund (1991)
 NCJW South Shore Section Community Fund (1995)
 North Country Community Association Fund (2002)
 *North Fork Fund (2003)
 Northrop Grumman Endowment Fund for L.I. Women & Girls (1996)
 Sylvia & Morris Paley Fund (2002)
 Paul's Fund (2002)
 Henry D. Pearson, Jr. Memorial Fund (1992)
 Peconic Stewardship Fund (1984)
 Perry Persichilli Memorial Fund (1996)
 *James & Margaret Philbin Scholarship Fund (2003)
 Harriet B. & Edward Everett Post Fund (1986)
 Elizabeth Pritzker Endowment Fund (1985)
 Rhino Fund (2001)
 Rhodebeck Long Island Fund (1998)
 Richards Family Fund (1987)
 Rising Star Fund (1999)
 Charlotte S. & Richard D. Rockwell Fund (1999)
 Rose Fund (1998)
 Judith Rubertone Fund (1987)
 Cheryl & Stephen Rush Fund (1999)
 Saltzman Fund (1987)
 Arnold Saltzman Family Charitable Fund (2001)
 Joan & Arnold Saltzman Fund (1989)
 Sidney Schiffman Fund (1996)
 Betty & Richard Schlein Fund (1997)
 Schneidman Family Fund (2000)
 Caroline & Sigmund Schott Fund (1999)
 Schwartz Family Fund (1991)
 Selig Fund (1991)
 Samuel & Stella Seligsohn Fund (1996)
 Jerry & Cecile Shore Fund (1995)
 Meredyth H. Smith Charitable Fund (1997)
 Colonel William Smith Foundation (1984)
 E. & R. Smits Fund (2001)
 Song of Songs Fund (2002)
 Staller Scholarship Fund (1987)
 Erwin P. & Pearl F. Staller Charitable Fund (1992)
 Adam E. Stark Memorial Scholarship Fund (2001)
 *Nancy Steinman Fund (2003)
 Frances R. Storrs Fund (2000)
 Sunida Fund (1998)
 Carol & Jim Swiggett Fund (1997)
 Taca Family Fund (1996)
 Ruth Saltzman Taishoff Fund (1996)
 *Gail Talent Memorial Fund (2003)
 Stuart & Jill Tane Charitable Fund (1997)
 James & Marie Taormina Fund (1999)
 Tealison Fund (1998)
 Tealison Two Fund (2001)
 United Way of Long Island's Human Care Fund (1992)
 Joseph Vigilante Fund for the Adelphi School of Social Work (2000)
 Phyllis S. Vineyard Fund (1996)
 Vishnick Family Charitable Fund (2001)

Voices from the Heart Fund (1997)
 Elizabeth & Eugene Wadsworth Charitable Fund (1999)
 Hilda S. Weiser Memorial Fund (1998)
 Charles J. Williams Fund (1986)
 *Work Long Island (2003)

WESTCHESTER FUNDS

Apoyo Fund (2002)
 Ardee Fund (1994)
 Arfa Family Fund (1997)
 Ascher Fund (1999)
 Linda Ashear Fund (2001)
 Barringer-Spaeth Fund for Change (2002)
 Joan Bartels Memorial Fund (1997)
 Beverly Bender Fund (2000)
 Helen Benedict Fund (2000)
 Howard & Grace Benedikt Fund (2002)
 *Bianco Family Fund (2003)
 Blecher Family Fund (1986)
 Albertina Bloom Memorial Fund (1985)
 Samuel & Beatrice Marks Bloom Memorial Fund (1998)
 Blumer Family Fund (1998)
 Jack Brennan Fund (2002)
 Buerger Fund (2001)
 Tony Carlucci Scholarship Fund (1999)
 Jesse L. Carroll, Jr. & Judith B. Carroll Fund (1986)
 H. M. & T. Cohn Fund (1977)
 *Larry Cole Memorial Fund (2003)
 Michael A. Correa Memorial Fund (2002)
 Nancy & Robert DeLigter Boy Scout Memorial Fund (1991)
 Michele & Concetta DeRosa Fund (2000)
 Alyson & Parker Drew Fund (2000)
 Linda A. & James H. Ellis Fund (1999)
 Ernie, Louise & Jeffrey Early Childhood Fund (1995)
 *Esplanade Fund (2003)
 Falk Family Fund (1986)
 Celia Malbin Feinstein Fund (1992)
 *Arnold E. & Olga C. Feldman Fund (2003)
 Peggy Friedman Memorial Fund (1989)
 Fund for Westchester's Environment (2001)
 Fund for Westchester's Future (1987)
 Gallagher Family Charitable Fund (1999)
 Charles Gamper Fund (1985)
 J.F. & M. Gelband Fund (1995)
 Bella & Reuben Gilbert Fund (1992)
 Lloyd & Lonya Gilbert Fund (1991)
 Glassberg Family Fund (1997)
 Rachel Greenstein Memorial Fund (1988)
 Carol & Frank Headley Family Fund (1996)
 Jeanne & Lee Heffner Fund (2000)
 John & Marilyn Heimerdinger Fund (1994)



High school students and professional musicians perform together as part of the Westchester Conservatory of Music's Mentoring Symphony Orchestra.

- Russell Hexter Filmmaker Fund (1997)
Julian H. Hyman Memorial Fund (1985)
Alice & Warren Ilichman Fund (2000)
Izard Fund (1997)
Jade Fund (1999)
Paul & Barbara Jenkel Fund (1998)
Edwin Irving Johnson Scholarship Fund (1985)
*Janet A. Johnson Scholarship Fund (2003)
Kadejay Fund (1998)
Kimerling Career Development Fund (2000)
Stephanie H. & Robert A. King Fund (1994)
Learning Center Fund (1994)
Dorothy & John Lebor Fund (1999)
James L. Leinwand Fund (1998)
David F. & Dorothy W. Linowes Fund (1999)
Linville Fund (1993)
William J. & Helen Z. Lippincott Fund (1994)
James M. Lober & Lois B. Lober Fund (1998)
Karin Lopp Fund (1998)
Elizabeth Lorentz Fund (1986)
Lester & Helen Levinthal Lyons Fund (1994)
John F. Maloney Memorial Fund (1998)
Patrick J. McNeill Scholarship Fund (1997)
Menzies Fund (2002)
Middleton Family Fund (2001)
Asa Uyeda Mitsudo & Sumi Lynn Koide Memorial Fund (1996)
David & Katherine Moore Family Foundation Fund (2000)
Nathan Moscow Fund (1985)
Munson Family Fund (2000)
David & Rhoda Narins Family Fund (1999)
Eda & Stanley Newhouse Fund (1983)
James L. Newhouse Fund (1986)
Thomas J. & Margaret Lynch O'Connor Scholarship Fund (1994)
Olmezer Westchester Fund (1998)
Pammy Fund (1989)
Passionist Fund (1995)
Lawrence R., Jr. & Thelma Dale Perkins Fund (1993)
Perry Family Fund (1988)
Roger Perry Memorial Fund (1999)
Roger & Isobel Perry Memorial Fund (2000)
Pisacano Family Fund (1995)
Pottinger Fund (1994)
Sal J. Prezioso Fund for Westchester's Future (2001)
Putnam Fund (1999)
George E. & Elizabeth A. Reed Fund (2001)
Reiman Brothers Fund (1999)
Rudyard & Emanuella Reimss Memorial Fund (2001)
Elsie Reinhart Memorial Fund (1991)
Nathan Rosen Memorial Fund (1996)
Vito & Diana Russo Fund (1988)
Elaine & Edmund Schroeder Fund (2002)
Dr. Lester J. Schultz Memorial Fund (1984)
- Robert & Lynne Schwartz Fund (1986)
Shea Family Memorial Fund (2001)
Dorothy F. & William B. Shore Fund (2000)
Carl Slater Memorial Fund (1998)
Bradford & Pamela Smith Charitable Fund (2000)
Karena Somerville AWC Scholarship Fund (1992)
*Dr. John B. Sommi Fund (2003)
Ruth & Irwin M. Stein Fund (1986)
Andrew Stewart Memorial Fund (1999)
Edward Storck Memorial Scholarship Fund (1996)
Sturmer Family Fund (1996)
Sullivan Family Fund (1994)
James A. & Katherine D. Sutton Fund (1999)
Martin Tackel & Abbe Raven Family Fund (1998)
Alfonso Tapia & A. L. Rose Memorial Fund (1994)
Technical Support Fund (1998)
*Threerandomwords Fund (2003)
Jodie Torigian Charitable Fund (2000)
Triantafillu Fund (1983)
W. Lee Tuller Memorial Fund (1983)
W. Lee Tuller Memorial Education Fund (1983)
Arno & Peppi Ucko Family Fund (1998)
Wallace Westchester Fund (1988)
Bernice & Irwin Warshaw Fund (1990)
Nicholas C. Wasicsko Scholarship Fund (1993)
Westchester Community Foundation (1975)
Westchester Fund for Women & Girls (1992)
Westchester Health Fund (2001)
Westchester Opportunity Fund (1993)
Westchester Poetry Fund (2000)
Westchester Wilderness Walk Fund (2001)
Frank E. Wigg Charitable Fund (1993)
Wilstock Fund (1994)
Evelyn G. Zamboni Fund (1986)
Madeline & Sanford S. Zevon Fund (1995)

*Created in 2003



Martin J. G. Glynn, Chairman,
Trustees' Committee

TRUSTEE BANKS

In 1923, the banks of New York City envisioned the type of philanthropic organization that could best meet the changing needs of this community.

It would be set up to give wealthy people and those of moderate means an equal opportunity to accomplish their philanthropy within a flexible framework. The charitable funds they created would be permanently secure. The organization's governing body—an impartial and changing committee of New York citizens chosen for their understanding of philanthropic needs—would oversee the selection of charitable beneficiaries.

This was the beginning of The New York Community Trust. Thirteen banks and trust companies have adopted the "Resolution and Declaration of Trust Creating *The New York Community Trust*." The representatives of these financial institutions constitute the Trustees' Committee, and each bank is authorized to receive funds in trust for The New York Community Trust.

TRUSTEE BANKS

The Bank of New York

Thomas A. Renyi, Chairman & CEO
Alternate: John S. Lipori, Executive Vice President

Bessemer Trust Company, N.A.

John A. Hilton, Jr., President & CEO
Alternate: William H. Forsyth, Jr., Managing Director & Senior Fiduciary Counsel

Brown Brothers Harriman Trust Company

Donald B. Murphy, Chairman & CEO
Alternate: William H. Mears, Jr., Executive Vice President

Citibank, N.A.

Charles Prince, Chief Executive Officer—Citigroup Inc.
Alternate: Edward J. Orazem, Chief Executive Officer, Citigroup Trust

Deutsche Bank Americas

Seth Waugh, Chief Executive Officer
Alternate: Paul Bisset, Managing Director, Deutsche Bank Trust Company, New York

Fiduciary Trust Company International

Anne M. Tatlock, Chief Executive Officer
Alternate: Gail E. Cohen, Esq., Senior Vice President & Chief Trust Counsel

Fleet National Bank

Brian Moynihan, Executive Vice President
Alternate: Leon Wilson, Charitable Asset Division

HSBC Bank USA

Martin J. G. Glynn, President & CEO
Alternate: Gerard F. Joyce, Jr., Senior Vice President

Merrill Lynch Trust Company, FSB

Christian G. Heilmann, Chairman & CEO
Alternate: David Ratcliffe, Senior Vice President

JP Morgan Chase Bank

William B. Harrison, Jr., Chairman & CEO
Alternate: Paula M. Baker, Managing Director

Neuberger Berman Trust Company

Jeffrey S. Maurer, Chairman & CEO
Alternate: Diane E. Lederman, Senior Vice President, Chief Fiduciary Counsel & General Counsel

The Rockefeller Trust Company

Elizabeth P. Munson, President
Alternate: James M. Mulvaney, Senior Vice President

United States Trust Company of New York

Alan J. Weber, Chairman & CEO
Alternate: Paul K. Napoli, Executive Vice President

STAFF OF THE TRUST

Office of the President

Lorie A. Slutsky, <i>President</i>	Ext. 257
Elba Linares Griffin, <i>Assistant to President</i>	235
James R. Dumpson, Ph.D., <i>Senior Consultant</i>	253
Ani F. Hurwitz, <i>Director of Communications</i>	224
Kim Irwin, <i>Communications Assistant</i>	234
Anne Backman, <i>Consultant, Publications</i>	

Office of the General Counsel

Jane L. Wilton, <i>General Counsel</i>	379
Stephen E. MacDowell, <i>Executive Assistant</i>	322

Donor Relations

Robert V. Edgar, <i>Vice President</i>	373
Gay Young, <i>Director, Donor Relations</i>	377
Joan Reedy, <i>Executive Assistant</i>	353
Janet Hollander, <i>Grants Investigator</i>	535
Anne M. Nally, <i>Grants Administrator</i>	301

Finance & Investment

Kit Conroy, <i>Chief Financial Officer</i>	424
Mary Greenebaum, <i>Chief Investment Officer</i>	464
Heidi Hotzler, <i>Controller</i>	444
Yahaira Ortiz, <i>Accountant</i>	429
Lora Rhames-Davis, <i>Accountant</i>	476
Raymond P. Salibur, <i>Investment Administrator</i>	455
Wen Weng, <i>Senior Accountant</i>	499
Khalil Ali, <i>Intern</i>	463

Administration

Mercedes M. Leon, <i>Vice President</i>	265
Ayanna Russell, <i>Administrative Assistant</i>	227
Elizabeth Dixon, <i>Office Manager</i>	433
Catherine Johnson, <i>Administrative Assistant</i>	276
Evelyn Shapero, <i>Receptionist</i>	0
Tilackdharry Shievkumar, <i>Office Assistant</i>	667
Tonia Smallwood, <i>Records Assistant</i>	636

Grants and Special Projects

Joyce M. Bove, <i>Senior Vice President</i>	552
Judith Lopez, <i>Executive Assistant</i>	554

Children, Youth & Families

Roderick V. Jenkins, <i>Program Officer</i>	527
Patricia A. White, <i>Senior Program Officer</i>	579

Community Development & the Environment

Patricia Jenny, <i>Program Director</i>	201
Patricia Swann, <i>Program Officer</i>	530
Nioka S. Young, <i>Program Officer</i>	575

Education, Arts & the Humanities

Leah M. Krauss, <i>Program Officer</i>	520
Jane R. Stern, <i>Program Director</i>	557

Health & People with Special Needs

Irfan Hasan, <i>Program Officer</i>	573
Len McNally, <i>Program Director</i>	556

Nancy DeKoven, <i>Administrative Assistant</i>	525
Sheila Dinkins, <i>Administrative Assistant</i>	553
Laurette Gresler, <i>Executive Assistant</i>	555
Liza Lagunoff, <i>Grants Administrator</i>	255

AFFILIATES

Long Island Community Foundation (516) 681-5085	
Suzy D. Sonenberg, <i>Executive</i>	223
Wini Freund, <i>Director of Donor Services</i>	230
Hazel Weiser, <i>Director of Foundation Advancement</i>	226
Darren R. Sandow, <i>Program Director</i>	232
Lynda Parmely, <i>Program Associate</i>	233
Nancy Arnold, <i>Grants Administrator</i>	235
Janice Somer, <i>Officer Administrator</i>	220

Westchester Community Foundation (914) 948-5166	
Catherine Marsh, <i>Executive</i>	23
Gudrun Cancian, <i>Executive Assistant</i>	21
Gail Goodman, <i>Assistant Director</i>	27
Abby Smith, <i>Coordinator of Advancement & Communications</i>	26
Julie McCrady, <i>After School Programs</i>	24

FUNDS AND GRANTS IN 2003



THE NEW YORK COMMUNITY TRUST
COMMUNITY FUNDS, INC.

A

- Janice E. Abbott Scholarship Fund (1999)
*Abdalla Stern Fund (2003)
Jane Schwab Abel & Elise Schwab Clemenger Memorial (1946)
Jan & Stefan Abrams Fund (1997)
A.B.Y. Fund (1960)
Ackman Family Fund (1997)
Hall Adams Fund (1972)
Adel & Leffler Families' Fund for Queens (1993)
Frederica M. & Morton L. Adler Trust (1941)
Adopt-a-Monument Fund (1987)
M. Bernard Aidinoff Fund (1986)
M. Bernard Aidinoff & Elsie V. Aidinoff Fund (1998)
Seth G. Aidinoff Fund (1986)
Akabas Family Fund (1986)
Albin Family Arts Fund (1999)
Barbara Albisser Memorial Fund (1981)
Oakey L. & Ethel Witherspoon Alexander Fund (1977)
Alexandra Fund (1970)
Allegra-Tanner Fund (1995)
Robert Mack Allen & Wendel Fentress Ott Fund (1989)
AllianceBernstein Foundation Fund (1998)
AllianceBernstein Uniformed Officers Education Fund (2001)
Franz & Marcia Allina Fund (1994)
Alouette Fund (1993)
B. Altman Fund (1985)
Altschul Family Fund (1980)
Arthur Altschul Memorial Fund (2002)
Arthur G. Altschul, Jr. Charitable Fund (1996)
Altschul Overbrook Fund (1994)
Emily H. Altschul Charitable Fund (2002)
Elizabeth & Peter Altwater Fund (1974)
American Seamen's Friend Society Designated Fund (1986)
American Seamen's Friend Society Discretionary Fund (1986)
Ananour Fund (1998)
*Anbinder Family Charitable Fund (2003)
J. R. Anderson Fund (1981)
Eileen & William Araskog Charitable Fund (2001)
Arc of Circumstance Fund (1978)
G.W. Archer Fund (2001)
Joseph Arena Charitable Fund (1995)
Walter & Marsha Arnheim Fund (1986)
Esther Jean Arnhold Fund (1966)
Arundel Fund (1988)
Marcia Ashman Fund for Children (1999)
Robert R. Asiel Memorial Funds (1972)
Astor Fund for Public School Libraries (1997)
Auburn Citizen Fund (1999)
- B**
The B Fund (1990)
Babbitt Family Fund (1990)
Babsan Fund (1992)
William M. Backer Fund (1985)
Backman-Niesz Fund (1999)
Isabelle Bacon Fund (1985)
- Baer Family Fund (1989)
Ellen & Henry Baer Fund (1986)
Honorable & Mrs. Harold Baer Fund (1989)
Lee Bailey Fund (1991)
S. Prentiss Bailey Fund (1960)
Peter L. Bain Fund (1991)
Baird Family Fund (1987)
*Baker Family Fund (2003)
Allyson Maya Collazo Baker Fund (1984)
Linda J. Baldwin Fund (1996)
Fern Ann Ballard Memorial Fund (1986)
Dr. Holly M. Bannister & Douglas L. Newhouse Fund (1984)
Pelleg S. Barber Fund (1960)
Ruth Plofsky Barish & Irving Barish Fund (1996)
Barns Fund (1971)
Parker W. Barnum Fund (1979)
William & Francoise Barstow Foundation No. 1 (1931)
William & Francoise Barstow Foundation No. 2 (1959)
Christopher S. Bartels Fund (1998)
Katherine N. Bartels Fund (1998)
McDonald C. Bartels Fund (1998)
Todd C. Bartels Fund (1998)
Harriett M. Bartlett Funds (1987)
Arthur L. Baruch & Rosalie K. Baruch Fund (1979)
Baudo-Sillerman Scholarship Fund (1989)
BBDO Minority Education & Training Fund (2000)
Alice D. Beal Trust (1955)
Raymond R. Beatty Scholarship in Memory of Andrew Wilson (1984)
Bernadine Becker Commemorative Trust (1984)
Ruth Bedford Fund (1963)
Beech Fund (1975)
David Bell Fund (1998)
Bellevue Nursing Committee Fund (1976)
Eleanor Robson Belmont Fund (1980)
Lillian Z. Bender Fund (2002)
Claire B. & Lawrence A. Benenson Fund (1987)
Herbert & Edythe F. Benjamin Fund (1976)
Andrew N. & Gail D. Berg Fund (1999)
Daniel Bergstein Memorial Scholarship Fund (2002)
Berkshire Fund (2000)
Viola W. Bernard Fund for Psychosocial Health (1993)
T. Roland Berner Fund (1972)
Charles L. Bernheimer Fund (1974)
Theresa E. Bernholz Fund (1924)
Sylvia Bernstein Fund (1994)
Richard Case Berresford Fund (1997)
William H. Berri Funds (1966)
Frank Besau & Pauline Besau Wamsganz Fund (1995)
Bessemer National Gift Fund at The New York Community Trust (1999)
Betlor Foundation (1978)
Beverly Hills Fund (1972)
BGM Fund (1971)
K. M. Bialo Family Fund (1986)
June R. & Jonathan Bingham Fund (1980)
Henry Birnbaum Fund (2000)
Gladys A. Bishop Memorial Fund (1987)
Anne & Walter C. Bladstrom Philanthropic Fund (1988)
Richard & Margaret Blanchard Fund (1983)

*Nancy & Robert S. Blank Fund (2003)
 E.H.R. & N.M. Blitzler Fund (1984)
 Lida & David Bloom Fund (1989)
 Robin Bloom Fund (1991)
 Blum Family Fund (1990)
 Sidney & Elaine Blumenthal Fund (1980)
 Jesse Smith Blydenburgh & Josephine Vail Blydenburgh Fund (1958)
 Ernst P. Boas Memorial Fund (1955)
 Alice Boerner Fund (1988)
 Bohemia Fund (1971)
 Bolin Fund (1986)
 Peter A. Bonanni Scholarship Fund (1996)
 M. Alida Bonyng Memorial Fund (1940)
 Lillian G. Booth Fund (1976)
 Janet & James Bostany Memorial Fund (1999)
 Charles Bouman Charitable Trust (1977)
 Bove Fund (1986)
 John Perry Bowditch Memorial Fund (1956)
 Clothilde de Veze Bower Fund (1989)
 *Philip & Suzanne Bowers Charitable Contribution Fund (2003)
 George T. & Francele Boyer Fund (1976)
 Bradford Fund (1986)
 William B. & Jane Eisner Bram Fund (1995)
 William M. Bramwell, Jr. Fund (1995)
 Brause Fund (1986)
 Barry & Geraldine Brause Fund (1986)
 R. S. Brause Fund (1986)
 Roberta Brause Fund (1986)
 Catherine & Robert Brawer Fund (1996)
 Annie Grant Breath Memorial Fund (1939)
 Lyn Brillo & Mark Sonnino Fund (1997)
 *Brivio Family Fund (2003)
 Beatrice & Douglas Broadwater Fund (1986)
 Edward Brodsky Fund (1997)
 Ann Loeb Bronfman Fund (1995)
 Brooklyn Fireman's Medal Fund (1981)
 Dee & Dickson G. Brown Fund (1986)
 Adon H. Brownell Memorial Fund (1985)
 Browning Fund (1998)
 Edward W. Browning Fund No. 2 (1969)
 Brownstein Family Fund (1995)
 Betty E. Brugger Fund (1986)
 William H. & George R. Brunjes Memorial Fund (1988)
 Barry R. Bryan Fund (1986)
 May Evans Bryant Fund (1989)
 BTW Fund (1973)
 Emily G. Buck Fund (1994)
 Alexandru & Sonia Bunesu Fund (1993)
 Walter & Martha Burchard Family Fund (1988)
 Richard A. Burgheim Fund (1999)
 William H. Burkhart Fund (1960)
 *Burks Family Fund (2003)
 John U. & Minnie M. Burt Inter Vivos Fund (1974)
 John U. & Minnie M. Burt Testamentary Funds (1974)
 *Ernest Brooks Burton Fund (2003)
 William B. Butz Memorial Fund (1999)
 Patrolman Edward R. Byrne Substance Abuse Fund (1988)
 Monsignor Harry J. Byrne Scholarship Fund (1998)

C

Jean C. Caldwell Fund (1950)
 Patricia A. Caldwell Fund (2002)
 John Calicchio Fund (1983)
 Douglas Campbell, Jr. Fund (1984)
 Frances T. Campbell Fund (1959)
 Cannon Educational Fund (1981)
 Charlotte Ruby Cantor Fund (1999)
 Ralph & Stella Caporale Fund (1995)
 Carey Family Fund (1995)
 Carillon Fund (1998)
 Carlson Fund (1994)
 Fred G. Carlson Fund (1995)
 Carnegie Corporation Fund No. 1 (1936)
 Carnegie Corporation Fund No. 2 (1936)
 Carolina Fund (1986)
 Alys Sinclair Carreau Memorial Fund (1929)

Carson Family Charitable Trust Fund (1985)
 Sybil Carter Memorial (1930)
 Cashin Family Fund (1989)
 Bonnie Cashin Fund (2002)
 Douglas Caterfino Fund for Brain Tumor Research (2001)
 Cecelia Trust Fund (1996)
 Ronald & Carole Chaimowitz Fund (1995)
 David & Miriam Chalfin Fund (1985)
 Chapman Fund (2000)
 Charlie Company Scholarship Fund (1985)
 Charlie's Fund (1975)
 *Chart 888 Fund (2003)
 Gerald L. Chasin Fund (1986)
 Richard & Ellen Chassin Charitable Fund (2000)
 Chatham Fund (1984)
 Patrick S. Cheng & Michael J. Boothroyd Fund (2000)
 Herbert & Phyllis Chernin Fund (1996)
 Marjorie F. Chester Fund (1999)
 Children's Fund (1995)
 Christiansen/Shuchman Fund (1987)
 Francis & Catherine Christy Fund (1975)
 Clark Family Fund (2000)
 Cameron Clark Memorial Fund (1998)
 Edith M. Clark Fund (1944)
 Fenton Clark Fund (1986)
 Valerie G. Clark Memorial Fund (1978)
 *Clarke-Kammerer Family Fund (2003)
 Kevin Cleary Memorial Fund (2001)
 Cline Foundation Fund (1995)
 Clinton Community Garden Fund (1985)
 *Harlan Coben & Anne Armstrong-Coben MD Fund (2003)
 Coco Fund (2000)
 Charles I. & Ellen F. Cogut Fund (1995)
 Helen Cohen Fund (1995)
 Lisa E. Cohen Memorial Scholarship Award Fund (1991)
 Susan B. Cohen Fund (1998)
 Cole Family Foundation Fund (1999)
 Kenneth Cole Fund (1986)
 John & Ann Coleman Fund (1984)
 Warren Coleman Fund (1986)
 Irene D. Colli Trust (1980)
 Columbus Circle Fund (1976)
 Composers Fund (1987)
 Georgianna B. Conlin Fund (1998)
 Kevin P. Connors Fund (1986)
 Conroy Family Fund (1999)
 Cook Family Fund (1986)
 Lane Cooper Fund (1960)
 Copper Beech Fund (1979)
 Candice Coram Memorial Fund (1996)
 Gertrude Corbitt Bequest (1959)
 Barbara Fatt Costikyan Fund (1999)
 Melinda & James M. Cotter Fund (1986)
 Counterpoint Fund (1996)
 Charlotte L. Crittenden Fund (1932)
 A. Evelyn Cronquist Fund (1991)
 William & Sally Cross Charitable Fund (2001)
 Winifred Crost Fund (1981)
 Charles E. Culpeper Fund (1999)
 Cumulus Fund (1992)
 *Cushman Family Fund (2003)
 Paul & Paulette Cushman Fund (1998)

D

John Da Silva Memorial Fund No. 1 (1988)
 John Da Silva Memorial Fund No. 2 (1988)
 John Da Silva Memorial Fund No. 3 (1988)
 Abraham L. Danziger Fund (1979)
 Danziger Family Fund (1973)
 Ellen & Sabin Danziger Fund (1997)
 Darlington Fund (1973)
 Elizabeth B. Dater & Wm. Mitchell Jennings, Jr. Fund (1999)
 Davin Family Fund (1995)
 Davis Polk & Wardwell Fund (1997)
 Davis Polk & Wardwell Fund for Children (2001)
 Donna Scher Davis Fund No. 1 (1993)

Donna Scher Davis Fund No. 2 (1996)
 Day Memorial Fund (1948)
 Eugenia Ortuno de Bartels Fund (2002)
 G. Louise Robinson de Dombrowski Fund (1991)
 Georgia & Michael de Havenon Fund (1986)
 *De Lizio Family Charitable Fund (2003)
 Peter J. De Luca Family Fund (1991)
 Georges & Lois de Menil Charitable Fund (1977)
 Ellen A. Dearborn Fund (1969)
 *DeBell Charitable Fund (2003)
 *David & Diane DeBell Family Fund (2003)
 *Margaret DeBell Fund (2003)
 Richard & Barbara Debs Fund (1986)
 Deerdodds Fund (1997)
 Defliese Family Fund (1971)
 George Delacorte Center for Magazine Journalism Fund (1998)
 George Delacorte Fund (1994)
 Valerie Delacorte Fund (1993)
 Delafield Fund (1975)
 Delany Sisters Fund (1994)
 R. G. Dell Fund (1997)
 Denning/Bowman Fund (1986)
 Derby Fund (1983)
 Brian & Silvija Devine Fund (1986)
 J. Hugh & Nancy Devlin Fund (1986)
 Mary Wheeler Dewart Fund (1976)
 *Diacre Family Fund (2003)
 Hester Diamond Fund (2002)
 Robert S. & Susan A. Diamond Fund (1986)
 DiBlasi Fund (2000)
 Esther Baiyla Dinner Memorial Fund (1999)
 *William & Linda Doescher Charitable Fund (2003)
 Dogwood Fund (1979)
 Eugene, Bridget & Tommy Dolphin Scholarship Fund (1992)
 Susan Wells Donnell Fund (1984)
 William W. Donnell Fund (1994)
 *William W. Donnell Fund for Parks (2003)
 A. James Donohue Fund (1986)
 Donors' Education Collaborative of New York City Fund (1992)
 Dora Fund (2001)
 Mr. & Mrs. Stephen M. Dovicz Fund (1994)
 John & Hebe Dowling Fund (1986)
 Nancy A. Downey Fund (1980)
 Robert N. Downey Fund (1977)
 Nathan & Miriam Drachman Fund (1989)
 *W. Christopher Draper Fund (2003)
 Bruce Dresner Fund (1993)
 Leon Drew Fund (2001)
 Drexel Burnham Lambert Fund (1995)
 Dreyfus Charitable Fund (2001)
 Beatrice L. Drossman Fund (1998)
 Michael & Andrea Dubroff Charitable Fund (1996)
 James R. Dumpson Fund (1999)
 William M. Duncan Family Fund (1986)
 T. J. Dermot Dunphy Fund (1984)
 Dutch Kills Civic Association Fund (1994)
 Solomon Dutka Fund (1999)

E

East Harlem Tutorial Program Fund (1997)
 Evelyn & Jack Eber Fund (1995)
 Ebisu Fund (1993)
 E.C.B. Fund (1960)
 Economic Justice Fund (1989)
 Julius & Margarete Edelstein Fund (1991)
 Edlow Fund (1996)
 Eleanor Franklin Egan Memorial Fund (1927)
 E.H.C. Foundation (1967)
 Tiby & Arthur Eilen Charity Fund (2000)
 Dr. Moses Einhorn Fund (1964)
 Einhorn/Lasky Family Fund (1999)
 *Eiseman Altschuler Fund (2003)
 Irving & Blanche Eisenberg Charitable Fund (1995)
 Carole & Richard Eisner Fund (1980)
 Claudio Elia Fund (1997)
 Dr. Deborah Elkins Fund (1993)

Gertrude Elkins Memorial Fund (1993)
 *Howard L. Ellin Charitable Fund (2003)
 ELSAM Fund (1999)
 Lita & Walter Elvers/Zipperian Fund (1999)
 Henry C. Enders Funds (1976)
 Mildred F. Englander Fund (1985)
 Enos Fund (1983)
 Samuel Epstein Lecture Fund (1999)
 Josephine L. Erwin Fund (1935)
 Essex Associates Fund (1986)
 James A. Essey & Nina Zakin Essey Fund (1994)
 Evans Family Fund (1995)
 Bradford & Barbara Evans Fund (1986)
 Everett Philanthropic Fund (1986)

F

Fahnestock Family Fund (1980)
 Fahs-Beck Fund for Research & Experimentation (1986)
 Fahs-Beck Fund II for Research & Experimentation (1993)
 Edgar W.B. Fairchild Fund (1992)
 Fairway Fund (1987)
 Falk, Lichten & Rosenstein Fund (1995)
 David Falk Memorial Fund (1989)
 Susan Meyers Falk Fund (1996)
 Joseph Fancher Fund (1983)
 Farrand Family Fund (1993)
 Faunsdale Fund (1986)
 Mary S. Fearey Fund (1986)
 Emanuel & Bertha Feder Memorial Fund (1994)
 Federal Bar Council/U.S. Attorneys' Offices Fund (2001)
 Robert B. Feduniak Fund (1986)
 Garth Erin Feeney Fund (2001)
 Sidney Feiner Memorial Fund (1997)
 Feinsod Herz Fund (1980)
 Feldman Family Fund (1982)
 Louise & Marvin Fenster Family Fund (1999)
 Fernleigh Fund (1995)
 *FH Memorial Fund (2003)
 Anthony & Vanda Ficalora Fund (1988)
 Judith & Norman Fields Fund (1992)
 Raymond H. Fiero Fund (1984)
 Brian Keith Fifield Memorial Scholarship Fund (1987)
 Filak Family Fund (1999)
 Simon Finck Fund (1959)
 Golda & Mollie Fine Fund (1977)
 First Flight Fund (1988)
 Laura & Michael G. Fisch Fund (1999)
 Fishbein Family Fund (1998)
 Mitchell S. Fishman Donor-Advised Fund (1999)
 Robert B. Fiske, Jr. U.S. Attorneys Fellowship Fund (1987)
 Desmond Gerald FitzGerald Charitable Fund (1986)
 Kirsten Flagstad Memorial (1964)
 William E. Flaherty Family Fund (1998)
 Sam Flax Memorial Scholarship Fund (1964)
 Fletcher Fund (1999)
 Elizabeth H. & Irvine D. Flinn Fund (1999)
 Josephine Flood Memorial (1950)
 *Florence & Herbert Memorial Fund (2003)
 Francis Florio Funds (1974)
 Flushing Females Association Scholarship Fund (1992)
 Michel Fokine Memorial Fund (1985)
 Charlotte & William E. Ford Fund (1996)
 Walter B. Ford Funds (1972)
 Fortune Society Education Fund (1994)
 Fosdick Fund (1986)
 David Foster & Mina Samuels Fund (1997)
 John H. Foster Fund (1984)
 Ben Fox Memorial Fund (1962)
 Ellen Fox Family Fund (1994)
 Adam Frand Fund (1998)
 Frank Fund (1995)
 Abraham B. & Sarah Frank Funds (1955)
 Martin M. Frank Scholarship Fund (1990)
 Thomas W. & Claire W. Frank Fund (1977)
 Ben & Phyllis Frankel Fund (1986)
 Corinne R. Frear Fund (2000)

David Freedman Fund (1994)
 Robert & Linda Friedman Family Fund (1995)
 Friends of New York Downtown Hospital Health Sciences
 Scholarship (1996)
 Fuld Family Fund (1991)
 Kenneth & Margo Fuld Fund (2001)
 Fuller Fund (1986)
 Fun On 2 Wheels Fund (1998)
 Fund for Autistic Children (2000)
 Fund for the Delacorte Theatre in Central Park (1998)
 Fund for Fiorello H. LaGuardia High School of Music & Arts (1983)
 Fund for the Needy (1983)
 Fund for New Citizens (1987)
 Fund for Performances at the Delacorte Theatre in Central Park
 (1999)
 Future of Design Jewelry Education Fund (1997)

G

Laly & George Gallantz Fund (1991)
 *Gallogly Strickler Family Fund (2003)
 Donald R. Gant Fund (1979)
 *Gardner Family Fund (2003)
 William T. Gardner Theatre Internship Fund (1992)
 Gloria & Barry H. Garfinkel Fund (1986)
 Barbara Gauntlett Scholarship Fund (1986)
 Paul Edward Gay Fund (1990)
 Geduld Fund (1993)
 Victoria & E.E. Geduld 'Starworks' Fund (1995)
 Bruce S. Gelb Fund (1995)
 Richard L. Gelb Fund (1995)
 Gellert Family Fund (1995)
 Gemini Fund (1998)
 General Charitable Fund (1971)
 Ruth E. & Timothy M. George Charitable Fund (1986)
 Jacques A. Gerard Fund (1987)
 Pierce Gerety Memorial Fund (1998)
 Gertz Foundation Fund (1971)
 Clara A. Gierisch Fund (1975)
 John N. & Gillett A. Gilbert Family Fund (1999)
 *Nancy & Lloyd Gilbert Fund (2003)
 Elena Gildersleeve Fund (1982)
 Frank J. Gillespie Fund (1985)
 Deane A./John D. Gilliam Fund (1996)
 Gilmore Human Rights Fund (1980)
 Sonia Raiziss Giop Literature Fund (1994)
 Santina Giordano Memorial Fund (1985)
 Glaser Family Fund (1994)
 Robert J. Glenn Memorial Fund (1974)
 Rose N. Glenn Memorial Fund (1990)
 Danny Glick Memorial Scholarship Fund (2001)
 Gloria Fund (1981)
 Madeline Shobry's Glisten Fund (1999)
 Hazel K. Goddess Fund for Stroke Research in Women (2000)
 *Goins Family Fund (2003)
 Steven & Jan Golann Fund (1998)
 Rita & Herbert Z. Gold Education Fund (1993)
 Gold-Schiff Fund (1994)
 Golden Family Fund (1992)
 Goldman Sachs Fund (1970)
 Jack Goldring Fund (1986)
 Alice & Stanley Goldstein Fund (1997)
 Eric L. Goldstein Fund (1999)
 Patricia & Bernard Goldstein Fund (1985)
 Good Friends Fund (2000)
 Good Samaritan Fund (1993)
 Maurice & Georgine Goodman Fund (1998)
 Roger & JoAnn Goodspeed Fund (1986)
 Goodwin Family Fund (1999)
 Everett F. & Ann P. Gordon Memorial Fund (1991)
 Gail Gordon Fund (2000)
 William J. Gossen Fund (1985)
 Josh Gotbaum & Joyce Thornhill Fund (1991)
 Gouverneur Hospital Fund (1958)
 Eugen Grabscheid Fund (1992)
 Howard E. Grace Fund (1998)
 Joan P. Grano Memorial Fund (1996)
 Maggie & Gordon Gray Family Fund (1998)

Green Fund (1985)
 Orland S. & Frances S. Greene Fund (1962)
 Greenebaum Fund (1984)
 John Robert Gregg Fund (1985)
 J & J Gribetz Fund (1983)
 Linda A. Griffith Fund (1970)
 Arthur Griggs Fund (1947)
 Emily Griggs Fund (1944)
 *Gross Family Fund (2003)
 W. R. Gruver Fund (1986)
 Rudolph Guenther Fund (1977)
 Sydney A. Guggenheimer Memorial Fund (1949)
 Gunn Family Fund (1999)
 Lucille Gutman Trust (1984)

H

H2O Fund (1998)
 Haas Foundation Fund (2000)
 Leopold Haas Fund (1984)
 Katherine & Morris Hadley Trust (1968)
 Horace & Amy Hagedorn Fund (1995)
 Emil & Zerline Hahnloser-Richard Bak Fund (1975)
 Hajim Family Fund (1983)
 James F. Haley Memorial Fund (1983)
 Luke Halpin Memorial Scholarship Fund (2002)
 *Carol D. & S. Sutton Hamilton Charitable Fund (2003)
 *Mike Handy Memorial Fund (2003)
 Lola G. Hanna Fund (1995)
 Gwenda & John Hanson Fund (1986)
 Lee Hanson & Don Scherer Fund (1986)
 Harbor Watch Fund (2000)
 William Barclay Harding Fund (1979)
 Augusta Lehman Harlem & Lillian Harlem Martin Fund (2000)
 Harmony Fund (1986)
 Elisabeth Scott Harms Fund (1982)
 James W. Harpel Fund (1983)
 *Jon Harrington Fund (2003)
 Harris Family Fund (1992)
 Charlotte Daniels Harris Memorial Fund (2002)
 Elsie & Chelsea Harris Memorial Fund (1996)
 *Jeff & Judy Harris Fund (2003)
 Katharine S. Harris Trust Fund (1965)
 William Harris Fund (2000)
 Hastings Peace & Justice Fund (1993)
 Haupt Family Fund (2000)
 Harry & Eugenie Havemeyer Fund (2001)
 Hawk's Nest Fund (2000)
 Hawthorne Lane Fund (1986)
 Hayes Family Fund (1996)
 Ralph Hayes Memorial Fund (1968)
 Health & AIDS Education Fund (1991)
 Thomas Healy & Fred P. Hochberg Fund #1 (1995)
 Thomas Healy & Fred P. Hochberg Fund #2 (1995)
 *Thomas P. Healy Fund (2003)
 Nicholas C. Heaney Memorial Fund (1997)
 Stella & Howard A. Heffron Fund (1998)
 Heiser Grant (1972)
 Hemangioma Education & Research Fund (1994)
 Hemlocks Fund (1978)
 Mercedes R. Henderson Memorial Fund (1996)
 Paul & Ann Henegan Fund (1986)
 *Ruth Hennig Fund (2003)
 Lucy Henning Memorial Fund (1995)
 Lucy & George Henning Fund (1974)
 Alexander S. Henry, Sr. & Ann S. Henry Memorial Fund A (1989)
 Alexander S. Henry, Sr. & Ann S. Henry Memorial Fund B (1995)
 Doris & Milton Hepner Fund (2000)
 Herbster Family Fund (1990)
 Jane R. & Andrew L. Herz Fund for Criminal Justice (1986)
 Betty L. Hess Fund (1980)
 Don & Marilyn Berger Hewitt Fund (1998)
 Leo & Ethel Heymann Memorial Fund (1954)
 Jack D. Hidary Fund (1998)
 Murray Hidary Fund (1998)
 High Exposure Fund (1993)
 High School of Commerce, Class of 1911 Scholarship Fund (1967)

Hintz Family Fund (1991)
 Hirsch Fund (1986)
 Peter M. Hirsch Memorial for Thyroid Cancer Research Fund (2001)
 Steven Hirsch Fund D (1973)
 Steven J. Hirsch Fund (2002)
 Susan Hirschman Fund (1999)
 Martin Hirschorn IAC Fund (1995)
 Margaret M. Hitchcock Fund (1946)
 *Ho/Ching Charitable Fund (2003)
 Mary & David Hoar Trust for the Honor & Glory of God (1975)
 Rita & Irwin Hochberg Charitable Fund (1982)
 Hodgson Fund (1995)
 John J. Hoffee Fund (1996)
 *Jane & Michael Hoffman Charitable Gift Fund (2003)
 Gloria & Joel S. Hoffman Fund (2001)
 Marion O. & Maximilian E. Hoffman Fund (1984)
 Lillian & William Hoffmanns Fund (1990)
 Sharon King Hoge Fund (2000)
 Holmen Family Fund (2002)
 Britt Holmen Family Fund (2002)
 Mark Holmen Family Fund (2002)
 Robert C. Holmen Family Fund (2002)
 Homeless Outreach & Assistance Fund (1997)
 Horing Family Fund (2001)
 Saul Horowitz, Jr. Fund (1999)
 Katie Danziger Horowitz & Steven G. Horowitz Family Fund (1995)
 John & Sandra Horvitz Fund (1996)
 Norris Houghton Theatre Fund (1988)
 Allan Houston Charitable Fund (2001)
 HRA Fund for Children & Families (1987)
 HSN Firefighters & Police Officers Family Fund (2001)
 Ralph N. Hubbard Fund (1948)
 Doctor Joseph E. Hughes Scholarship Fund (1984)
 Margaret J. Hughes Memorial Fund (1990)
 *W. Ockham Hume Fund (2003)
 *Mildred K. Hurson Fund (2003)
 Glenn & Deborah Dow Hutchins Fund (1993)
 Rene K. & Samuel M. Hyman Memorial Fund (1978)

I

I Get Fund (1991)
 Charles F. Ikle Scholarship & Research Funds (1965)
 Indian Mountain School Fund (1993)
 George A. Ingalls & Ann C. Ingalls Fund (1957)
 Ingraham Fund (1986)
 Innovative Design Fund (1988)
 Intrepid Fund (1976)
 Paul J. Isaac Fund (1981)
 Iseman Eleemosynary Fund (1999)
 Island Fund (1975)
 Isabel C. & Walter T. Iverson Fund (1986)

J

J B Fund (1985)
 Jackson Fabrics Associates Fund (1986)
 Frederick Jacobi Memorial (1952)
 Jaffe Education Fund (1995)
 Cyril D. & Elena Jalon Fund (1986)
 Jamaica Fund (1989)
 Lucy Wortham James Fund (1935)
 Lucy Wortham James Memorial (1939)
 Walter B. James Fund No. 1 (1927)
 Walter B. James Fund No. 2 (1927)
 Jamestown Fund (1990)
 Jeanne d'Arc Foundation (1927)
 JEHT Fund (1999)
 Jenny-Hiteshew Fund (1994)
 Elise Jerard Environmental & Humanitarian Trust (1981)
 JM Legacy Fund (2000)
 *Laura & Ray Johnson Fund (2003)
 Harry J. & Teresa H. Johnson Graduate Scholarship Fund (1987)
 Harry J. & Teresa H. Johnson Scholarship Fund (1983)
 Harry J. & Teresa H. Johnson Scholarship Fund No. 2 (1985)
 Jophed/Thomas Fund (1975)

K

Annette Kade Fund (1994)
 KAL 007 Victims Memorial Fund (1988)
 Michael Kalil Foundation Fund (1992)
 Marion & Irwin Kaplan Fund (1986)
 Seth & Barbara Lewis Kaplan Fund (1998)
 Susan Grant Kaplansky Fund (2001)
 Barbara & William Karatz Fund (1986)
 Karlisle Fund (1999)
 Hagop, Arousiag & Arpy Kashmanian Scholarship Fund (1999)
 Leander & Helen Katsidhe Fund (1999)
 Judy Katz/Oren Rudavsky Fund (1996)
 Dr. Martin R. Katz Fund for Culinary Arts (1988)
 Jeffrey & Carol Kaufman Fund (2000)
 Robert M. Kaufman Fund (1988)
 Robert M. Kaufman Fund No. 2 (2002)
 Marion Esser Kaufmann Fund (1985)
 Walter & Selma Kaye Fund (1994)
 Paul Kazanoff Memorial Fund (1998)
 Hamilton F. Kean Fund (1985)
 Robert Prior Kehoe Fund (1974)
 Richard Keim Family Fund (1983)
 William Wilson Kelchner Memorial Fund (1972)
 Jane & Donald Seymour Kelley Fund (1997)
 Peter L. Kellner Fund (1986)
 Kelner Family Fund (1996)
 Carl & Doris Kempner Fund (1996)
 Michael C. Kempner Fund (1997)
 Kenilworth Fund (1970)
 Friends of Jim Keresev Fund (2001)
 Kerlin Fund (2001)
 Ellen Kheel & Arnold S. Jacobs Fund (1998)
 King Family Fund (2000)
 Harold Thomas King, Jr. & Lisbeth King Fund (1986)
 Kira Fund (1992)
 Joseph M. Kirchheimer Fund (1989)
 John H. Kirst Memorial Fund (1999)
 Susan B. & Donald M. Kitchen Fund (1989)
 Casey Kizziah Fund (1994)
 Andrew Bradford Klein Fund (2001)
 John C. Klein Trust (1981)
 Sharon Klein Memorial Fund (2002)
 Ted Klein Fund (2000)
 Morris Kligman Memorial Fund (2000)
 Jane & Richard Koch Fund (1987)
 Mary Conway Kohler Fund (1986)
 Korda Fund (1990)
 Dr. Joseph M. & Grace Koreen Micha Scholarship Fund, Israel (1986)
 William A. Koshland Fund (1987)
 *John C. Koster Fund (2003)
 *Kozukai Fund (2003)
 Henry Phillip Kraft Family Memorial Fund (1996)
 *Sydney & Marjory Krause Fund A (2003)
 *Sydney & Marjory Krause Fund B (2003)
 *Sydney & Marjory Krause Fund C (2003)
 Michael & Patricia Kraynak Fund (1986)
 Charlotte & Stanley Kriegel Fund (1997)
 Susan J. Kropf Fund (2002)
 Wheaton B. Kunhardt Fund (1949)

L

Laboratory of Dermatopathology Charitable Fund (1997)
 *Lachance Family Charitable Fund (2003)
 Ann D. & John W. Laibe Fund (1994)
 Benjamin V. & Linda L. Lambert Fund (1996)
 Lamport Foundation Fund (1975)
 Landlocked Fund (1986)
 Allan Browning Lane Memorial Funds (1980)
 Lang Fund (1982)
 Lang Overbrook Fund (1995)
 Langner Family Fund (2000)
 Catherine & Henry Lanier Family Fund (1998)
 Judith & Jean Lanier Fund (1986)
 Rose Kean Lansbury Fund (2000)
 May Seton Bayley Large Memorial (1928)

- LaRosa/Zurkuhlen Fund (1997)
 William S. & Stanley S. Lasdon Fund (1984)
 David Lawrence Fund (1996)
 Le Veque Memorial Foundation (1984)
 Ledges Fund (1996)
 Lee Family Chinese Immigrant Education Fund (2001)
 Leede Family Fund (1980)
 Howard Z. Leffel Fund (1970)
 Lefrak Charitable Fund (1998)
 Lefrak Non-Advised Fund (1999)
 Lehman Brothers Fund (1980)
 Lehman Brothers T. Christopher Pettit Memorial Fund (1998)
 Delia & Artemio León Fund (1997)
 Frederick H. Leonhardt Fund (1979)
 Leonia High School Class of 1979 Entrepreneurship
 Scholarship Fund (2001)
 Reba Q. Lerch Fund (1971)
 Sidney Lerman Arts Fund (1999)
 Betty & John A. Levin Fund (1998)
 David P. & Peggy Levin Fund (1995)
 Dustin Levine Fund (2000)
 Robert & Patricia Levinson Fund (1985)
 Jacob Levy Fund (1990)
 Wadsworth Russell Lewis Trust Fund (1989)
 Henry A. & Janine B. Lichstein Fund (1992)
 Lichtenstein-Miller Fund (1994)
 Barbara & Richard Lieberman Fund (1979)
 Light Fund (1998)
 Dawn Lille Dance Award Fund (1994)
 Ken Lin Fund (2002)
 Robert & Maria Lin Fund (1992)
 Linden Memorial Fund (1994)
 Adolf G. & Eloise Linden Scholarship Fund (1995)
 Alexander & Ella Lindsey Fund (1991)
 Lindgren Family Fund (1999)
 George N. & Mary D. Lindsay Fund (1996)
 Linwood Fund (1983)
 Lion & Hare Fund (1970)
 Lannie S. & Howard A. Lipson Fund (2001)
 Literacy in Early Childhood Fund (2000)
 Edward H. Little Memorial Trust (1982)
 Royal Little Fund (1992)
 Nancy Liu Memorial Fund (1995)
 Livingston Fund (1995)
 Arthur L. Loeb Fund (1982)
 Frances L. Loeb Fund (1974)
 John L. Loeb, Jr. Fund (1995)
 Loewenberg Foundation Philanthropic Fund (1983)
 Wilhelm Loewenstein Memorial Fund (1940)
 Michael Lomax Memorial Fund (2001)
 Jane P. Long Fund (1991)
 Clara & Bevis Longstreth Fund (1996)
 Longview Fund (1990)
 Elizabeth Meyer Lorentz Fund (2002)
 Los Altos Anonymous Fund (2001)
 Thomas H. Loughman Memorial Scholarship Fund (1978)
 Ellee J. Lovelace Fund (1970)
 Frances & Robert A. Low Fund (1999)
 Ruth Norden Lowe & Warner L. Lowe Memorial Fund (1990)
 Lowenstein Fund (2002)
 Ilene & Edward Lowenthal Family Fund (1993)
 Rena M. Lucardi Fund (1997)
 Lucien Fund (2000)
 Melvin Ludwig Memorial Fund (1993)
 Judge J. Edward Lumbar U.S. Attorneys Fellowship Fund (1977)
 Lynford Family Fund (1988)
 Amelia & George Lyons Memorial Fund (1994)
 Camp Edith Macy Fund (1926)
 Edith Carpenter Macy Memorial Fund (1926)
 Wilson H. Madden, Jr. Fund (1993)
 Maginnis Family Fund (1994)
 Brian & Florence Mahony Fund (1997)
 Major Fund (1971)
 T. Maltese Fund (1998)
 Jan W. Mares Fund (1978)
 Mariposa Fund (1986)
 Mark Family Fund (1986)
 Alison Billie Marks Memorial Fund (1993)
 Dora, Edythe K., & Sylvia Marks Family Fund (1999)
 Dorothy Marks Fund (1997)
 Royal S. Marks Foundation Fund (1992)
 Marlin Fund (1995)
 Alfred J. Marrow Fund (1974)
 Patricia T. Marshall Fund (1998)
 *Marstrid Fund (2003)
 Suzette Brooks Masters & Seth J. Masters Fund (1999)
 Vincent James Mastronardi/Thomas J. Fahey Memorial Fund
 (1993)
 Margaret Mathews Fund (2001)
 MacDonald Mathey Fund (2001)
 Mathys Fund (2000)
 Edward Maverick Fund (1963)
 Maxwell Family Fund (1991)
 Claudia Kress Mayberry Fund (2000)
 Jessica Kress Mayberry Fund (2000)
 Paul M. Mazur Fund (1945)
 Peter & Drusilla Mazur Fund (1975)
 *McAfee Foundation Fund (2003)
 Sarah S. McAlpin Fund (1996)
 Townsend Martin McAlpin Fund (1983)
 Blanche & Edwin D. McArthur Fund (1999)
 McCaffrey Family Fund (1985)
 McClendon Fund (1999)
 Cyrus McCormick & Florence S. McCormick Memorial Fund (1995)
 Colonel & Mrs. Henry Bayard McCoy Memorial Fund (1957)
 Ruth McCreary Fund No. 1 (2001)
 Ruth McCreary Fund No. 2 (2001)
 Alonzo L. McDonald Family Fund (1983)
 Donald Wesley McDougall Memorial Fund (1991)
 Michael R. McGarvey Fund (2001)
 Richard E. "Rusty" McGivney Memorial Fund (1999)
 John F. & Jean C. McIlwain Fund (1995)
 Mark McInerney Fund (1986)
 *Dave McKennan Memorial Fund (2003)
 Isabel C. McKenzie Fund (1952)
 Janet H. McPherson Memorial Funds for Children (1984)
 Emily McIntyre Means Fund (1995)
 Melzer Fund (1994)
 *Toni Mendez Fund (2003)
 Friedrike Merck Fund (2002)
 George W. Merck Fund (1987)
 John Merck Fund (1981)
 Helen Merrill Fund (1998)
 Ralph D. Mershon Trust (1953)
 LuEsther T. Mertz Fund (1995)
 LuEsther T. Mertz Advised Fund (1995)
 Charles Merz & Evelyn Scott Merz Memorial Fund No. 1 (1984)
 Charles Merz & Evelyn Scott Merz Memorial Fund No. 2 (1984)
 Merz Supplemental Fund (1986)
 Ruth W. Messinger Fund (1995)
 Sharon Metrick Memorial Fund (2001)
 Metropolitan Region Transportation Fund (1993)
 MIBBS Fund (1993)
 Michaels Fund (1979)
 Jeanne Michaud Gift (1964)
 Middle Road Fund (1983)
 Midnight Mission Fund (1974)
 Midtown Fund (1997)
 Gregory Millard Memorial Fund (1985)
 M.J.H. Fund (1964)
 MLW Advised Fund (1998)
 Mobility Rehabilitation Fund (1964)
 Leo Model Fund (1988)
 Moles Scholarship Fund (1996)

M

- M & N Fund (2000)
 Clara L. Macbeth Funds (1977)
 Sharon & William Macey, Jr. Fund (2000)
 Nancy G. & C. Richard MacGrath Fund (1996)
 Machnikoff Family Fund (1986)
 Affie & Richard Macksoud Foundation (1975)
 Lloyd F. MacMahon Fellowship Fund (1989)
 John D. Macomber Fund (1999)

Molly & Carl Fund (2000)
 Monmouth Fund (1984)
 Moore Family Fund (1994)
 Barbara F. & Richard W. Moore Fund (1997)
 Shirley I. Moore Fund (2002)
 Moosehead Fund (1996)
 Arthur G. Moraes Memorial Fund (1999)
 Moreover Fund (1985)
 Marie Morgello Book Fund (1993)
 Jenny Morgenthau & Eugene R. Anderson Fund (1992)
 Morningside Retirement & Health Services Fund (1993)
 Helene & Bruce Morrell Fund (1999)
 Morris Opportunity Fund (1976)
 Alice V. & Dave H. Morris Memorial (1958)
 Jennifer Emily Morris Memorial Fund (1985)
 Lawrence Morris Charitable Trust (1992)
 Robert C. Morris & Aline B. Morris Fund (1939)
 Georgiana Koenig Morrison Fund in Memory of Cyrus Morrison (1990)
 Carl Walter Mortenson Fund (1996)
 George T. Mortimer Foundation (1970)
 Moses Fund (1992)
 Hanna & Jeffrey Moskin Family Fund (1997)
 Sam & Fanny Moskowitz Fund (1986)
 Sheila & James Mossman Fund (2000)
 Mostel/Herman Family Fund (1994)
 Mount of Olives Fund (1989)
 Frieda Mueller Fund (1981)
 Suzanne C. & Carl M. Mueller Charitable Fund (1999)
 Joanna Mufson Memorial Trust Fund (1983)
 Mulber Fund (1947)
 Stephen Mulderry Memorial Fund (2001)
 Alexandra Munroe Fund (2002)
 Munson Foundation (1978)
 Marjorie Oatman Munson Memorial Fund (1980)
 Thomas W. & Florence T. Murphy Fund (1984)
 Virginia Murphy Memorial Scholarship Fund (1954)
 *William & Janice Murphy Charitable Fund (2003)
 Musical Arts Fund (1939)
 Mustard Seed Fund (2000)

N

Nager-Wentworth Fund (1993)
 Anni P. Nalbandian Memorial Scholarship Fund (1997)
 Nana & Annie's Fund (1999)
 Murray L. & Belle C. Nathan Fund (1996)
 Walter W. Naumburg Memorial No.1 (1960)
 Walter W. Naumburg Memorial No.2 (1960)
 Navesink River Group Fund (2002)
 Gabe & Beth Nechamkin Fund (1997)
 Richard H. Needham Fund (1995)
 Neighborhood 2000 Fund (1997)
 Ilse Nelson Fund (1986)
 Joan & Michael Nelson Charitable Fund (1986)
 Martin & Estelle Nelson Fund (1992)
 Ness Fund (1972)
 Netmarket Fund (2000)
 Neuberger Berman, LLC Fund (1997)
 Daniel Neubourg Fund (1999)
 Nicole & Mark Neuhaus Fund (2000)
 New Rochelle Community Fund (1985)
 New York City AIDS Fund (1988)
 New York Critical Needs Fund (1975)
 "New York It Ain't Over" Fund (1993)
 New York Vietnam Veterans Memorial Fund (1983)
 Annalee Newman Fund (1998)
 *Arthur B. & Eileen D. Newman Charitable Fund (2003)
 Hally & James Nicol Fund (1998)
 Herbert Nidenberg Scholarship Fund (1993)
 Olivia Schieffelin Nordberg Fund (1996)
 Northcliff Philanthropic Fund (1979)
 Adelaide Walker Nugent Fund (1974)
 NYC Workforce Development Fund (2001)

O

Oak & Acorn Fund (2000)
 Oasis Fund (1984)
 Lindsay & Terry O'Brien Fund (2002)
 Sheila J. O'Connell Fund (1999)
 A.P.J. O'Connor Fund (1996)
 Robert K. & Jean O'Connor Fund (1979)
 William B. O'Connor Fund (1996)
 Octagon Fund (1978)
 Mary P. Oenslager Foundation Fund (1996)
 Abraham Oestreicher Fund (1972)
 John Ogden Memorial Fund (1986)
 *O'Hanlan-Walker Family Fund (2003)
 Florence C. Oliveira Memorial (1969)
 Olmezer Family Fund (1998)
 Olmi Fund (1998)
 Jacqueline Kennedy Onassis High School Fund (1997)
 Open Door Fund (1996)
 Oppenheim Family Fund (2000)
 Martin & Suzi Oppenheimer Philanthropic Fund (1998)
 Origo-Levy Animal Care Fund (1993)
 Origo-Levy Child Welfare Fund (1993)
 Maxwell Orloff Fund (1998)
 Donald R. Osborn Fund (1986)
 Courtlandt Otis Fund (1973)
 Jeanne Marie Otter Scholarship Fund (1989)
 Outdoor Life Conservation Fund (1998)
 Zoltan Ovary Symposium Fund (1984)
 Overlook Fund (1971)
 Owen Fund (1986)

P

F. LeMoyne Page Memorial Fund (1977)
 Mary LeMoyné Page & Romaine LeMoyné Billings Memorial Fund (1980)
 Manfred Pakas Scholarship Fund (1981)
 Heidi Paoli Fund (1987)
 Papa & Nunu Fund (1999)
 Katharine A. Park Funds for the Elderly (1982)
 William Hallock Park Research Fund (1976)
 Parkinson Fund (1995)
 Lorenzo & Isabelle Parsons Scholarship Fund (1998)
 Partnership for Family Supports & Justice Fund (2002)
 Partridge Fund (1997)
 Patricof Family Foundation Fund (1979)
 Robert P. Patterson Memorial (1952)
 Oliver H. & Lola G. Payne Fund (1994)
 *Marion & Bret Pearlman Charitable Fund (2003)
 Pedowitz Family Fund (1999)
 Pennies from Heaven Fund (2001)
 Penobscot Fund (1993)
 People & Places Fund (1999)
 Donald & Miriam Marya Perkins Charitable Fund (1989)
 Dorothy Perlow Fund (1996)
 Jacob Perlow Memorial Fund (1983)
 Irene Peron Fund (2000)
 CB Perrette Fund (1999)
 Virginia & Jean R. Perrette Fund (1997)
 Richard L. Perry Memorial (1935)
 Leonard L. Perskie Memorial Fund (1980)
 Petersmeyer Family Fund (1973)
 Peter G. Peterson Fund (1977)
 Peter G. Peterson & Joan Ganz Cooney Fund (1980)
 Seymour & Beverly Peyser Fund (1986)
 Phil Fund (2001)
 *Hal Philipps Fund (2003)
 Kenneth A. & Helen Clark Phillips Fund (1972)
 Charles M. Phinny Fund (1987)
 Pilkington Family Fund (1996)
 Pilot House Fund (1985)
 Pine Cone Fund (2000)
 Pine Point Fund (1986)
 Pine Tree #2 Fund (2000)
 Pinkerton Trust (1979)
 Marietta C. Pino Memorial Fund (1982)
 Emanuel & Nora Piore Fund (2002)

- Emanuel & Nora Piore Memorial Fund (2002)
 John Polachek Fund (1958)
 Samuel S. & Anne H. Polk Charitable Fund (2000)
 Maxwell A. Pollack Fund (1986)
 Leo L. Pollak Memorial Fund (1984)
 Richard H. Pollak Fund (1987)
 Helene Pomerantz Memorial Fund (1991)
 Katharine Sloan Pratt Fund (2002)
 Pre-School Inclusion Fund (2001)
 Barbara & Robert Preiskel Fund (1986)
 Barbara S. Preiskel Memorial Fund (2002)
 Kurt & Gladys Preuss Fund (1981)
 Sidney S. Prince Trust (1964)
 Thomas Pringle Memorial/Margaret Pringle Fenton Fund (1957)
 Thomas Pringle Memorial/Samuel Pringle Fund (1957)
 Robert & Ilse Prosnitz Fund (1999)
 *Valerie & Michael A. Puglisi Fund (2003)
 Pundyk Family Fund (1998)
 Pyewacket Fund (1997)
- Q**
 Q Fund (1996)
 Quasha Family Fund (1995)
 Queens College Speech & Hearing Center Fund (1999)
 James & Kathleen Quinn Memorial Fund (1991)
 Alan G. Quitko Fund (1997)
- R**
 RAB Fund (1975)
 R.A. Radley Fund (1994)
 Ragin Family Fund (2002)
 Raiziss/de Palchi Translation Award Fund (1994)
 *Calvin Ramsey Scholarship Fund (2003)
 Addison C. Rand Fund (1940)
 Carl & Toni Randolph Fund (2000)
 Ralph J. Rangel Fund (1989)
 Rankin-Smith Fund (1985)
 Paul Rapoport Fund (1982)
 Anthony E. & Josephine C. Rapp Fund (1996)
 Rattigan Family Fund (1996)
 F&R Ravitz Family Fund (1997)
 Jeanne & Norman Reader Better English Award Fund (1997)
 Rebold Family Fund (2000)
 Readers Digest Scholarship & Leadership Fund (1974)
 Redstone Fund (1997)
 Philip D. Reed Fund (1996)
 Thomas D. & Natalie B. Rees Family Fund (1996)
 Joseph E. Reich Fund (1986)
 Henry H. Reichhold Scholarship Fund (1968)
 Cordelia & David Reimers Fund (2002)
 Reingold Family Fund (2000)
 Jerilyn Hayes Reiter Memorial Scholarship Fund (2001)
 Rembrandt Fund (1977)
 Eugene H. & Patricia C. Remmer Fund (1986)
 Karl F. Reuling Fund (1993)
 Reynwood Fund (1986)
 R. Rheinlein Fund (1999)
 *Audrey Rheinstrom & Anne Blevins Fund (2003)
 Rhodebeck Central Park Conservancy Fund (1999)
 Rhodebeck Fund for the Elderly (1989)
 Rhodebeck Fund for the Homeless (1989)
 Rhodebeck Fund for St. George's Society of New York (2001)
 Grantland Rice Fellowship Fund (1951)
 Peggy S. & Henry Hart Rice Fund (1983)
 Marion & George Riley Fund (1968)
 Rinaker Family Fund (1983)
 Henry P. Riordan Fund (1990)
 James Q. & Ruth M. Riordan Fund (1983)
 *Jordan Carlson Riordan & James Quentin Riordan III Memorial Fund (2003)
 Rippe Family Fund (2001)
 Virginia S. Risley Family Fund (1995)
 RMC Fund (1959)
 Emilie D. Robb Fund (1938)
 Patricia & Yves Robert Fund (1998)
 Roberts Family Fund (1999)
 Robinson-Morrill Fund (1992)
- Barbara Paul Robinson & Charles Raskob Robinson Fund (1996)
 Marguerite P. Roche Fund (1972)
 Laura Spelman Rockefeller Memorial Fund (1928)
 Mary French Rockefeller Fund (2000)
 Rogers Family Fund (1995)
 Sarah & Harry Rogers Fund (1994)
 Abigail Rome Fund (1990)
 Jack & Leslie Ronder Fund (1999)
 Dr. Joseph Richard Rongetti Scholarship Fund (1996)
 *Hugh & Katherine Roome Charitable Fund (2003)
 Curtis Roosevelt Fund (1989)
 Celinda Rosario Memorial Fund (1992)
 Rose Hill Fund (1992)
 Jonathan F.P. Rose & Diana Calthorpe Rose Fund (1996)
 Richard Rose Fund (1981)
 Sandra Priest Rose Fund (2002)
 Rose/Margulies Fund (1997)
 Jack & Mae Rosenberg Fund (1997)
 Rosenfeld Family Fund (1986)
 June S. Rosenfeld Memorial Fund (1989)
 Susan Rosenfeld Fund (1998)
 John P. Rosenthal Fund (1973)
 Ida Ross Memorial Fund (1986)
 Lila & Arnold S. Ross Charitable Fund (2000)
 Rossetti Family Fund (2001)
 Clara Lewisohn Rossin Trust (1949)
 Edmond de Rothschild Fund (2000)
 Lynn Forester de Rothschild Fund (2002)
 Roxbury Fund (1997)
 Lisa Cordell Rubin Fund (1995)
 Samuel N. & Charlotte Rubin Fund (1996)
 Frederic A. & Susan A. Rubinstein Fund (1986)
 Harry J. Rudick Fund (1988)
 Rue de Reves Fund (1987)
 Thomas Ruotolo Scholarship Fund (1985)
 William D. Russell Fund (1971)
 Rye Scholarship Fund (1977)
- S**
 Myrten G. & Lillian V. Saake Memorial Fund (1994)
 Daniel Saccomanno Fund (1996)
 Bonnie & Peter Sacerdote Family Fund (1975)
 Samuel Sacks Funds (1970)
 Safer-Fearer Fund (1998)
 Dr. Abraham & Shirley Saifer Fund (1992)
 Herbert & Nancy Salkin Fund (1975)
 Samaratrophia Fund (1995)
 Nathan & Nancy Sambul Fund (1997)
 Stacey Sanders Fund (2001)
 Sarah A. Sanford Fund (1949)
 Linda U. Sanger Charitable Fund (1999)
 Louis & Carolyn Sapir Family Fund (1998)
 Michael Sasse Charitable Fund (2001)
 *James & Sarah Scanlon Fund (2003)
 Philip Scaturro Fund (2000)
 Brigitte Holmen Schattenfeld Family Fund (2002)
 Marielle J. Scheff Fund (2002)
 Scheide Fund (1971)
 Schein Family Memorial Fund (1987)
 *Henry Schein Company Fund (2003)
 Jacob H. Schiff Memorial (1924)
 Jacqueline Schiller Fund (1998)
 Max G. Schlapp Mental Hygiene Fund (1979)
 Shain Schley Fund (1999)
 Grace & Edith Schneider Memorial Fund (1949)
 Schneiderman Family Fund (1994)
 Anna E. Schoen-Rene Fund (1942)
 Scholarships For Kids Fund (1993)
 Anthony & Elizabeth Schulte Fund (1997)
 John W. Schulz Memorial Fund (2000)
 Alan D. Schwartz Family Fund (2000)
 Stephen A. Schwarzman Fund (1999)
 Robert J. Schweich Fund (1981)
 Alfred H. Schwendtner Fund (1996)
 Walter D. Scott Fund (1985)
 Gail Aidinoff Scovell & Edward P. Scovell Fund (1986)

Sea Cliff Fund (1986)
 Seal Point Foundation (1966)
 Sealion Charitable Fund (1998)
 Eleanor T. Seidel Memorial Fund (1984)
 Selby/Vail Fund (2001)
 Mamie Sellar Memorial Fund (1978)
 The September 11th Fund (2001)
 Jerome & Joan Serchuck Fund (1971)
 Alfred M. Serex Fund (1999)
 J. Walter & Helen C. Severinghaus Fund (1988)
 William H. Seward, Jr. Fund (1962)
 Harris Shapiro Fund (1996)
 Shaw Foundation Fund (1964)
 Shearman & Sterling Fund (1999)
 Sheinberg Family Fund (1996)
 Annette & William Sherman Fund (1999)
 Lola J. Sherman Fund (1937)
 Sherrow Family Fund (1998)
 Jack & Dorothy Shulman Memorial Fund (1984)
 *Andrew Sidamon-Eristoff Fund (2003)
 Catherine & Andrew Sidamon-Eristoff Family Fund (2001)
 *Elizabeth Sidamon-Eristoff Fund (2003)
 *Simon Sidamon-Eristoff Fund (2003)
 Siebert Family Fund (2001)
 Jayne M. Silberman Fund (1986)
 Lois & Samuel Silberman Building Fund (1992)
 Lois & Samuel Silberman Charitable Fund (1993)
 Lois & Samuel Silberman Grant Fund (1992)
 Ruth & Marvin Silberman Memorial Fund (1967)
 Al & Rosa Silverman Fund (1994)
 Marty & Dorothy Silverman Fund (2001)
 Arlene B. Simon Fund (1986)
 *Suzanne Cohn Simon Fund (2003)
 Simpson Thacher & Bartlett Fund (1995)
 Cecile Singer Fund (2000)
 Stephen Sirkin Memorial Fund (1984)
 Skilen Fund (1996)
 Deborah A. Smith Fund (1986)
 Jacqueline & Albert Smith Fund (1993)
 Jeffrey R. Smith Memorial Scholarship Fund (2001)
 Smith-Weil Foundation Fund (1999)
 Richard L. Snyder Fund (1991)
 Sobel/Karas Fund (2001)
 Laura Solinger Fund (1993)
 L. & S. Soll Fund (1998)
 David & Nancy Solomon Fund (2000)
 Hannah Fox Solomon Fund (2002)
 Solow Foundation Philanthropic Fund (1988)
 Abe, Lena & Irin Soskis Memorial Fund (1984)
 Abe, Lena & Irin Soskis Memorial Fund No. 2 (1985)
 Fernando Soto, Jr. Fund (2000)
 Alireza Soudavar Fund (1986)
 Mammadi Soudavar Memorial Fellowship Fund (1982)
 *Patricia & Michael Sovern Fund (2003)
 Rose M. Soybel Rose Garden Fund (1997)
 Carol & Charles Spaeth Memorial Fund (1986)
 Special Fund No. 11 (1968)
 Special Fund No. 14 (1950)
 Special Fund No. 20 (1962)
 Tivy Spence Achievement Fund (1999)
 Arthur L. Spencer Memorial Scholarship Fund (2002)
 Marion R. Spinnler Education Fund (1970)
 Sports Center Fund (1999)
 Squadron A Fund (1983)
 Nicholas Warren Squires Family Fund (1991)
 Stack Family Fund (1994)
 Catherine T. & Maurice D. Stack Fund (1986)
 Stadler Fund (1997)
 Ilma Stafford-Greene Fund (1977)
 Alma Timolat Stanley Fund (1987)
 Ruth & Frank Stanton Fund (1973)
 Starry Night Fund (1998)
 Stars & Stripes Fund (1988)
 *Betty J. Stebman Fund (2003)
 Albert & Marie Steinert Fund (1991)
 Chris Stemland Fund (1991)

Stephens Bequest (1942)
 Sterling Fund (1985)
 Henry J. Stern & Robert F. Wagner, Jr. Fund (1982)
 Ettie Stettheimer Memorial Fund (1960)
 Mrs. John Stevenson Fund (1986)
 Gertrude Stewart Memorial Scholarship Fund (1971)
 Kate H. Stiassni Fund (1999)
 Stonehome Fund (1956)
 Barnard Sachs Straus Fund (1986)
 Edward K. Straus Fund (1951)
 Stronach-Buschel Fund (1995)
 Stroock Spirit of New York Fund (2001)
 *Carole Stupell Travel Award Program (2003)
 Summer in the City (1998)
 Sunrise Fund (1996)
 Billy Sunshine Memorial Scholarship Fund (1985)
 Surrogate's Court Fund (1991)
 Robert J. Suslow Fund (1998)
 Kelso F. & Joanna L. Sutton Fund (1998)
 R. Swayze Gay & Lesbian Youth Fund (1996)
 John & Devereux Swing Philanthropy Fund (1998)

T

Hazaros Tabakoglu Scholarship Fund (1994)
 Robert A. Taft Institute of Government Trust (1969)
 Peter Talbert Charity Fund (1999)
 W. Pike Talbert Charitable Fund (1986)
 James Talcott Fund (1974)
 Helen S. Tanenbaum Fund (1954)
 Nicki & Harold Tanner Fund (2001)
 Rachel Tanur Memorial Fund (2002)
 Dave Taylor Memorial Fund (1995)
 Mary E. Taylor & Christopher C. Behrens Charitable Fund (1998)
 William J. Taylor Fund (1939)
 TechnoServe Fund (1993)
 William Clark Terry Scholarship Fund (1983)
 Third Millennium Fund (1973)
 Thomas Fund (1995)
 Thomas COPD Fund (1996)
 Marvin & Doris Thomas Fund (1996)
 Grandchildren of Fred & Florence Thomases Fund (1999)
 Judith Dana Thorne Fund (1990)
 *Nathan & Nicholas Thorne Fund (2003)
 Olaf J. & Margaret L. Thorp Fund (1987)
 316th Association Memorial Fund (1994)
 316th Infantry Monument Fund (1969)
 Three Ninety Fund (1972)
 Maria & William Thurnauer Fund (1983)
 Nancy H. Tilghman Fund (1999)
 Jane M. Timken Charitable Fund (1987)
 Tisser Family Fund (1998)
 Tobacco Pink Fund (1977)
 Carol H. Tolan Fund (1997)
 Nathaniel & Sarah Tooker Fund (1972)
 Tor Family Fund (1999)
 Raymond & Beverly Tower Fund (1997)
 Town Hill School Fund (1993)
 Tozer Family Fund (1987)
 Traer Fund (1976)
 Charles Welford Travis Trust (1981)
 Trevor Fund (1986)
 Harry D. Triantafillu Fund (1986)
 Trinity Chapel Home Fund (1960)
 Tripod Fund (1979)
 Jean L. & Raymond S. Troubh Family Fund (1998)
 John B. & Louisa S. Troubh Fund (1993)
 Turner Fund (1999)
 Paul N. Turner Bequest (1960)
 Twenty-First Century Fund (1981)
 Charles P. Twichell Fund (1995)
 Two Kids from the Bronx Fund (1986)

U

Beth M. Uffner Fund (1998)
 *Don & Patricia Underwood Fund (2003)
 United Way Humancare Fund (1984)

V

Vacolo Fund (2000)
 Gilad Vaday Fund (2000)
 Anne van Biema Fund (1996)
 van Hengel Family Fund (1980)
 Edward & Sally Van Lier Fund (1988)
 *Lottie Grace Vanderveer Fund (2003)
 Vaughan/Winton Fund (1995)
 *Nancy Veith Fund (2003)
 Lillian Vernon Foundation Fund (2001)
 Nicholas M. & Susan J. Verrastro Memorial Scholarship Fund (1998)
 Rudolf & Anna Marie Vetter Memorial Fund (1977)
 R.G. Viault Family Fund (1999)
 *Viburnum Trilobum Fund (2003)
 John L. Vigorita, M.D. Memorial Fund (1991)
 Vital Projects Fund (1977)
 David & Johanna Voell Family Fund (2001)
 Gregory & Elyzabeth Voell Family Fund (2001)
 Jeffrey Voell Family Fund (2001)
 Richard & Virginia Voell Family Fund (1986)
 Hans A. Vogelstein Memorial Scholarship Fund (1982)
 Mrs. Claus von Bulow Fund (1971)
 Enders M. Voorhees Fund (1973)

W

Marian Marcus Wahl Memorial Fund (1985)
 *Walker Fund (2003)
 *Bayard Walker, Jr. Charitable Fund (2003)
 Julia & Carter Walker Fund (1997)
 *Walker-Pratt Family Fund (2003)
 Walker Smith Fund (1984)
 Theresa Dow Wallace Scholarship Fund (1975)
 Wallace Education Fund (1988)
 Wallace Special Projects Fund (1991)
 De Witt Wallace New York Hospital Fund
 De Witt Wallace St. Christopher's School Fund (1974)
 De Witt Wallace Youth Travel Enrichment Fund (1982)
 Frederick J. & Theresa Dow Wallace Fund (1977)
 Lila Acheson Wallace Theater Fund (1984)
 Waller-Davidson Fund (1980)
 Anthony W. & Lulu C. Wang Fund (1996)
 Moritz & Charlotte Warburg Memorial (1925)
 David Warfield Funds (1951)
 David & Mary Warfield Funds (1973)
 Mary Warfield Fund (1971)
 Bradford A. & Nancy H. Warner Fund (1985)
 Watcha Fund (1988)
 Wattles Family Charitable Trust Fund (1981)
 Alice W. Wattles Fund (1974)
 James Howard Wattles Fund (1947)
 Samuel Hughes Watts Memorial Fund (1973)
 We Owe NY Fund (1996)
 Weber Family Fund (2002)
 Weigel Family Fund (1999)
 Karl & Vally Weigl Fund (1980)
 *John L. Weinberg Family Fund (2003)
 Seymour & Rose Weinstock Fund (1999)
 Weintz Family Foundation (1980)
 Weintz Family Fund (1995)
 Mabel W. Weir Trust (1978)
 Nathan H. Weiss Memorial Fund (1999)
 Rebecca & Nathan Weiss Fund (1997)
 WellMet Group Fund (1999)
 Wellsford Charitable Fund (2000)
 William E. Welsh, Jr. Family Fund (1978)
 West End Road Fund (1988)
 Herbert B. West Fund (1989)
 Wheeler Fund (1992)
 Betty Wheeler Fund (1991)
 Letitia M. Whipp Memorial Fund (1972)
 Bill Whitehead Award Fund (1993)
 Edward B. Whitney Fund (1986)
 Frederic J. Whiton Fund (1960)
 Wicoppee Fund (1986)
 Stephen R. Wiener Fund (1997)
 Mary L. Wiener/Sanford M. Cohen Fund (1986)

Jeremy Wiesen Fund (1985)
 Carleton Wiggins & Donald Bain Trust (1982)
 Donna Bain Wiggins Trust (1982)
 Robert O. Wilder Fund (1989)
 Wildwood Fund (1982)
 Mason Wiley Memorial Fund (1995)
 *Cynthia & Alan Wilkinson Fund (2003)
 Henry K. S. Williams Trust No. 1 (1944)
 Henry K. S. Williams Trust No. 2 (1944)
 Mildred Anna Williams Fund (1940)
 Oscar Williams & Gene Derwood Fund (1971)
 Robert I. Williams Fund (1996)
 Sarah Williams & Andrew Kimball Fund (1999)
 Bruce & Alison Williamson Fund (1998)
 Douglas Williamson Fund (1997)
 Willkie Farr & Gallagher Fund (1984)
 Sam Wilner Fund (1997)
 John H. T. Wilson Fund (1988)
 William Ross Reid Wilson Memorial Fund (1991)
 Wilton-Risdon Fund (1994)
 Wiltwyck School Fund (1988)
 Wind Down Fund (1989)
 Windie Knowe Fund (1998)
 *Windie Knowe Fund II (2003)
 Windsor Fund (1977)
 John Winston Fund (1999)
 Jay Winston Scholarship Fund (1997)
 Winterer Fund (1986)
 Winthrop Family in America Fund for Groton Church (1982)
 John Winthrop Fund (1970)
 Margaret S. Winthrop Fund (1972)
 Leone Scott Wise Fund (1986)
 Witches' Fund (1998)
 Witkin Family Fund (1988)
 Kate & Richard Witkin Fund (1988)
 Joanne Witty & Eugene Keilin Fund (1986)
 C. Theodore Wolf & Francis X. Decolator II Fund (1996)
 Ross Wollen Charitable Fund (1997)
 World Trade Center Hoboken Memorial Scholarship Fund (2002)
 World-Wide Fund (2002)
 World-Wide Holdings Fund (2002)
 Clara Kennon Worley Fund (1973)
 Worth Fund (1992)
 Wray Fund (1986)
 Seymour B. Wurzler Bequest (1963)
 Thomas H. Wyman Family Fund (2002)

Y

J. Ernest Grant Yalden Memorial Fund (1956)
 Yamin Family Fund (1994)
 Yancey Family Fund (1986)
 Yaseen Lectures on the Fine Arts (1971)
 Samuel McC. & Lizora M. Yonce Fund (1986)
 You Can't Take It With You Fund (1986)
 H. R. Young & Betty G. Young Fund (1979)
 Nancy Young & Paul B. Ford, Jr. Fund (1986)
 Thomas & Elsie Young Fund (2000)
 Stephane Yulita Children's Fund (1989)
 Stephane Yulita & Inge Kadon Fund (2000)

Z

Judith & Stanley Zabar Fund (1993)
 *John & Catherine Zacharias Family Fund (2003)
 Eileen E. Zaglin Scholarship Fund (1993)
 Steve Zang Fund (1999)
 Zimmerman Family Fund (2002)
 Joel Zimmerman Fund (1996)
 Zofnass/Ring Family Fund (1991)
 ZPM Fund (1986)

*Created in 2003

GRANTS IN 2003

The organizations listed below received grants of more than \$15,000. Included in the list are grantees specifically recommended by advisors to individual funds. Organizations are in New York unless otherwise indicated.

A

Aaron Davis Hall, \$500,000
 Abingdon Square Painters, \$15,390
 Abyssinian Development Corporation, \$40,000
 Academy of American Poets, \$32,070
 ACCION New York, \$26,600
 Ackerman Institute for the Family, \$26,425
 ACORN, \$80,000
 Actors' Fund of America, \$101,000
 Actors Theatre Workshop, \$41,000
 Adaptive Design Association, \$30,000
 ADC Research Institute (D.C.), \$75,000
 Adelphi University, \$1,127,575
 Adirondack Council, \$22,750
 Adirondack Historical Association, \$80,950
 Advertising Council, \$30,000
 Advocates for Children of New York, \$113,350
 African-American Institute, \$18,700
 African-American Media Network, \$35,500
 African Services Committee, \$70,800
 Africare (D.C.), \$25,000
 AFS-USA, \$333,950
 After Hours Project, \$30,000
 After-School Corporation, \$322,000
 Agenda for Children Tomorrow, \$25,576
 Aging in New York Fund, \$175,000
 Alvin Ailey Dance Foundation, \$72,316
 Akiba-Schechter Jewish Day School (Ill.), \$63,000
 Al-Haqiqa Television (D.C.), \$50,000
 Alianza Dominicana, \$46,000
 Alliance of Resident Theatres/New York, \$102,500
 Alpha Workshops, \$25,100
 Borough of Alpine Police Department (N.J.), \$38,564
 Alzheimer's Disease & Related Disorders Association (Ill.), \$68,250
 Ambulatory Pediatric Association (Va.), \$150,000
 American Academy in Rome, \$26,000
 American Associates-Ben Gurion University of the Negev, \$15,200
 American Cancer Society, Eastern Division (N.J.), \$66,680
 American Civil Liberties Union Foundation, \$49,115
 American Civil Rights Education Services, \$30,000
 American Craft Museum, \$59,900
 American Farm School, \$37,000
 American Friends of the Hebrew University, \$64,800
 American Friends Service Committee, \$92,015
 American Fund for the Tate Gallery, \$25,000
 American Heart Association, Long Island Heritage Affiliate, \$278,902
 American Heart Association, New York State Affiliate, \$28,930
 American Institute for Social Justice (D.C.), \$20,000
 American-Italian Cancer Foundation, \$60,000
 American Jewish Committee, \$124,550
 American Jewish World Service, \$54,500
 American Judicature Society (Iowa), \$25,000
 American Lung Association of New York State, \$60,000
 American Museum of Natural History, \$85,825
 American Music Center, \$250,100
 American Prospect, (Mass.), \$100,000
 American Red Cross, Dutchess County Chapter, \$35,000
 American Red Cross in Greater New York, \$194,031
 American Red Cross, Nassau County Chapter, \$45,625
 American Red Cross/National Headquarters (D.C.), \$40,850
 American Rivers (D.C.), \$325,000
 American Social History Productions, \$60,000

American Society of the Most Venerable Order of the Hospital of St. John of Jerusalem, \$21,700
 American Society for the Prevention of Cruelty to Animals, \$71,47
 American Sufi Muslim Association, \$25,000
 American Symphony Orchestra, \$35,000
 American University of Beirut, \$27,750
 American University in Cairo, \$40,500
 Americans for Oxford, \$102,500
 Amethyst Women's Project, \$25,000
 Amherst College (Mass.), \$109,000
 Amnesty International of the USA, \$40,250
 Anchor, \$31,000
 Billy Andrade-Faxon Charities for Children (Mass.), \$50,000
 Angel Guardian - St. Mary's Children & Family Services, \$28,500
 Animal Medical Center, \$305,350
 Animal Rescue Fund of the Hamptons, \$40,300
 Anti-Defamation League of B'nai B'rith, \$114,800
 Appalachian Community Fund, (Tenn.), \$200,000
 Appleseed Foundation (D.C.), \$42,500
 Arab-American Family Support Center, \$90,000
 Arcadia University (Pa.), \$50,000
 Archdiocesan Catholic Guild for the Blind, \$60,000
 Architecture Research Institute, \$53,000
 Arthritis Foundation, New York Chapter, \$46,700
 Asia Society, \$72,420
 Asian-American Consulting Services, \$55,000
 Asian American Legal Defense & Education Fund, \$40,000
 Asian Americans for Equality, \$47,900
 Asociacion Tepeyac de New York, \$20,000
 Asphalt Green, \$57,900
 ASPIRA of Connecticut, \$50,000
 ASPIRA of New York, \$46,000
 Association of the Bar of the City of New York Fund, \$136,850
 Association for Neighborhood & Housing Development, \$75,000
 Association of the U.S. Army (Va.), \$37,000
 Atlantic Theater Company, \$90,000
 Auburn Theological Seminary, \$19,500
 Audubon Partnership for Economic Development, \$40,000
 Audubon Society of Rhode Island, \$24,000

B

Baldwin-Wallace College (Ohio), \$72,000
 Ballet Tech Foundation, \$256,000
 Ballet Theatre Foundation, \$148,950
 Bank Street College of Education, \$129,035
 Bardavon 1869 Opera House, \$41,500
 Barium Springs Home for Children (N.C.), \$85,260
 Barnard College, \$29,250
 F. D. Barstow Memorial School (Vt.), \$25,000
 Bernard M. Baruch College of CUNY, \$52,250
 Baruch College Fund, \$48,700
 Baseball Assistance Team, \$100,000
 Vivian Beaumont Theater/Lincoln Center Theater, \$85,565
 Bellevue Association, \$35,000
 Bennington College Corporation (Vt.), \$109,000
 Beth Israel Medical Center, \$262,850
 Bethesda Hospital Foundation (Fla.), \$27,000
 Bide-A-Wee Home Association, \$50,100
 Big Brothers/Big Sisters of New York City, \$64,908
 Biodiversity Project (Wis.), \$100,000
 Blanton-Peale Institute, \$23,600
 Bloomingdale House of Music, \$48,000
 Boston College (Mass.), \$19,150
 Boston Foundation (Mass.), \$25,000
 Boston University (Mass.), \$43,200
 Boston University School of Public Health (Mass.), \$98,000
 Bowdoin College (Maine), \$60,000
 Bowery Residents' Committee, \$50,000
 Boy Scouts of America, Greater New York Councils, \$109,867
 Boys' Club of New York, \$208,250
 Boys & Girls Club of Greenwich (Conn.), \$100,000

Boys & Girls Clubs of America, \$41,360
 Boys & Girls Harbor, \$104,700
 Boys Town Jerusalem Foundation of America, \$23,480
 Brandeis University (Mass.), \$18,250
 Breast Cancer Research Foundation, \$127,000
 William J. Brennan, Jr. Center for Justice, \$60,200
 Brick Church School, \$26,000
 Brick Presbyterian Church, \$39,000
 Brigham & Women's Hospital (Mass.), \$27,000
 British American Educational Foundation, \$25,000
 Broadway Cares/Equity Fights AIDS, \$21,800
 Broadway Housing Development Fund Company, \$50,000
 Bronx Community Cable Programming Corporation, \$50,000
 Bronx Council on the Arts, \$70,000
 Bronx Defenders, \$94,862
 Bronxville School Foundation, \$121,000
 Brookhaven Memorial Hospital Medical Center, \$16,500
 Brooklyn Academy of Music, \$72,145
 Brooklyn Bar Association Volunteer Lawyers Project, \$35,350
 Brooklyn Botanic Garden Corporation, \$17,430
 Brooklyn Bridge Park Coalition, \$32,750
 Brooklyn Bureau of Community Service, \$54,180
 Brooklyn Children's Museum Corporation, \$20,985
 Brooklyn College Foundation, \$86,000
 Brooklyn Kindergarten Society, \$16,200
 Brooklyn Legal Services Corporation A, \$40,350
 Brooklyn Legal Services Corporation B, \$131,100
 Brooklyn Museum of Art, \$223,365
 Brooks School (Mass.), \$135,200
 Brookville Reformed Church, \$66,000
 Brown University (R.I.), \$242,700
 Bryant College (R.I.), \$100,000
 Bryn Mawr College (Pa.), \$22,500
 Buckley School, \$64,725
 Winifred Masterson Burke Rehabilitation Hospital, \$18,100
 Jacob Burns Film Center, \$73,000
 Bushwick Cooperative Federal Credit Union, \$40,000
 Business Executives for National Security Education Fund (D.C.), \$32,900
 Business Leaders for Sensible Priorities, \$21,000

C

Cab Watch, \$35,000
 Cambridge in America, \$25,000
 Campaign for Fiscal Equity, \$460,000
 Campaign for the Westchester Children's Museum, \$50,000
 Cancer Care, \$709,680
 Cancer Research Fund - Damon Runyon - Walter Winchell Foundation, \$45,500
 Cancer Research Institute, \$120,750
 Canine Companions for Independence (Calif.), \$15,500
 Capoeira Foundation, \$45,000
 Caramoor Center for Music & the Arts, \$29,340
 CARE USA Northeast Region, \$20,700
 Carnegie Hall Society, \$95,825
 Caroline House (Conn.), \$21,500
 CAST Resources (Mass.), \$680,000
 Cathedral Church of St. John the Divine, \$45,400
 Catholic Charities of the Archdiocese of New York, \$64,380
 Catholic Relief Services of the U.S. Catholic Conference (Md.), \$24,040
 Catholic Schools Foundation (Mass.), \$45,000
 Catskill Watershed Partnership Museum, \$30,000
 Cedars of Marin (Calif.), \$260,000
 Center for American Progress (D.C.), \$300,000
 Center for Arts Education, \$68,000
 Center for Defense Information (D.C.), \$17,600
 Center for Economic & Environmental Partnership, \$75,000
 Center for Family Representation, \$50,000
 Center for Hospice Care (N.J.), \$50,000
 Center for International Policy (D.C.), \$78,450
 Center for Marine Education & Recreation at Oyster Bay, \$15,500
 Center for New Community (Ill.), \$25,000
 Center for Public Integrity (D.C.), \$65,500
 Center for Science in the Public Interest (D.C.), \$54,700
 Center for Spiritual Exchange, \$25,000
 Central American Legal Assistance, \$25,000
 Central Brooklyn Churches Sponsoring Committee, \$30,000
 Central Brooklyn Partnership, \$40,000
 Central Park Conservancy, \$218,490
 Central Park Medical Unit, \$35,000
 Central Synagogue, \$22,015
 Century Foundation, \$300,000
 Chabad of Port Washington, \$20,000
 Chapin School, \$27,815
 Chatham United Methodist Church (N.J.), \$31,000
 Chautauqua Institution, \$30,000
 Cheshire Home (N.J.), \$25,000
 Chess-in-The-Schools, \$92,500
 Chhaya Community Development Corporation, \$20,000
 Child Care Council of Nassau, \$25,250
 Child Care Council of Westchester, \$73,755
 Childcare Learning Centers (Conn.), \$52,500
 Children of Bellevue, \$54,625
 Children, Incorporated (Va.), \$15,516
 Children's Aid Society, \$58,028
 Children's Defense Fund (D.C.), \$61,658
 Children's Emergency Medical Fund of New Jersey, \$18,000
 Children's Storefront, \$72,700
 Choate Rosemary Hall Foundation (Conn.), \$38,800
 Christ Church of Bronxville, \$105,000
 Christ Hospital Foundation (N.J.), \$46,692
 Christodora, \$50,200
 Church Avenue Merchants Block Association, \$50,000
 Church of the Holy Apostles, \$15,550
 Cicatelli Associates, \$40,000
 Citiwide Harm Reduction Program, \$35,000
 Citizens Advice Bureau, \$85,870
 Citizens Budget Commission, \$39,125
 Citizens' Committee for Children of New York, \$21,100
 Citizens for NYC, \$61,000
 Citizens Union Foundation, \$87,800
 City Center 55th Street Theater Foundation, \$43,000
 City Harvest, \$44,075
 City Limits Community Information Service, \$50,000
 City Lore: The New York Center for Urban Folk Culture, \$20,100
 City Parks Foundation, \$69,325
 City Project, \$45,000
 City University of New York, \$330,000
 Citymeals-On-Wheels, \$99,350
 Clarke School for the Deaf (Mass.), \$20,000
 Classical America, \$40,000
 Clean Production Action, \$68,000
 Clean Water Fund (D.C.), \$90,000
 William J. Clinton Presidential Foundation (Ark.), \$33,335
 Coalition on Child Abuse & Neglect, \$47,000
 Coalition for the Homeless, \$1,772,700
 Coalition of Voluntary Mental Health Agencies, \$65,000
 Colby College (Maine), \$105,000
 Cold Spring Harbor Laboratory, \$40,660
 Cold Spring Harbor Library Friends Foundation, \$25,500
 Cold Spring Harbor Rowing Association, \$60,000
 Coler-Goldwater Memorial Specialty Hospital & Nursing Facility, \$100,000
 College Careers Fund of Westchester, \$28,300
 College Gifted Programs (N.J.), \$44,900
 College of Wooster (Ohio), \$20,640
 Colorado College, \$60,500
 Columbia Grammar & Preparatory School, \$20,250
 Columbia University, \$886,415
 Columbia University, College of Physicians & Surgeons, \$154,100
 Columbia University, Graduate School of Journalism, \$40,600
 Columbia University, School of Public Health, \$136,000

Columbia University, School of Social Work, \$100,000
 Commission on the Public's Health System, \$45,000
 Committee for Economic Development, \$81,000
 Committee for Hispanic Children & Families, \$35,000
 Common Ground Community Housing Development Fund Corporation, \$57,900
 Community Food Resource Center, \$50,000
 Community Foundation for Palm Beach & Martin Counties (Fla.), \$30,000
 Community Foundations Technology Initiative (Ky.), \$250,000
 Community Resource Exchange, \$64,600
 Community Rowing (Mass.), \$30,000
 Community Service Society of New York, \$20,050
 Concerned Parents Association, \$20,000
 Concert Artists Guild, \$45,000
 Conference Board, \$35,000
 Congregation Emanuel of the City of New York, \$36,620
 Congregation Rodeph Shalom, \$57,800
 Congregations Linked in Urban Strategy to Effect Renewal, \$68,250
 CONNECT, \$60,000
 Connecticut Theatre Foundation/Westport Country Playhouse, \$23,750
 Consortium for Worker Education, \$75,000
 Constitutional Education Foundation, \$16,400
 Construction Company Theater/Dance Associates, \$18,020
 Convent of the Sacred Heart, New York City, \$20,000
 Co-op America Foundation (D.C.), \$33,800
 Cooper Union for the Advancement of Science & Art, \$43,000
 Cornell University, \$29,900
 Cornell University, The Graduate School, \$17,000
 Cornell University/Joan & Sanford I. Weill Medical College, \$22,940
 Corona Community Services Corporation, \$75,000
 Correctional Association of New York, \$21,950
 Council for Excellence in Government (D.C.), \$25,000
 Council on Foreign Relations, \$151,200
 Council on Foundations (D.C.), \$44,600
 Council of Jewish Emigre Community Organizations, \$20,000
 Council of Pakistan Organization, \$75,000
 Council for Secular Humanism, \$25,150
 Council of Senior Centers & Services of New York City, \$130,000
 Court Appointed Special Advocates (CASA), \$162,000
 Cover the Uninsured Week (N.J.), \$75,000
 Creative Capital Foundation, \$42,500
 Crippled Children's Hospital Foundation (Tenn.), \$85,260
 Cross Performance, \$45,000
 Crossnore School (N.C.), \$85,260
 Croton-Harmon School District, \$50,000
 CUNY Graduate School & University Center, \$39,500
 Cuyahoga Community College Foundation (Ohio), \$16,500
 Cypress Hills Local Development Corporation, \$45,000
 Cystic Fibrosis Foundation (Md.), \$16,200

D

Dalton School, \$267,700
 Dance Theater Workshop, \$550,500
 Danspace Project, \$50,000
 Dartmouth College (N.H.), \$70,810
 Day Care Council of New York, \$60,500
 De La Salle Academy, \$49,100
 DeCordova Museum & Sculpture Park (Mass.), \$150,000
 Denison University (Ohio), \$30,000
 Diocese of Helena, Montana, \$87,000
 Diocese of Palm Beach (Fla.), \$25,000
 Doctors of the World-U.S.A., \$34,000
 Doctors without Borders U.S.A., \$46,920
 Doe Fund, \$66,150
 Domestic Violence Crisis Center (Conn.), \$25,200
 Domus Foundation (Conn.), \$80,000
 DonorsChoose, \$40,886
 The Door - A Center of Alternatives, \$60,000
 Dorot, \$40,480

DoubleTake Community Service Co. (Mass.), \$20,000
 Frederick Douglass Academy, \$43,100
 Frederick Douglass Creative Arts Center, \$27,000
 DOVA, \$93,150
 Dress for Success New York, \$50,000
 Drexel University (Pa.), \$30,000
 Drisha Institute for Jewish Education, \$23,000

E

E. Monte Motion, \$37,300
 Earthwatch Expeditions (Mass.), \$25,000
 East Harlem Tutorial Program, \$125,700
 East Williamsburg Valley Industrial Development Corporation, \$40,000
 East Woods School, \$17,000
 Ecology Center (Mich.), \$65,000
 Educational Alliance, \$30,900
 Educational Broadcasting Corporation, \$294,150
 Educational Priorities Panel, \$200,000
 EECO Farm, \$29,000
 Elizabeth Foundation for the Arts, \$100,000
 Endometriosis Association (Wis.), \$35,000
 Martha Entenmann Tinnitus Research Center (Vt.), \$100,000
 Environmental Advocates of New York, \$71,000
 Environmental Defense, \$114,150
 Environmental & Energy Study Institute (D.C.), \$75,000
 Environmental Health Coalition (Calif.), \$80,000
 Environmental Law & Policy Center (Ill.), \$75,000
 Environmental Media Services (D.C.), \$50,000
 Environmental Support Center (D.C.), \$75,000
 Environmental Working Group (D.C.), \$75,000
 Episcopal Diocese of Massachusetts, \$50,750
 Episcopal Social Services of New York, \$37,950
 Evidence, \$60,000
 Exodus Transitional Community, \$180,000

F

Fairfield County Community Foundation (Conn.), \$1,622,000
 Family Centers (Conn.), \$54,450
 Family & Children's Association, \$194,500
 Family Information & Referral Service Teams, \$117,266
 Family Service of Westchester, \$96,700
 Farms for City Kids Foundation, \$50,000
 Fedcap Rehabilitation Services, \$40,000
 Federated Conservationists of Westchester County, \$30,000
 Federation of Protestant Welfare Agencies, \$278,500
 Feminist Majority Foundation (Calif.), \$75,000
 Fessenden School (Mass.), \$100,000
 Samuel Field YM & YWHA, \$65,000
 Figure Skating in Harlem, \$50,000
 Firelands Community Hospital (Ohio), \$16,140
 First Congregational Church - Chatham (Mass.), \$18,470
 Five Towns Community Center, \$20,000
 Fletcher Allen Health Care (Vt.), \$24,000
 Flushing Council on Culture & the Arts, \$40,000
 FOCUS Alternative Learning Center (Conn.), \$25,000
 Folksbiene Yiddish Theatre, \$68,200
 Vincent J. Fontana Center for Child Protection, \$120,000
 Food Bank for New York City, \$19,300
 Fordham University, \$95,850
 Forest Hills Community House, \$100,000
 Ali Forney Center, \$60,000
 Fort Washington Houses Services for the Elderly, \$25,000
 Fortune Society, \$183,120
 47 Palmer Inc. (Mass.), \$50,000
 Foundation Center, \$20,000
 Foundation for Dance Promotion, \$161,550
 Foundation for the National Institutes of Health (Md.), \$20,000
 Foundry Theatre, \$60,000
 Fountain House, \$145,360
 Franklin & Marshall College (Pa.), \$25,600

Franklin Medical Center (Mass.), \$16,470
 Franklin Square Hospital Center (Md.), \$204,000
 Freedom from Hunger Foundation (Calif.), \$500,300
 Freer Gallery of Art of the Smithsonian Institution (D.C.), \$41,560
 Fresh Air Fund, \$60,450
 Friends & Relatives of Institutionalized Aged, \$40,000
 Friends of the American Cathedral in Paris, \$25,000
 Friends of Gateway, \$33,000
 Friends of the High Line, \$35,000
 Friends of Hudson River Park, \$31,000
 Friends of the Israel Defense Forces, \$30,600
 Friends of Yemin Orde (D.C.), \$19,600
 FSH Society (Mass.), \$50,000
 Fund for the City of New York, \$27,050
 Fund for Modern Courts, \$25,255
 Fund for Public Health in New York, \$350,000
 Fund for Public Advocacy, \$46,000
 Fund for Public Schools, \$120,000
 Fund for Social Change, \$234,000
 Funders' Network for Smart Growth & Livable Communities (Fla.), \$100,000
 Futures & Options, \$80,000

G

Gay Men of African Descent, \$25,000
 Gay Men's Health Crisis, \$175,600
 Georgetown University (D.C.), \$252,928
 Georgia State University Foundation, \$26,000
 Gerontological Society of America (D.C.), \$30,000
 Getting the Word Out, \$50,000
 Girl Scout Council of Greater New York, \$51,900
 Girl Scouts of the United States of America (N.J.), \$49,530
 Girls Incorporated of New York City, \$50,000
 Girls' Vacation Fund, \$21,000
 Glimmerglass Opera, \$47,250
 Global Kids, \$68,650
 Gloria Wise Boys & Girls Club, \$60,000
 GLSEN, \$41,500
 Goddard-Riverside Community Center, \$22,600
 God's Love We Deliver, \$96,000
 Good Jobs First (D.C.), \$55,000
 Good Shepherd Services, \$116,000
 Gordon School (R.I.), \$100,000
 Governor Dummer Academy (Mass.), \$50,000
 Grace Church of Brooklyn Heights, \$34,500
 Grace Church Community Center, \$20,000
 Grace Episcopal Church of Sandusky (Ohio), \$16,140
 Martha Graham Center of Contemporary Dance, \$61,500
 Graham-Windham Services to Families & Children, \$76,000
 Grameen Foundation USA (D.C.), \$62,000
 Grand Street Settlement, \$43,200
 Grandfather Home for Children, (N.C.), \$85,260
 Grant Foundation (Pa.), \$52,500
 Greater Jamaica Development Corporation, \$45,000
 Greater Newark Conservancy (N.J.), \$75,000
 Greater Twin Cities United Way (Minn.), \$22,000
 Greater Washington Educational Television Association-WETA (Va.), \$22,500
 Green Guerillas, \$25,800
 Greenwich Hospital Association (Conn.), \$27,720
 Greyston Foundation, \$50,000
 Groton School (Mass.), \$51,965
 Groundwork Yonkers, \$46,000
 Group for the South Fork, \$39,200
 Grymes Memorial School (Va.), \$50,000
 Guidance Center, \$53,500
 Guild Hall of East Hampton, \$58,950

H

H. T. Dance Company, \$75,000
 Habitat for Humanity International (Ga.), \$31,905

Habitat for Humanity New York City, \$23,600
 Hadassah, \$25,230
 Halcyon Foundation, \$20,000
 Hamilton College, \$87,200
 Hamilton-Madison House, \$25,500
 Harlem Children's Zone, \$20,400
 Harlem United Community AIDS Center, \$35,000
 Hartley House, \$23,450
 President & Fellows of Harvard College (Mass.), \$2,575,275
 Harvard University Medical School (Mass.), \$100,000
 Corporation of Haverford College (Pa.), \$17,500
 Health Care Choices, \$51,000
 Health Care Without Harm (D.C.), \$100,000
 Health Research, \$73,000
 Health & Welfare Council of Long Island, \$170,100
 HealthCare Chaplaincy, \$43,600
 Healthcare Foundation for Falmouth Hospital (Mass.), \$16,140
 Hebron Academy (Maine), \$51,000
 Heifer Project International (Ark.), \$204,200
 Hempstead Boys & Girls Club, \$60,000
 Henry Street Settlement, \$84,250
 HIAS, \$51,700
 Hibiscus Children's Center (Fla.), \$25,000
 Highbridge Community Life Center, \$627,273
 Hillel: Foundation for Jewish Campus Life (D.C.), \$49,716
 Hispanic Federation, \$75,000
 Historic Districts Council, \$50,500
 Historic House Trust of New York City, \$42,950
 Hobart & William Smith Colleges, \$18,000
 Holy Tabernacle Church of Our Lord Jesus Christ, \$50,000
 Home for Contemporary Theatre & Art, \$100,000
 Hope Program, \$40,550
 Hopkins Committee of Trustees (Conn.), \$46,000
 Horticultural Society of New York, \$46,700
 Hospice Care Network, \$27,500
 Hospital for Joint Diseases Orthopaedic Institute, \$58,000
 Hospital for Special Surgery, \$110,200
 Hotchkiss School (Conn.), \$45,000
 Housatonic Community College Foundation (Conn.), \$35,000
 House Foundation for the Arts, \$75,000
 Housing & Services, \$30,000
 Hudson Guild, \$80,100
 Hudsonia Limited, \$24,000
 Human Development Services of Westchester, \$66,750
 Human Rights Campaign (D.C.), \$56,000
 Human Rights First, \$120,350
 Human Rights Watch, \$228,525
 Hunter College Center on AIDS, Drugs & Community Health, \$97,000
 Hunter College of CUNY, \$120,000
 Hunter College of CUNY/Bellevue School of Nursing, \$414,390
 Hunter College Foundation, \$25,900

I

I Have a Dream Foundation, \$30,000
 I Have a Dream of Norwalk (Conn.), \$25,000
 IAA Education Program, \$56,000
 Identity House, \$60,000
 Independent Feature Project, \$25,000
 Independent Press Association (Calif.), \$30,000
 Indian Mountain School (Conn.), \$27,200
 inMotion, \$100,350
 Inner-City Scholarship Fund, \$349,750
 Institute of Fine Arts Foundation, \$26,000
 Institute of International Education, \$38,890
 Institute for Labor & the Community, \$25,500
 Institute for Local Self-Reliance (D.C.), \$75,000
 Institute for the Puerto Rican/Hispanic Elderly, \$40,000
 Institute for Student Achievement, \$1,610,000
 Institute on Taxation & Economic Policy (D.C.), \$15,600
 Instituto Colombiano De Medicina Tropical, \$23,000

Interfaith Committee of Remembrance, \$20,300
 Interfaith Council for Affordable Residence, \$20,000
 Interfaith Nutrition Network, \$50,000
 International Center of Photography, \$50,000
 International Council for Local Environmental Initiatives, USA, (Calif.), \$87,000
 International Crisis Group (D.C.), \$30,350
 International Institute of Vocal Arts, \$50,000
 International Rescue Committee, \$106,770
 International Social Service, United States of America Branch (Md.), \$73,940
 International Women's Health Coalition, \$16,250
 International Yacht Restoration School (R.I.), \$466,000
 International Youth Leadership Institute, \$35,000
 Intrepid Museum Foundation, \$15,100
 Iona College, \$35,500
 Irvington Institute for Immunological Research, \$29,575
 Irvington Presbyterian Church, \$35,000
 Izaak Walton League of America (Md.), \$25,000

J

Jamaica Service Program for Older Adults, \$35,000
 James Foundation (Mo.), \$975,000
 Jericho Project, \$59,000
 Jewish Board of Family & Children's Services, \$81,360
 Jewish Community Center of Staten Island, \$20,000
 Jewish Community Council of Greater Coney Island, \$40,300
 Jewish Guild for the Blind, \$52,400
 Jewish Museum, \$181,500
 Jewish National Fund, \$16,500
 Job Path, \$25,000
 Johns Hopkins Hospital (Md.), \$25,000
 Johns Hopkins University (Md.), \$275,000
 Johns Hopkins University School of Medicine (Md.), \$67,000
 Joyce Theater Foundation, \$509,308
 Juilliard School, \$43,600
 Junior League of Greenwich (Conn.), \$20,000
 Just Food, \$50,150

K

Kansas University Endowment Association, \$18,220
 Elaine Kaufman Cultural Center/Lucy Moses School for Music & Dance, \$18,750
 Keene Valley Library Association, \$15,300
 Keep Antibiotics Working: The Campaign to End Antibiotic Overuse (D.C.), \$75,000
 Helen Keller Services for the Blind, \$17,260
 Key West Film Society (Fla.), \$35,000
 Killeen Volunteers (Tex.), \$32,000
 Kipp, Inc., \$25,000
 Raymond F. Kravis Center for the Performing Arts (Fla.), \$19,500

L

La Jolla Music Society (Calif.), \$109,000
 La Mama Experimental Theatre Club, \$90,000
 Fiorello H. LaGuardia Community College of CUNY, \$20,000
 Latin American Integration Center, \$40,000
 LAWHELP/NY, \$50,000
 Sarah Lawrence College, \$67,350
 Lawrenceville School (N.J.), \$22,480
 Lawyers Alliance for New York, \$80,100
 Learning Center for Homeless Families (Minn.), \$23,000
 Learning Leaders, \$89,869
 Legal Action Center of the City of New York, \$40,000
 Legal Aid Society, \$437,370
 Legal Information for Families Today, \$40,000
 Legal Services for Children, \$50,100
 Legal Services for New York City, \$72,095
 Lenox Hill Hospital, \$43,650
 Lenox Hill Neighborhood House, \$59,500
 Lower East Side People's Federal Credit Union, \$40,000

Lesbian & Gay Community Services Center, \$46,500
 Liberty Center for Immigrants, \$20,000
 Liberty Hill Foundation (Calif.), \$400,000
 Library Association of La Jolla (Calif.), \$25,000
 LICF Erase Racism Project, \$267,560
 Lighthouse International, \$383,850
 Lincoln Center for the Performing Arts, \$153,100
 Lincoln Square Neighborhood Center, \$30,000
 Link Community School (N.J.), \$30,000
 Littig House Community Center, \$20,000
 Little Hill Foundation (N.J.), \$77,000
 Little Village School, \$25,000
 Local Initiatives Support Corporation, \$90,000
 Location One, \$100,000
 Long Beach Reach, \$45,000
 Long Island Campaign for Affordable Rental Housing, \$22,500
 Long Island Cares, \$170,600
 Long Island College Hospital, \$88,870
 Long Island Drinking Water Coalition, \$16,500
 Long Island Fund for Women & Girls, \$43,280
 Long Island Housing Services, \$20,000
 Long Island Philharmonic, \$47,500
 Long Island Pine Barrens Society, \$22,000
 Long Island Shares - The Environmental Network, \$30,000
 Long Island Sound Partners, \$250,000
 Long Island University, \$193,900
 Mary Louis Academy, \$300,000
 Lower East Side Girls Club of New York, \$40,000
 Lutheran Disaster Response of NY, \$60,000
 Lutheran Family Community Services, \$75,000

M

M.A. Center (Calif.), \$273,360
 Madison Avenue Presbyterian Church, \$16,260
 Maine Community Foundation, \$150,000
 Manhasset/Great Neck Economic Opportunity Council, \$180,000
 Manhattan Class Company, \$93,000
 Borough of Manhattan Community College of CUNY, \$52,670
 Manhattan Eye, Ear & Throat Hospital, \$47,820
 Manhattan Institute for Cancer Research, \$20,000
 Manhattan Institute for Policy Research, \$27,250
 Manhattan School of Music, \$63,000
 Manhattan Theatre Club, \$176,000
 Horace Mann School, \$24,300
 Mannes College of Music, \$19,625
 Marlboro School of Music (Pa.), \$50,000
 Massachusetts Institute of Technology, \$44,600
 Massachusetts Museum of Contemporary Art, \$85,000
 Massachusetts Society for Prevention of Cruelty to Animals, \$50,000
 Materials for the Arts Association, \$55,000
 Ronald McDonald House Charities of the Capital Region, \$25,000
 MCIF Center, \$35,000
 McLean Hospital Corporation (Mass.), \$30,000
 Medical Education for South African Blacks (N.J.), \$61,500
 Medical & Health Research Association of New York City, \$70,300
 Medicare Rights Center, \$60,200
 Medici Archive Project, \$30,000
 Meet the Composer, \$50,000
 MEM Associates, \$100,000
 Memorial Sloan-Kettering Cancer Center, \$210,650
 Mental Health Association of Westchester County, \$15,100
 Mental Health Providers of Western Queens, \$80,000
 Mentoring USA, \$59,000
 Mercy Home for Children, \$100,000
 Metropolitan Museum of Art, \$286,765
 Metropolitan Opera Association, \$396,925
 MFY Legal Services, \$60,250
 Mid-Bronx Senior Citizens Council, \$40,000
 Mid-Fairfield Child Guidance Center (Conn.), \$26,000
 Middle Country Library Foundation, \$50,000

Middle Country Public Library, \$25,000
 President & Fellows of Middlebury College (Vt.), \$92,400
 Midwood Development Corporation, \$40,000
 Milton Academy (Mass.), \$30,920
 Minneapolis Urban League (Minn.), \$65,000
 Miracle Corners of the World, \$25,200
 Mobility International USA (Oreg.), \$80,000
 Montclair Art Museum (N.J.), \$50,000
 Montclair Volunteer Ambulance Unit (N.J.), \$20,000
 Montefiore Medical Center, \$132,000
 Montreat College (N.C.), \$85,260
 Pierpont Morgan Library, \$190,000
 Morningside Retirement & Health Services, \$55,640
 Morris Public Library (Conn.), \$17,198
 Mosholu-Montefiore Community Center, \$50,000
 Mosholu Preservation Corporation, \$33,000
 Mothers on the Move, \$50,000
 Mount Holyoke College (Mass.), \$26,600
 Mount Sinai Hospital, \$15,500
 Mount Sinai Medical Center, \$312,040
 Mount Sinai School of Medicine of NYU, \$213,000
 Mountainside Hospital Foundation (N.J.), \$50,000
 Ms. Foundation for Women, \$25,000
 Multiple Sclerosis Resources of Central New York, \$30,000
 Municipal Art Society of New York, \$47,200
 Museum of the City of New York, \$26,600
 Museum of Fine Arts, Houston (Tex.), \$150,000
 Museum of Jewish Heritage/NY Holocaust Memorial Commission, \$25,000
 Museum of Modern Art, \$646,350
 Museum of Television & Radio, \$61,000
 Mutual Housing Association of Southwestern Connecticut, \$50,000
 Myrtle Avenue Commercial Revitalization & Development Project, \$40,000

N

NAACP Legal Defense & Educational Fund, \$17,600
 Nantucket Land Council (Mass.), \$125,000
 Nantucket Lighthouse School (Mass.), \$50,000
 Nassau County Coalition Against Domestic Violence, \$67,200
 Nassau County Museum of Art, \$60,200
 Nassau Land Trust, \$25,000
 National Academy of Design, \$22,000
 National Alliance for Research on Schizophrenia & Depression, \$21,000
 National Association for Public Interest Law (D.C.), \$16,000
 National Association of Women Judges (D.C.), \$15,055
 National Audubon Society, \$80,950
 National Center for Disability Services, \$30,000
 National Coalition for Haitian Rights, \$20,000
 National Council on Economic Education, \$19,080
 National Dance Institute, \$23,200
 National Environmental Trust (D.C.), \$50,000
 National Fish & Wildlife Foundation (D.C.), \$50,000
 National Forest Foundation (Mont.), \$50,000
 National Foundation for Facial Reconstruction, \$21,800
 National Foundation for Teaching Entrepreneurship to Handicapped & Disadvantaged Youth, \$20,100
 National Hansen's Disease Programs (La.), \$30,000
 National Korean American Service & Education Consortium, \$20,000
 National Mentoring Partnership (Va.), \$26,200
 National Multiple Sclerosis Society, \$132,030
 National Rowing Foundation (Conn.), \$25,000
 National Urban League, \$51,250
 National Wheelchair Sports Fund (Fla.), \$150,000
 National Wildlife Federation (Va.), \$105,450
 National Women's Law Center (D.C.), \$19,200
 Natural Resources Council of Maine, \$20,000
 Natural Resources Defense Council, \$47,800
 Nature Conservancy (Va.), \$21,482
 Nature Conservancy, Adirondack Chapter, \$16,000

Nature Conservancy, Eastern New York Chapter, \$24,000
 Nature Conservancy New York, Long Island Chapter, \$45,700
 Walter W. Naumburg Foundation, \$64,750
 Naumburg Orchestral Concerts, \$44,830
 Neighborhood Coalition for Shelter, \$56,950
 Neighborhood Economic Development Advocacy Project, \$50,000
 Neighbors Against Garbage, \$40,000
 Netherland-America Foundation, \$16,500
 New Alternatives for Children, \$71,850
 New Destiny Housing Corporation, \$50,000
 New Energy Foundation (N.H.), \$125,000
 New England Conservatory of Music (Mass.), \$25,000
 New England Home for Little Wanderers (Mass.), \$16,000
 New Federal Theater, \$75,250
 New 42nd Street, \$45,250
 New Haven Symphony Orchestra (Conn.), \$55,000
 New Partners for Community Revitalization, \$100,000
 New School University, \$581,000
 New Visions for Public Schools, \$478,130
 New York Academy of Medicine, \$222,500
 New York ACORN Housing Company, \$30,000
 New York Agency for Community Affairs, \$43,000
 New York AIDS Coalition, \$60,000
 New York Association for Gender Rights Advocacy, \$25,000
 New York Botanical Garden, \$2,391,900
 New York Cares, \$87,450
 New York City Affordable Housing Campaign, \$25,000
 New York City Ballet, \$513,450
 New York City Coalition Against Hunger, \$55,870
 New York City Employment & Training Coalition, \$100,000
 New York City Environmental Justice Alliance, \$25,000
 New York City Gay & Lesbian Anti-Violence Project, \$40,800
 New York City Medicaid Office Improvement Project, \$23,000
 New York City Mission Society, \$77,640
 New York City Opera, \$256,050
 New York City Outward Bound Center, \$30,500
 New York City Rescue Mission, \$37,200
 New York Cops Foundation, \$20,000
 New York Hall of Science, \$145,250
 New York Immigration Coalition, \$395,500
 New York Industrial Retention Network, \$35,000
 New York Landmarks Conservancy, \$144,500
 New York Legal Assistance Group, \$77,000
 New York Military Academy, \$20,000
 New York Open Center, \$22,500
 New York Police & Fire Widows' & Children's Benefit Fund, \$25,000
 New York-Presbyterian Hospital, \$410,660
 New York Public Interest Research Group Fund, \$135,350
 New York Public Library Astor Lenox & Tilden Foundations, \$362,225
 New York Regional Association of Grantmakers, \$15,550
 New York Service Program for Older People, \$25,000
 New York Shakespeare Festival, \$607,160
 New York Society for the Prevention of Cruelty to Children, \$43,450
 New York State Black Gay Network, \$20,000
 New York State Commission to Promote Public Confidence in Judicial Elections, \$50,000
 New York State Defenders Association, \$25,000
 New York Times Neediest Cases Fund, \$23,550
 New York University, \$146,625
 New York University, Graduate School of Arts & Sciences, \$81,580
 New York University, Institute for Education & Social Policy, \$100,000
 New York University, School of Continuing Education, \$20,000
 New York University, School of Law, \$56,600
 New York University School of Medicine, \$146,784
 New York University, Leonard N. Stern School of Business, \$17,500
 New York University, Robert F. Wagner Graduate School of Public Service, \$77,500
 New York Vietnam Veterans Memorial Fund, \$57,020
 New York Weill Cornell Medical Center Fund, \$2,534,150
 New York Women's Foundation, \$66,100

New Yorkers for Children, \$515,000
 New Yorkers for Parks, \$36,500
 Newark Museum Association (N.J.), \$100,200
 Nightingale-Bamford School, \$31,000
 92nd Street YM-YWHA, \$43,400
 Nonprofit Coordinating Committee of New York, \$60,350
 Nonprofit Finance Fund, \$85,500
 North American Friends-Israel Oceanographic & Limnological Research, \$41,000
 North Carolina State University, \$55,000
 North Country Reform Temple, \$20,000
 North Miami Museum & Art Center (Fla.), \$30,000
 North Shore Child & Family Guidance Association, \$170,400
 North Shore Holiday House, \$26,200
 North Shore-Long Island Jewish Health System Foundation, \$224,000
 Northeastern University (Mass.), \$24,400
 Northern Manhattan Improvement Corporation, \$90,000
 Northern Palm Beach County Youth Foundation (Fla.), \$25,000
 Northern York County Family YMCA (Maine), \$25,000
 Northside Center for Child Development, \$89,200
 Northwest Bronx Community & Clergy Coalition, \$200,000
 Norwalk Community College Foundation (Conn.), \$25,500
 NOW Legal Defense & Education Fund, \$52,150
 NPower New York, \$55,000
 Nursing Home Community Coalition of New York State, \$50,000
 NYSARC, Westchester Chapter, \$26,180
 NYU Downtown Hospital, \$107,500

O

Oakland Volunteer Fire Department (N.J.), \$75,000
 OBT (Conn.), \$40,000
 Occidental College (Calif.), \$75,000
 Oceana (D.C.), \$25,000
 Oceanics School, \$25,000
 Ohio University Foundation, \$25,000
 Old Dartmouth Historical Society/New Bedford Whaling Museum (Mass.), \$25,000
 Old Vic Theatre Trust 2000, \$50,000
 Albert G. Oliver Program, \$42,500
 Oregon Health & Science University, \$17,249
 Orthopaedic Scientific Research Foundation, \$100,000
 Osborne Association, \$17,600
 Ossining Open Door Associates, \$60,650
 Our Lady Star of the Sea, \$19,000
 Overlook Hospital Foundation (N.J.), \$91,150
 Oxfam America (Mass.), \$92,290

P

Pace University, School of Law, \$109,500
 Packer Collegiate Institute, \$61,845
 Parent-Child Home Program, \$55,000
 Park Square Advocates (Mass.), \$51,000
 Parodneck Foundation for Self-Help Housing & Community Development, \$51,250
 Parsons School of Design, \$48,000
 Partners in Health (Mass.), \$35,000
 Partnership for After School Education, \$83,000
 Partnership for the Homeless, \$61,200
 Pathfinder International (Mass.), \$25,000
 Pearl Theatre Company, \$61,300
 Peconic Baykeeper, \$27,000
 Peconic Community Council, \$24,500
 Peconic Land Trust, \$16,960
 PEN American Center, \$16,300
 Pencil, Inc., \$40,000
 Pennington School (N.J.), \$25,000
 Pennsylvania State University, \$52,025
 People of Color in Crisis, \$25,000
 People for the American Way Foundation (D.C.), \$65,810
 Person-to-Person (Conn.), \$20,000

Philharmonic-Symphony Society of New York, \$65,100
 Trustees of Phillips Academy (Mass.), \$28,250
 Phillips Exeter Academy (N.H.), \$29,880
 Phipps Community Development Corporation, \$16,750
 Phoenix House Foundation, \$114,000
 Physicians for Social Responsibility (D.C.), \$72,250
 Pick-Up Performance Company, \$45,000
 Pig Iron Theatre Company (Pa.), \$30,000
 Pine Creek Valley Watershed Association (Pa.), \$250,000
 Pine Point School (Conn.), \$50,000
 PJCJC Fund, \$250,000
 Planned Parenthood Federation of America, \$23,705
 Planned Parenthood Hudson Peconic, \$36,055
 Planned Parenthood of Nassau County Foundation, \$80,000
 Planned Parenthood of New York City, \$479,905
 Planned Parenthood of Rhode Island, \$65,000
 Playing to Win, \$250,000
 PMI/Strang Cancer Prevention Center, \$18,500
 Poets House, \$30,600
 Police Athletic League, \$31,375
 Polytechnic Preparatory Country Day School, \$99,500
 Pont-Aven School of Art (Mass.), \$20,250
 Port Chester Carver Center, \$41,500
 Positive Health Project, \$50,000
 Posse Foundation, \$51,000
 Pratt Area Community Council, \$40,000
 Prep for Prep, \$31,850
 Presbyterian Church (U.S.A.) Foundation (Ind.), \$90,830
 Presbytery of New York City, \$31,320
 Price Tower Arts Center (Okla.), \$150,000
 Primary Care Development Corporation, \$100,000
 Princeton University (N.J.), \$50,050
 Project Enterprise, \$20,000
 Project Reach Youth, \$90,550
 Project Renewal, \$111,250
 Pronto of Long Island, \$25,000
 Public Citizen Foundation (D.C.), \$27,120
 Public Health Research Institute of the City of New York (N.J.), \$78,000
 Public Policy & Education Fund of New York, \$45,000
 Public/Private Ventures (Pa.), \$50,000
 Purchase College Foundation, \$59,000
 Putnam Hospital Center, \$43,290
 Putney School (Vt.), \$29,250

Q

Queens College (N.C.), \$85,260
 Queens College of CUNY, \$52,000
 Queens College Foundation, \$39,300
 Quinnipiac University (Conn.), \$15,924

R

Rails-to-Trails Conservancy (D.C.), \$15,100
 Rainforest Alliance, \$26,000
 Ramapo Anchorage Camp, \$15,650
 Recording for the Blind & Dyslexic (N.J.), \$65,000
 Red Barn Theatre (Fla.), \$25,000
 Redefining Progress (Calif.), \$25,000
 Regional Emergency Medical Services Council of New York City, \$60,000
 Regional Plan Association, \$30,000
 Rensselaerville Institute, \$33,000
 Replications, \$50,000
 Research Foundation of SUNY, \$30,000
 Restore America's Estuaries (Va.), \$25,000
 Rhode Island Children's Crusade for Higher Education, \$20,000
 Rhode Island Community Food Bank, \$100,000
 Rhode Island Historical Society, \$50,000
 Rhode Island Philharmonic Orchestra, \$20,000
 Rhodes College (Tenn.), \$85,260
 Ridgewood Bushwick Senior Citizens Council, \$46,000

Jacob A. Riis Neighborhood Settlement, \$40,000
 Pascal Rioult Dance Theatre, \$61,000
 River Network (Oreg.), \$50,000
 Riverdale Presbyterian Church, \$25,000
 Riverdale-Yonkers Society for Ethical Culture, \$16,000
 Riverkeeper, \$74,250
 Riverside Park Fund, \$20,350
 Riverview Foundation (N.J.), \$25,000
 Trustees of Robert College of Istanbul, NY, \$15,200
 Robin Hood Foundation, \$135,400
 Rockaway Development & Revitalization Corporation, \$40,000
 Rocky Mountain Energy Campaign (Colo.), \$60,000
 Franklin & Eleanor Roosevelt Institute, \$543,000
 Roundabout Theatre Company, \$27,200
 Row New York, \$58,250
 Roza Promotions, \$20,000
 Rural Advancement Foundation International-USA (N.C.), \$15,020
 Russian Children Welfare Society, \$75,000
 Rutgers, The State University of New Jersey, \$25,500
 Rutgers University Foundation (N.J.), \$19,250
 Ryan Foundation for MPS Children (Tex.), \$20,000

S

Safe Horizon, \$59,800
 St. Andrew's Memorial Church, \$25,000
 St. Andrew's Presbyterian College (N.C.), \$85,260
 St. Barnabas Development Foundation (N.J.), \$20,350
 St. Barnabas Hospital, \$30,000
 St. Bernard's School, \$32,300
 St. Christopher's, \$95,550
 St. Christopher's Inn, \$51,000
 St. Dominic's Home, \$65,000
 St. Edward's Church (Fla.), \$28,000
 St. John's Academy (N.J.), \$16,000
 St. John's Bread & Life Program, \$35,000
 St. John's University, \$27,700
 St. Joseph Hill Academy, \$20,000
 St. Joseph's Center of Scranton (Pa.), \$20,000
 St. Jude Children's Research Hospital-ALSAC (Tenn.), \$86,910
 St. Luke's Chamber Ensemble, \$45,000
 St. Luke's Roosevelt Hospital Center, \$61,630
 St. Mark's Historic Landmark Fund, \$30,000
 St. Mary's Foundation for Children, \$923,477
 St. Peter's Church of Bay Shore, \$60,000
 St. Theresa's Church (Conn.), \$25,000
 St. Thomas Choir School, \$20,000
 St. Vincent Catholic Medical Centers of New York, \$181,250
 Salvation Army of Greater New York, \$174,781
 Salvation Army, New Jersey Division, \$32,000
 San Antonio Youth Literacy (Tex.), \$25,000
 Save the Children Federation (Conn.), \$18,180
 Scenic Hudson, \$158,450
 Solomon Schechter School of Westchester, \$85,000
 Scholarship & Welfare Fund of the Alumni Association of Hunter College, \$20,310
 School of American Ballet, \$71,500
 School for Field Studies (Mass.), \$20,000
 Schuyler Foundation for Career Bridges, \$18,000
 Agnes Scott College (Ga.), \$160,000
 Sea Research Foundation (Conn.), \$85,000
 Seamen's Church Institute of New York & New Jersey, \$52,000
 SEEDCO, \$120,667
 Seeds of Peace, \$38,100
 Selfhelp Community Services, \$27,600
 Senior Action in a Gay Environment, \$35,000
 Senior Care & Activities Center (N.J.), \$90,000
 SER of Westchester, \$95,000
 Serbian Orthodox Cathedral of St. Sava, \$25,000
 Sesame Workshop, \$60,500
 SHARE New York, \$40,000
 Shared Interest, \$32,250

Shelter & Food for the Homeless, \$37,000
 Shelter Island Presbyterian Church, \$18,830
 Sheltering Arms Children's Service, \$30,250
 Shinnecock Indian Nation Fund, \$52,500
 Shriners Hospitals for Children (Fla.), \$25,000
 Sierra Club Foundation (Calif.), \$16,000
 Lois & Samuel Silberman Fund, \$75,792
 Silver Bay Association for Christian Conferences & Training, \$30,000
 Sister Power Organization, \$37,000
 Sisters of Charity of Saint Elizabeth (N.J.), \$205,400
 Skidmore College, \$25,450
 Trustees of the Smith College (Mass.), \$279,600
 Smith Park of New York, \$30,000
 Smithsonian Institution (D.C.), \$87,450
 Smithtown Historical Society, \$24,250
 Society of Friends of Touro Synagogue (R.I.), \$52,000
 Society of St. Johnland, \$43,500
 Soho Repertory Theatre, \$45,000
 South Asian Youth Action, \$80,000
 South Bronx Educational Foundation, \$25,500
 South Street Seaport Museum, \$78,930
 Southampton Fresh Air Home, \$25,250
 Southampton Hospital Foundation, \$17,250
 Southern Catholic (Ga.), \$150,000
 Southern New York Association, \$20,000
 Southern Poverty Law Center (Ala.), \$19,488
 Southern Queens Park Association, \$59,000
 Special Olympics International (D.C.), \$100,100
 Spence School, \$117,600
 Spring Creek Community Corporation, \$30,000
 Stages of Learning, \$20,750
 Stanford University (Calif.), \$73,000
 Star Kids Scholarship Program (R.I.), \$20,000
 Steppingstone Foundation (Mass.), \$271,000
 Stevens Institute of Technology (N.J.), \$16,500
 Stony Brook Foundation, \$165,500
 StreetSquash, \$15,694
 Student/Sponsor Partnership, \$42,000
 Studio in a School Association, \$43,500
 Summer Search Foundation (Calif.), \$91,500
 Sunnyside Community Services, \$66,000
 SUNY College at Purchase, \$20,520
 Supportive Housing Network of New York, \$60,000
 Sustainable Long Island, \$208,950
 Sustainable South Bronx, \$40,000
 Swarthmore College (Pa.), \$54,514
 Symphony Space, \$45,850

T

Take the Field, \$105,000
 Target Margin Theater, \$35,000
 Teach for America, \$313,000
 Teachers College, Columbia University, \$1,823,300
 Teaching Matters, \$52,500
 Teatown Lake Reservation, \$30,500
 Temple Beth El, \$250,000
 Temple Sinai (N.J.), \$26,000
 Thalia Spanish Theatre, \$75,000
 That Man May See (Calif.), \$90,000
 Thin Man Dance, \$30,000
 Threshold Dance Project, \$45,500
 Tides Center (Calif.), \$154,500
 Tifereth Israel Rabbinical Yeshiva, \$50,000
 Tilghman Heritage Foundation (Ky.), \$20,000
 Town Hill School (Conn.), \$22,620
 Town School, \$25,000
 Townsend Harris Alumni Association, \$16,100
 Travelers Aid Society of Rhode Island, \$150,000
 Trey Whitfield School, \$71,500
 Trickle Up Program, \$32,650

Trinitas Health Foundation (N.J.), \$19,000
 Trinity Church (Conn.), \$50,000
 Trinity College (Conn.), \$82,500
 Tri-State Transportation Campaign, \$26,500
 Trust for Public Land, \$524,150
 Amos Tuck School (N.H.), \$33,750
 Trustees of Tufts College (Mass.), \$115,700
 Turning Point Housing Development Fund Corporation, \$50,000

U

UJA/Federation of Jewish Philanthropies of New York, \$1,089,112
 Unified New Cassel Community Revitalization Corporation, \$32,500
 Trustees of Union College, \$40,750
 Union Theological Seminary, \$31,000
 United Cerebral Palsy of New York City, \$20,000
 United Hospital Fund, \$114,650
 United Jewish Appeal of MetroWest (N.J.), \$31,000
 United Nations Association of the United States of America, \$72,000
 United Negro College Fund (Va.), \$79,658
 United Neighborhood Houses of New York, \$81,250
 United States Fund for UNICEF, \$30,010
 United Way of Long Island, \$25,370
 United Way of New York City, \$193,840
 United Way of Tri-State, \$122,500
 United Way of Westchester & Putnam, \$34,922
 Regents of the University of California, \$83,000
 University of Chicago (Ill.), \$18,200
 University of Colorado Foundation, \$408,334
 University of Delaware, \$22,250
 University of Georgia, \$20,800
 University of Illinois at Urbana-Champaign, \$155,500
 University Neighborhood Housing Program, \$40,000
 University of New Mexico Foundation, \$20,000
 University of North Carolina at Chapel Hill, \$119,600
 Trustees of the University of Pennsylvania, \$228,350
 University of Pennsylvania, Wharton Business School, \$25,000
 University of Scranton (Pa.), \$20,000
 University Settlement Society of New York, \$48,200
 University of the State of New York Regents Research Fund, \$150,000
 University of Toronto (Canada), \$100,000
 University of Vermont, \$40,650
 University of Washington, \$130,735
 Urban Assembly, \$27,000
 Urban Justice Center, \$101,726
 U.S. Committee for United Nations Population Fund, \$35,300
 U.S. Public Interest Research Group Education Fund (D.C.), \$75,000
 USA Cycling Development Foundation (Colo.), \$77,500
 USO of Metropolitan New York, \$22,800

V

The Valley, \$125,500
 Vassar Brothers Hospital Foundation, \$50,000
 Vassar College, \$64,950
 Vassar-Warner Home, \$35,000
 Vera Institute of Justice, \$54,600
 Vietnam Veterans of America Foundation (D.C.), \$28,500
 Villanova University (Pa.), \$22,000
 VISIONS Services for the Blind & Visually Impaired, \$50,000
 Visiting Nurse Association of Long Island, \$25,000
 Visiting Nurse Service of New York, \$26,735
 Vocational Instruction Project Community Services, \$40,000
 Volunteers of Legal Service, \$22,700
 Vote Solar Initiative (Calif.), \$50,000

W

Wall Street Rising Corp, \$100,000
 Walsh Park Benevolent Corporation, \$18,000
 Warren Wilson College (N.C.), \$85,260
 Washington University (Mo.), \$15,750

Watchtower Bible & Tract Society of New York, \$1,000,000
 Watershed Agricultural Council of the New York City Watersheds, \$100,000
 Wave Hill, \$39,000
 Samuel Waxman Cancer Research Foundation, \$525,000
 Wellesley College (Mass.), \$21,800
 Wesleyan University (Conn.), \$121,500
 West Brighton Community Local Development Corporation, \$40,000
 West Harlem Environmental Action, \$40,200
 West Virginia University Foundation, \$25,000
 Westchester Community College Foundation, \$38,050
 Westchester Jewish Community Services, \$43,650
 Westchester Land Trust, \$75,635
 Westchester Philharmonic, \$17,050
 Western Justice Center Foundation (Calif.), \$50,000
 Weston Playhouse Theatre Company (Vt.), \$25,000
 WGBH Educational Foundation (Mass.), \$200,125
 White Mountain School (N.H.), \$100,000
 White Plains Hospital Center, \$61,280
 Whitney Museum of American Art, \$70,300
 Simon Wiesenthal Center (Calif.), \$54,300
 Wilderness Society (D.C.), \$26,050
 Wildlife Conservation Society, \$400,700
 Williams College (Mass.), \$51,175
 Wisconsin Project on Nuclear Arms Control (D.C.), \$60,000
 WNYC Foundation, \$51,300
 Women in Need, \$56,950
 WomenMatter (Pa.), \$200,000
 Women's Funding Network (Calif.), \$50,000
 Women's Housing & Economic Development Corporation, \$48,000
 Women's Leadership Fund, \$50,000
 Women's Prison Association & Home, \$105,130
 Women's Research & Education Institute (D.C.), \$25,000
 Woodberry Crossing (Md.), \$20,000
 Woodstock Guild of Craftsmen, \$20,800
 Workplace Project, \$50,250
 Workshop in Business Opportunities, \$20,000
 World Aid (Wash.), \$21,000
 World Golf Foundation (Fla.), \$100,000
 World Learning (Vt.), \$332,350
 World Monuments Fund, \$31,450
 World Union for Progressive Judaism, \$30,000
 World Vision (Wash.), \$20,800
 World Wildlife Fund (D.C.), \$16,850

Y

Yale University (Conn.), \$403,003
 YMCA of Central & Northern Westchester, \$29,630
 YMCA of Greater New York, \$353,401
 YMCA of Long Island, \$112,500
 Yorkville Common Pantry, \$66,800
 Yosemite National Institutes (Calif.), \$16,750
 Young Playwrights, \$32,000
 Young Survival Coalition, \$50,000
 Youth Experience in Sport, \$37,500
 YWCA of Brooklyn, \$140,611
 YWCA of the City of New York, \$56,600
 YWCA of White Plains & Central Westchester, \$65,000

Grants under \$15,001 \$ 10,699,762

Total Grants \$ 117,991,766

C R E D I T S

The photographs on pages 4, 5, and 33 were taken by Sean Sime.
Cover image used with permission of Richard S. Hayden, Swanke
Hayden Connell Architects

Page

2	Row New York <i>Photo: Michael B. Smith</i>
6	Campaign for Fiscal Equity <i>Photo: Jessica Garcia</i>
9	Brooklyn Bridge Park Coalition Mosholu Preservation Corporation
10	Friends of Gateway <i>Photo: Dave Lutz</i>
11	NY Acorn Housing Company <i>Photo: Tara Benigno</i>
12	Medical & Health Research Association of New York City <i>Photo: Jill LeVine</i>
15	The Center for Arts Education <i>Photo: Phil Mansfield</i> Alliance of Resident Theatres/New York <i>Photo: Nathalie Cortes</i> Doctors of the World—U.S.A. <i>Photo: Jonathan Hubschman</i> Columbia University Mailman School of Public Health <i>Photo: Judith Ramirez</i> Greater Jamaica Development Corporation <i>Photo: Peter Engelbrecht</i> The Door—A Center of Alternatives <i>Photo: Catherine Tsuji</i>
16	The New York Academy of Medicine <i>Photo: Gardith Marcelin</i> Job Path <i>Photo: Hagar Yanay</i>
18	The Actors' Fund of America <i>Photo: Jim Brown</i>
19	Dance Theater Workshop <i>Photo: Ed Rawlings</i>
20	Queens College of the City University of New York
21	Brooklyn Legal Services Corporation B <i>Photo: Susan Loeb</i>
22	Federation of Protestant Welfare Agencies <i>Photo: Kimberleigh Smith</i>
30	Children of Bellevue <i>Photo: Nancy Linn</i>
35	East End Community Organic Farm
37	Westchester Conservatory of Music <i>Photo: Lynda Curtis</i>
40	United Hospital Fund <i>Photo: Robert Glick</i>
Inside back cover:	American Red Cross in Greater New York <i>Photo: Taunya Turpeau</i>

Writer/Editor

Ani F. Hurwitz

Design

Van Gennep Design

Printing

Rasco Printing

A copy of our latest annual report filed with the New York
Secretary of State may be obtained upon request addressed to:

The New York Community Trust/Community Funds, Inc.

2 Park Avenue, New York, NY 10016-9385

or

Office of the Attorney General Charities Bureau

120 Broadway, New York, NY 10271



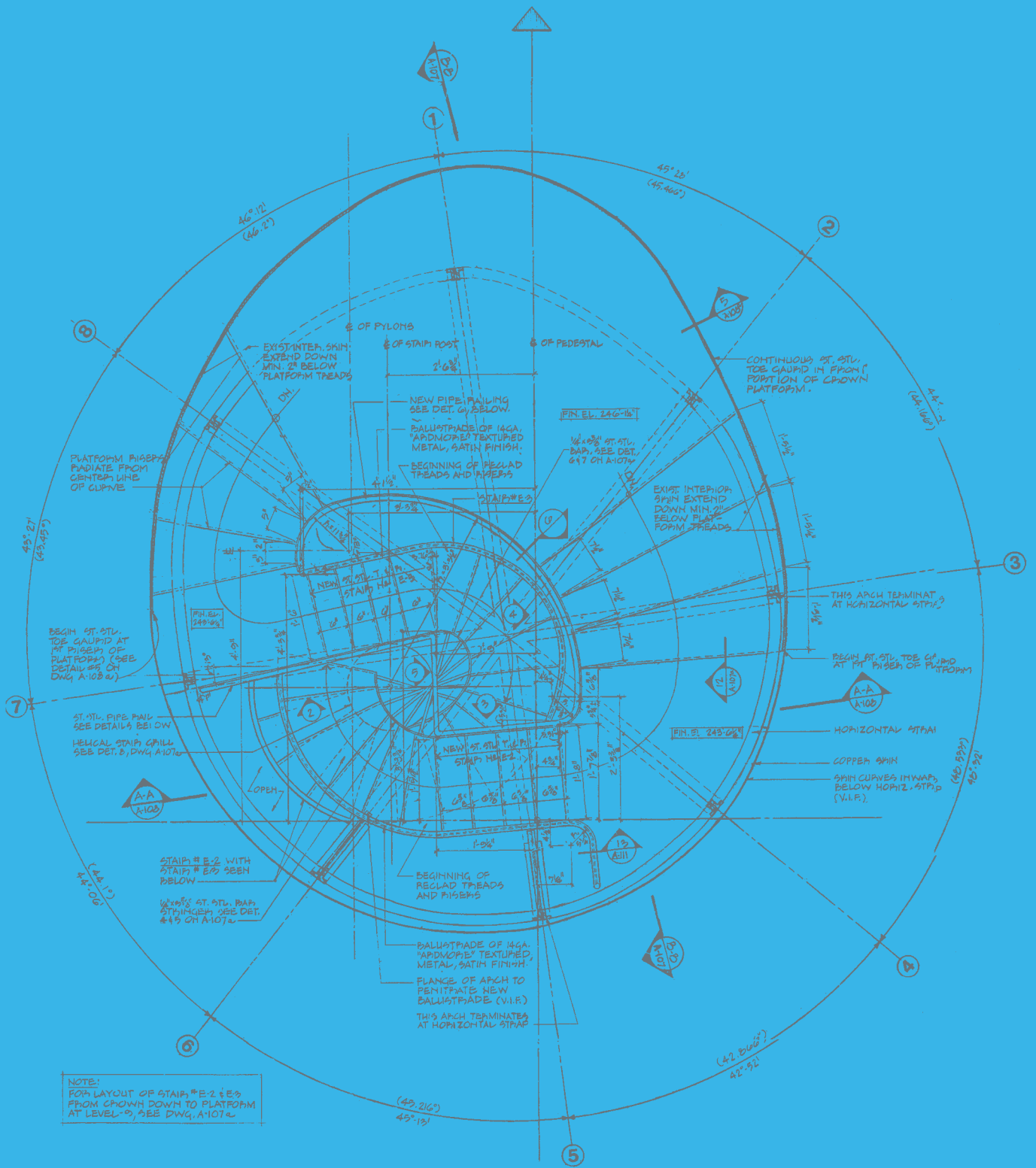

The New York Community Trust
 Two Park Avenue
 New York, NY 10016
 (212) 686-0010
www.nycommunitytrust.org

Long Island Community Foundation
 Elias Hicks House
 1740 Old Jericho Turnpike
 Jericho, NY 11753
 (516) 681-5085
www.licf.org

Westchester Community Foundation
 470 Mamaroneck Avenue, Suite 304
 White Plains, NY 10605
 (914) 948-5166
www.wcfcharity.org